

**FOR  
LEASE**

## Seattle South Business Park, Bldg 3

18200 - 18260 Segale Park Dr B | Seattle, WA



### 108,885 Square Feet Available

- Suite 18200: 69,660 SF total with 5,300 SF first floor office and 10,303 SF second floor office
- Suite 18260: 39,225 SF total with 2,756 SF first floor office and 7,464 SF second floor office
- 27' clear height
- 17 dock-high doors / 9 dock levelers
- 1 grade-level door
- 2,000 amps 277/480V
- Quick and easy access to Interstate 5, Interstate 405, and SR-167
- 10 minutes to Sea-Tac Airport
- Only minutes to Southcenter retail

# Seattle South Business Park, Building 3

18340 Segale Park Dr B | Seattle, WA

## 1st Floor Plan

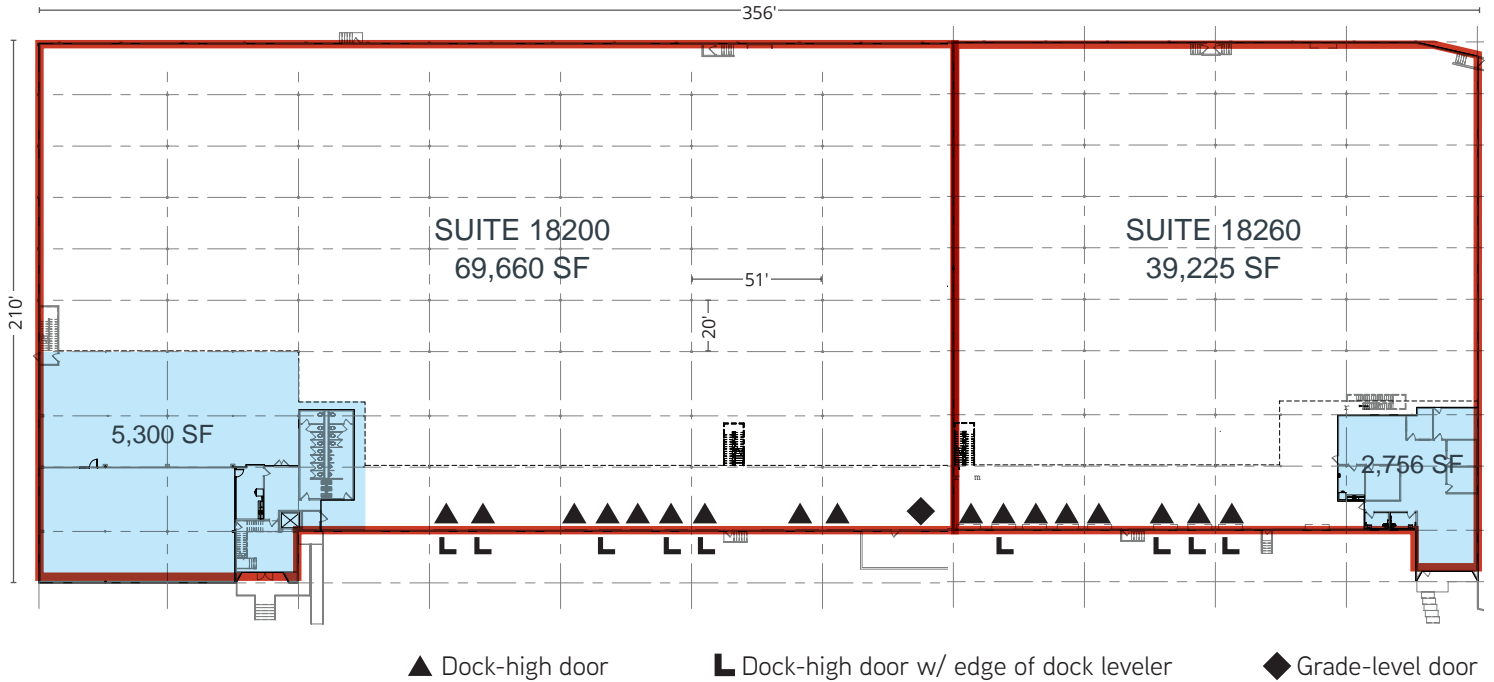

## Suite 18200 2nd Floor Office and Mezz.

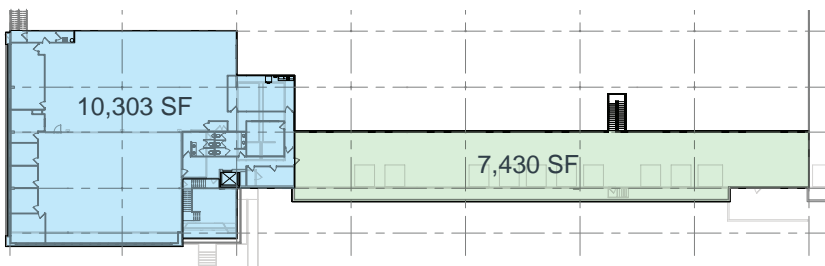

## Suite 18260 2nd Floor Mezz.

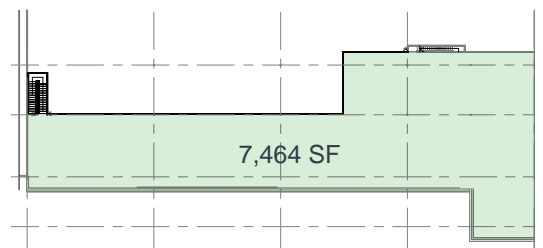

For more information on this opportunity, please contact



**Matt McGregor, SIOR**  
+1 206 624 7401  
matt.mcgregor@colliers.com

**Bill Condon, SIOR**  
+1 206 235 9732  
bill.condon@colliers.com

This information contained herein was obtained from sources deemed reliable and is believed to be true. It has not been verified and as such, cannot be warranted nor form any part of any future contract.