



**FOR
LEASE**

Seattle South Business Park, Bldg 6

18323 Andover Park W | Tukwila, WA



55,445 Square Feet Available

- 2,653 SF first floor office
- 2,624 SF second floor office
- 7 dock-high doors
- 2 grade-level doors
- 24' clear height
- Stand-alone building
- Quick and easy access to I-5, I-405 and SR 167, only 10 minutes to Sea-Tac Airport
- Only minutes to Southcenter retail

Seattle South Business Park, Building 6

18323 Andover Park W | Tukwila, WA

1st Floor Plan

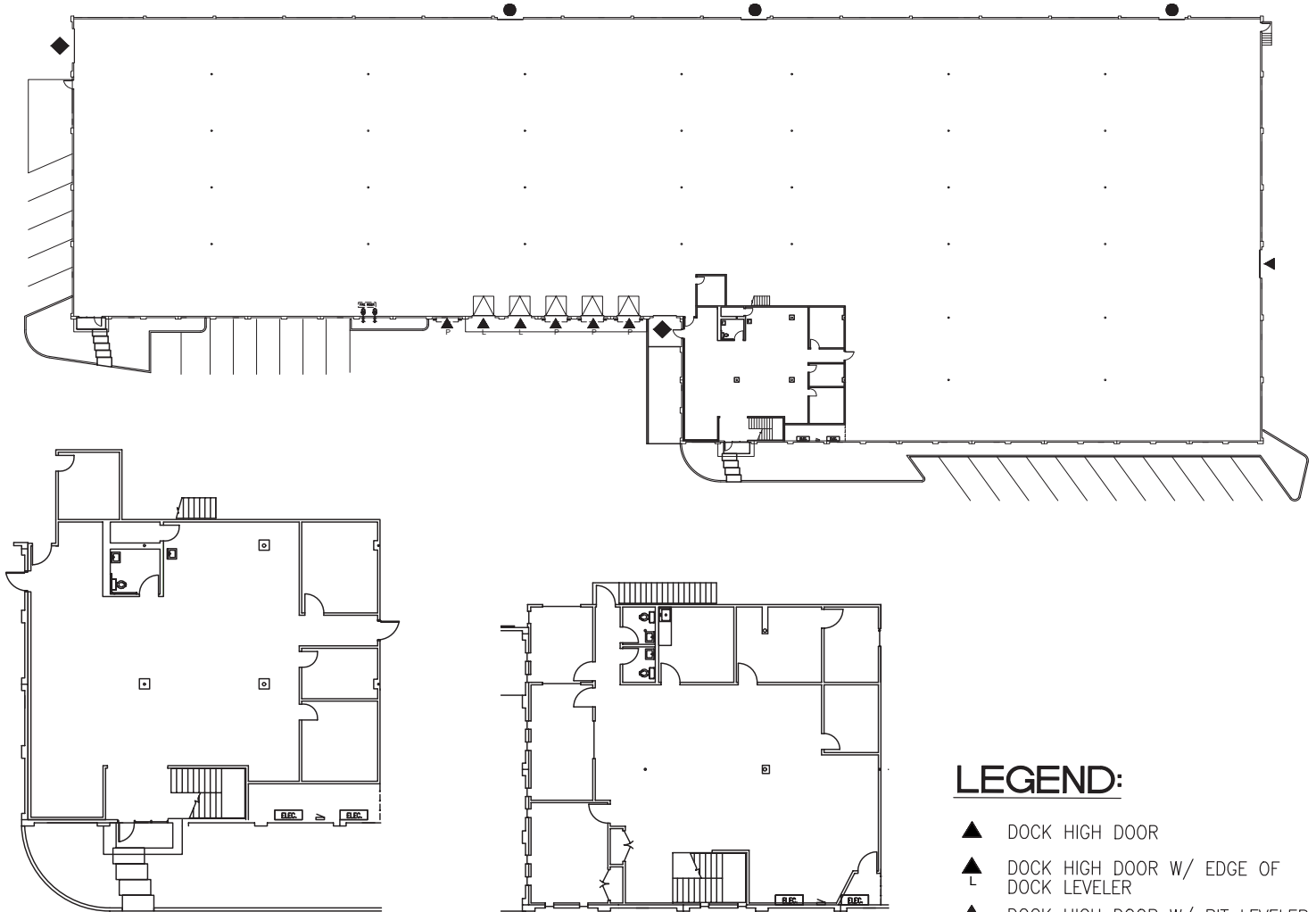

1st Floor Office

2nd Floor Office



For more information on this opportunity, please contact



Matt McGregor, SIOR
+1 206 624 7401
matt.mcgregor@colliers.com

Bill Condon, SIOR
+1 206 235 9732
bill.condon@colliers.com

This information contained herein was obtained from sources deemed reliable and is believed to be true. It has not been verified and as such, cannot be warranted nor form any part of any future contract.