



# SUMNER PROMENADE

6621 166TH AVENUE E  
SUMNER, WA 98390

PACIFIC ASSET ADVISORS, INC.

## LISTING DETAILS



RENTABLE SF  
**1,197 SF**

**CALL  
FOR  
RATE**

ADDRESS: 6621 166th Avenue E  
Sumner, WA 98390

CENTER SQUARE  
FOOTAGE: 5,909 SF

SPACE AVAILABLE: 102

MAJOR TENANTS: WinCo, Gravity Coffee,  
Society, a Salon...

	1 MILE	3 MILES	5 MILES
MEDIAN INCOME:	\$88,118	\$112,705	\$112,655
TOTAL POPULATION:	4,171	49,463	139,653
DAYTIME POPULATION:	2,139	28,987	79,477

425.990.6200 | PAADVISORS.COM



# SITE PLAN

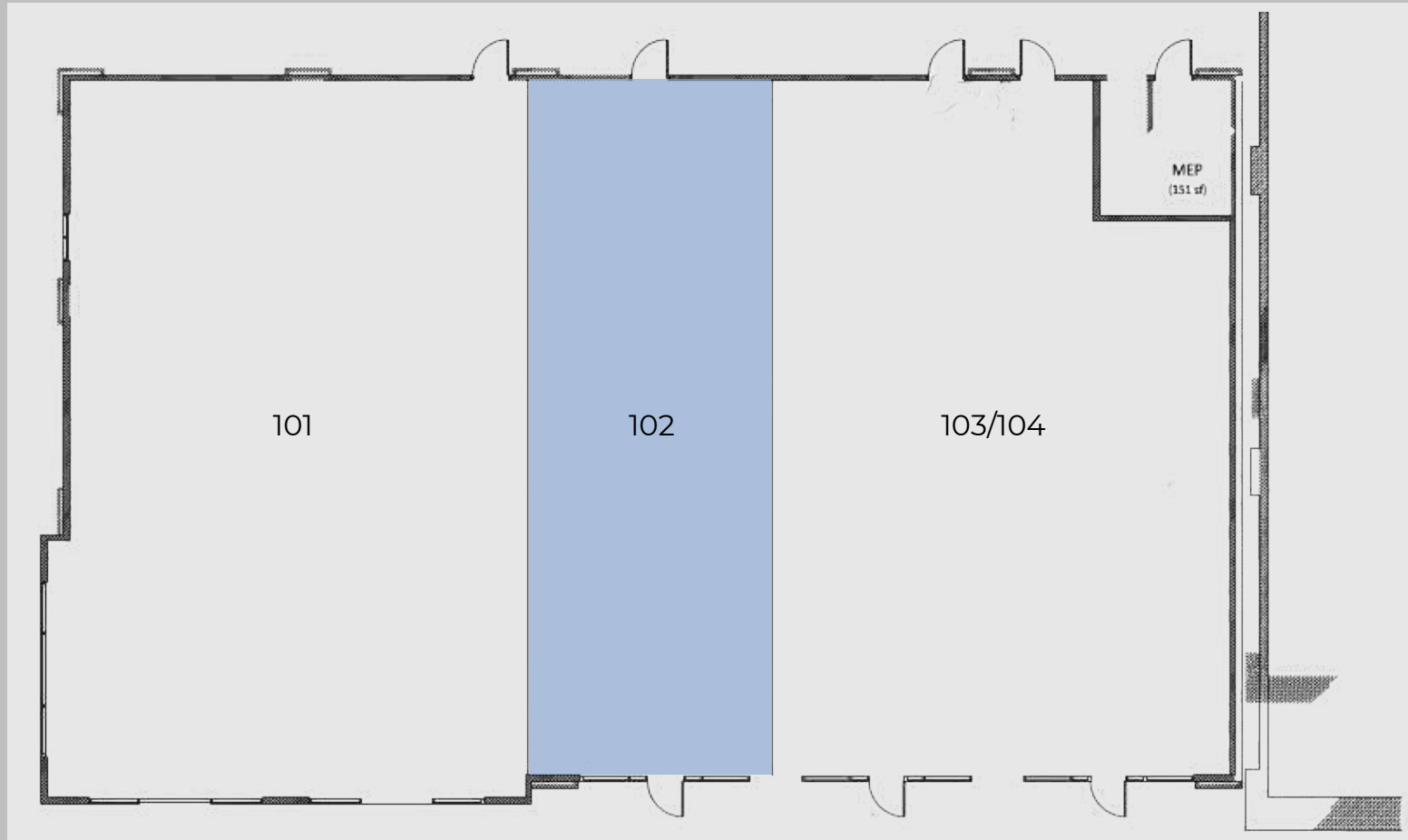

SUITE	TENANT	SQ FT
101	Gravity Coffee	2,470
102	AVAILABLE	1,197
103/104	Society, a Salon	2,242



AERIAL

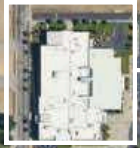

# CONTACT



**SYDNEY GASPARICH**  
SENIOR ASSOCIATE BROKER  
425.326.3742  
SYDNEY@PAADVISORS.COM



**ANDREW CLARKE**  
VICE PRESIDENT  
425.300.6082  
ANDREW@PAADVISORS.COM

**PACIFIC ASSET ADVISORS, INC.**  
THE PREMIER CHOICE OF THE PACIFIC NORTHWEST

14205 SE 36TH ST, SUITE 215, BELLEVUE, WA 98006