

TOTEM VALLEY

BUSINESS CENTER

12805 NE 125th Way | Kirkland, WA 98034



Northwest Building^{LLC}

NEWLY RENOVATED BUILDINGS & LANDSCAPING



BUILDING FEATURES



EXCELLENT ACCESS



GRADE-LEVEL LOADING



13' CLEAR HEIGHT



AMENITIES NEARBY



ABUNDANT PARKING



For more information or to schedule a tour, please contact:

CONNOR GILCHRIST
425.274.4286
gilchrist@broderickgroup.com

JEFF LIVINGSTON
425.274.4288
livingston@broderickgroup.com

RAWLEY HOLMBERG
425.274.4284
holmberg@broderickgroup.com

The information contained herein has been given to us by the owner or sources which we deem reliable. We have no reason to doubt its accuracy, but we do not guarantee it. Prospective tenants should carefully verify all information contained herein.

TOTEM VALLEY BUSINESS CENTER

12805 NE 125th Way | Kirkland, WA 98034

AREA AMENITIES



- | | | |
|--------------------------------|--|--|
| 1 QFC | 11 Fred Meyer | 21 Rite Aid |
| 2 Five Guys | 12 EvergreenHealth Medical Center | 22 LA Fitness |
| 3 Courtyard by Marriott | 13 Key Bank | 23 Northwest Cellars |
| 4 Papa Murphy's | 14 The Village at Totem Lake | 24 Totem Square Shopping Center |
| 5 Olive Garden | 15 Chipotle | 25 Subway |
| 6 Starbucks | 16 MOD Pizza | 26 7-Eleven |
| 7 Azteca | 17 Wells Fargo | 27 Teriyaki Plus |
| 8 Wendy's | 18 Bank of America | 28 Shari's |
| 9 Lowe's | 19 Chick-fil-A | 29 Gold's Gym |
| 10 Jimmy John's | 20 Comfort Inn | |

For more information or to schedule a tour, please contact:



CONNOR GILCHRIST
425.274.4286
gilchrist@broderickgroup.com

JEFF LIVINGSTON
425.274.4288
livingston@broderickgroup.com

RAWLEY HOLMBERG
425.274.4284
holmberg@broderickgroup.com

The information contained herein has been given to us by the owner or sources which we deem reliable. We have no reason to doubt its accuracy, but we do not guarantee it. Prospective tenants should carefully verify all information contained herein.

TOTEM VALLEY

BUSINESS CENTER

12805 NE 125th Way | Kirkland, WA 98034

AVAILABILITY

BUILDING / SUITE	AVAILABLE SPACE	OFFICE SF	WHSE SF	AVAILABLE DATE	MONTHLY BASE RENT
<u>A/12805</u>	4,473 RSF	1,562 RSF	2,911 RSF	NOW	Inquire with broker

The information contained herein has been given to us by the owner or sources that we deem reliable. We have no reason to doubt its accuracy, but we do not guarantee it. Prospective tenants should carefully verify all information contained herein.

SITE MAP



For more information or to schedule a tour, please contact:

CONNOR GILCHRIST
425.274.4286
gilchrist@broderickgroup.com

JEFF LIVINGSTON
425.274.4288
livingston@broderickgroup.com

RAWLEY HOLMBERG
425.274.4284
holmberg@broderickgroup.com

The information contained herein has been given to us by the owner or sources which we deem reliable. We have no reason to doubt its accuracy, but we do not guarantee it. Prospective tenants should carefully verify all information contained herein.



CURRENT SPACE PLAN

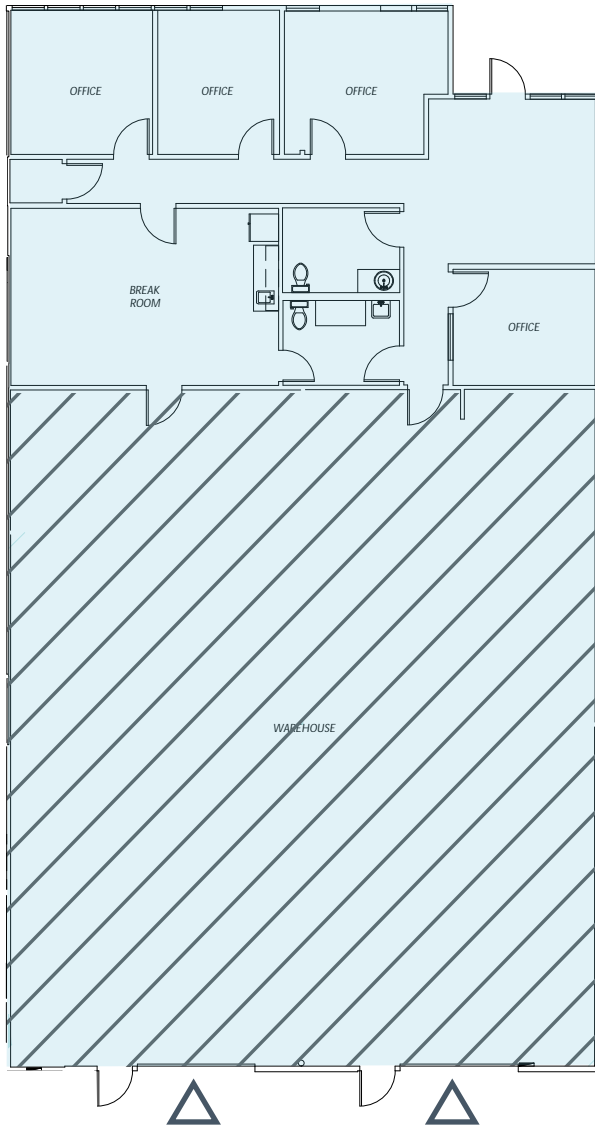

SUITE A12805

TOTAL: 4,473 RSF
WHSE: 2,911 RSF
OFFICE: 1,562 RSF

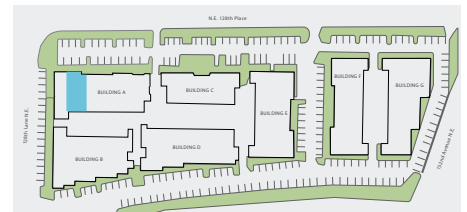

WAREHOUSE



GRADE LEVEL DOOR



↑ **BACK TO AVAILABILITY**



For more information or to schedule a tour, please contact:

CONNOR GILCHRIST
425.274.4286
gilchrist@broderickgroup.com

JEFF LIVINGSTON
425.274.4288
livingston@broderickgroup.com

RAWLEY HOLMBERG
425.274.4284
holmberg@broderickgroup.com