

REDMOOR INDUSTRIAL CENTER BUILDING E

Rare 5,800 SF industrial/automotive
building for sale in the heart of Marymoor

18080 NE 68TH ST, REDMOND, WA 98052

 **Kidder
Mathews**

REDMOOR INDUSTRIAL CENTER - BUILDING E

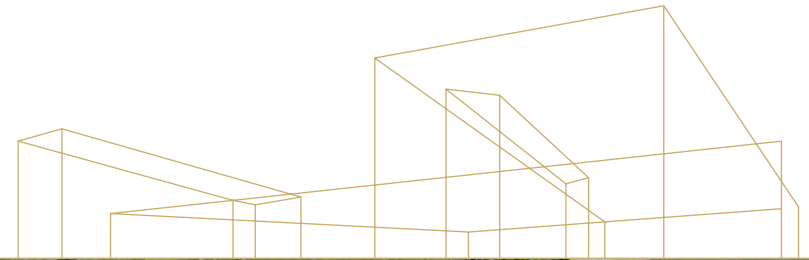

Property Overview

BUILDING FEATURES

Sales price \$3,950,000

5,800 SF total building size

Built in 1990

Fully sprinklered

Roof is 5 years old

18' clear height

1 dock-high door, 3 grade-level doors

3-phase, 240 volt, 200 amps of power

MP zoning, City of Redmond

LOCATION OVERVIEW

Located minutes from downtown Redmond

Immediate access to SR-520 and SR-202

Situated near future Redmond light rail station (opening 2024)

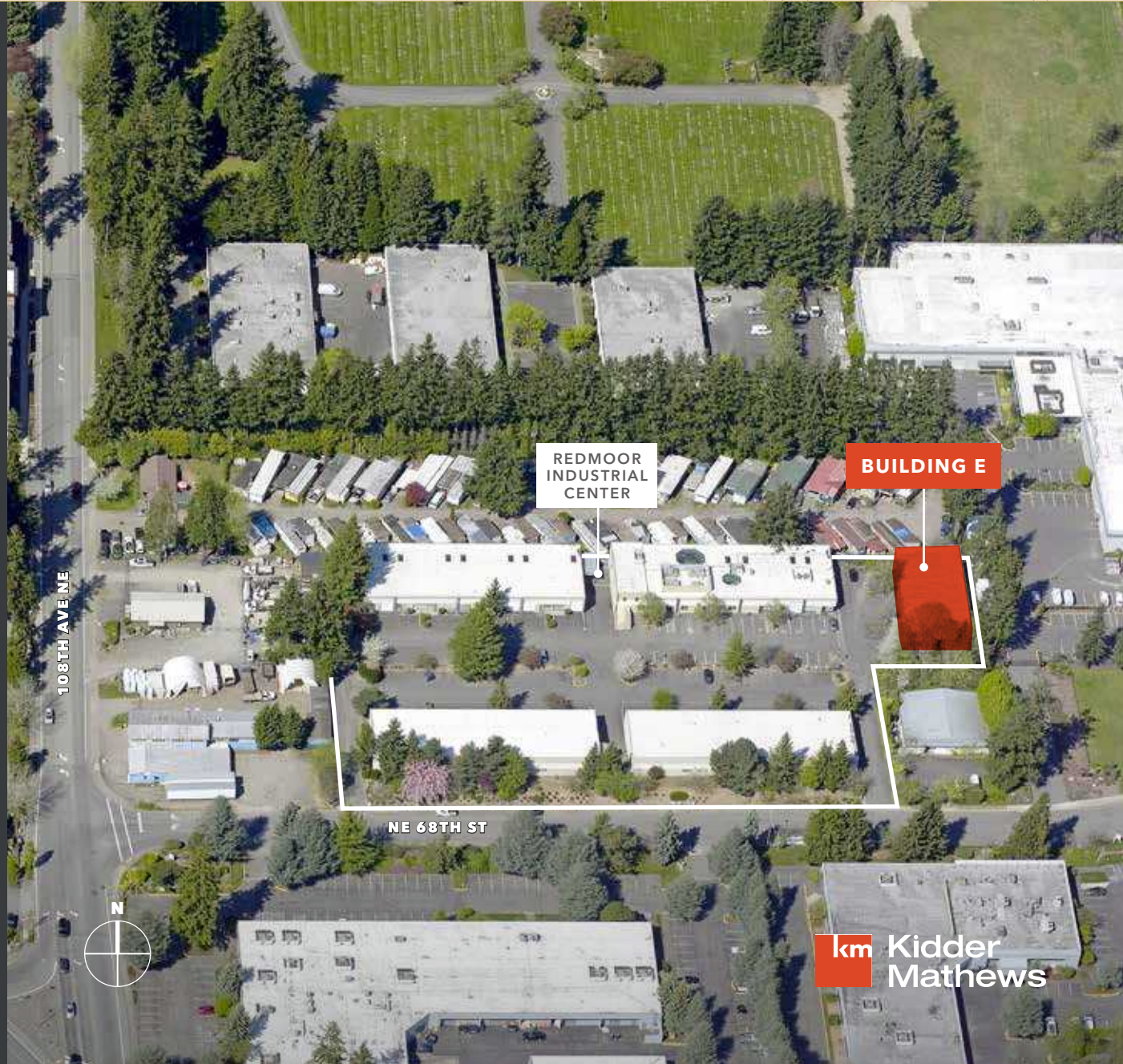

REDMOOR INDUSTRIAL CENTER - BUILDING E

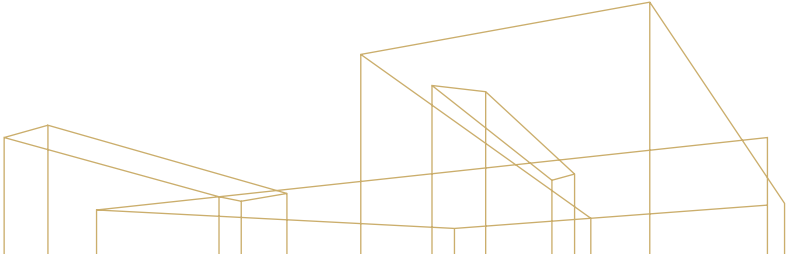

- ▲ GRADE-LEVEL LOADING
- △ DOCK-HIGH LOADING

BUILDING E

5,800
SQUARE FEET

18'
CLEAR HEIGHT

MP
ZONING

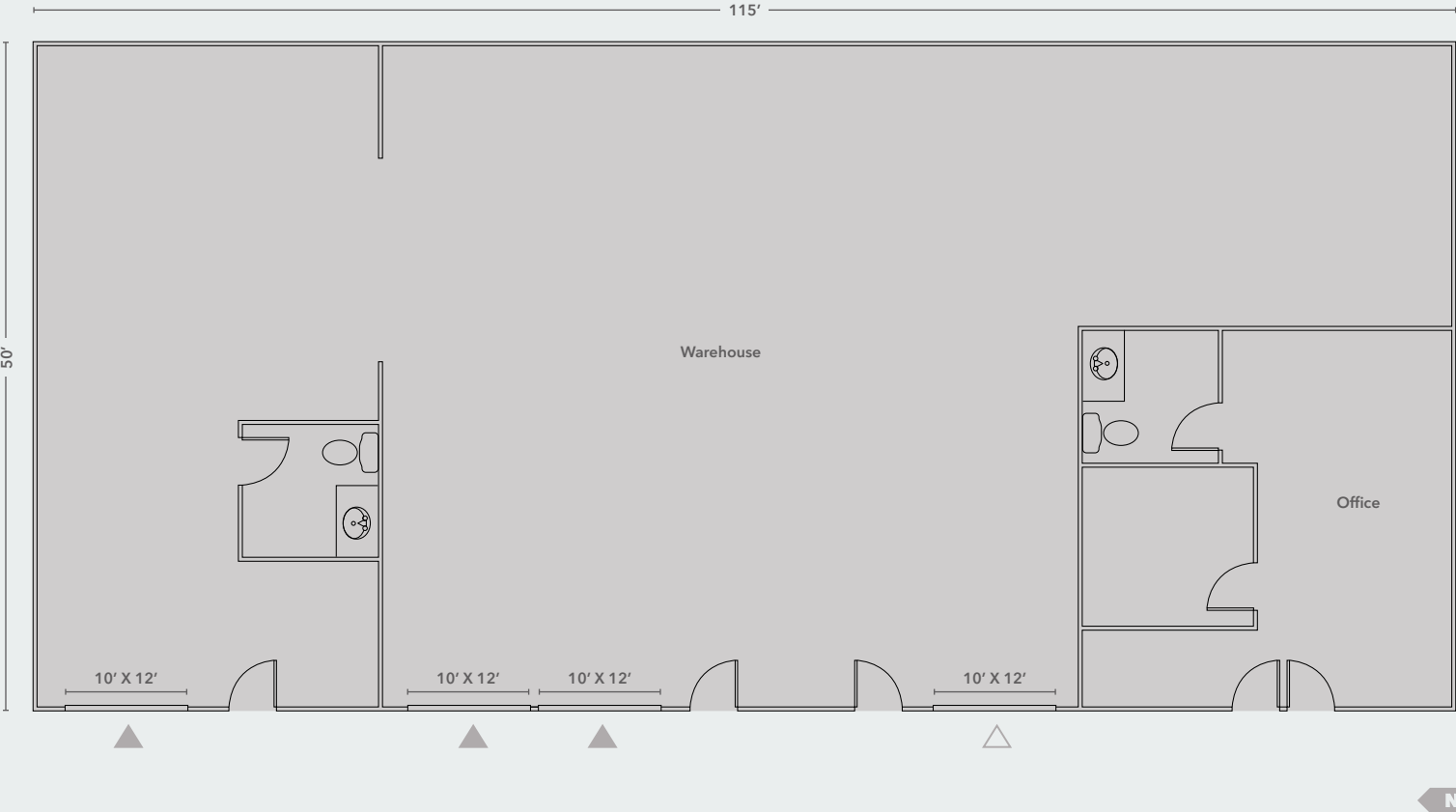

This information supplied herein is from sources we deem reliable. It is provided without any representation, warranty, or guarantee, expressed or implied as to its accuracy. Prospective Buyer or Tenant should conduct an independent investigation and verification of all matters deemed to be material, including, but not limited to, statements of income and expenses. Consult your attorney, accountant, or other professional advisor.

REDMOOR INDUSTRIAL CENTER - BUILDING E

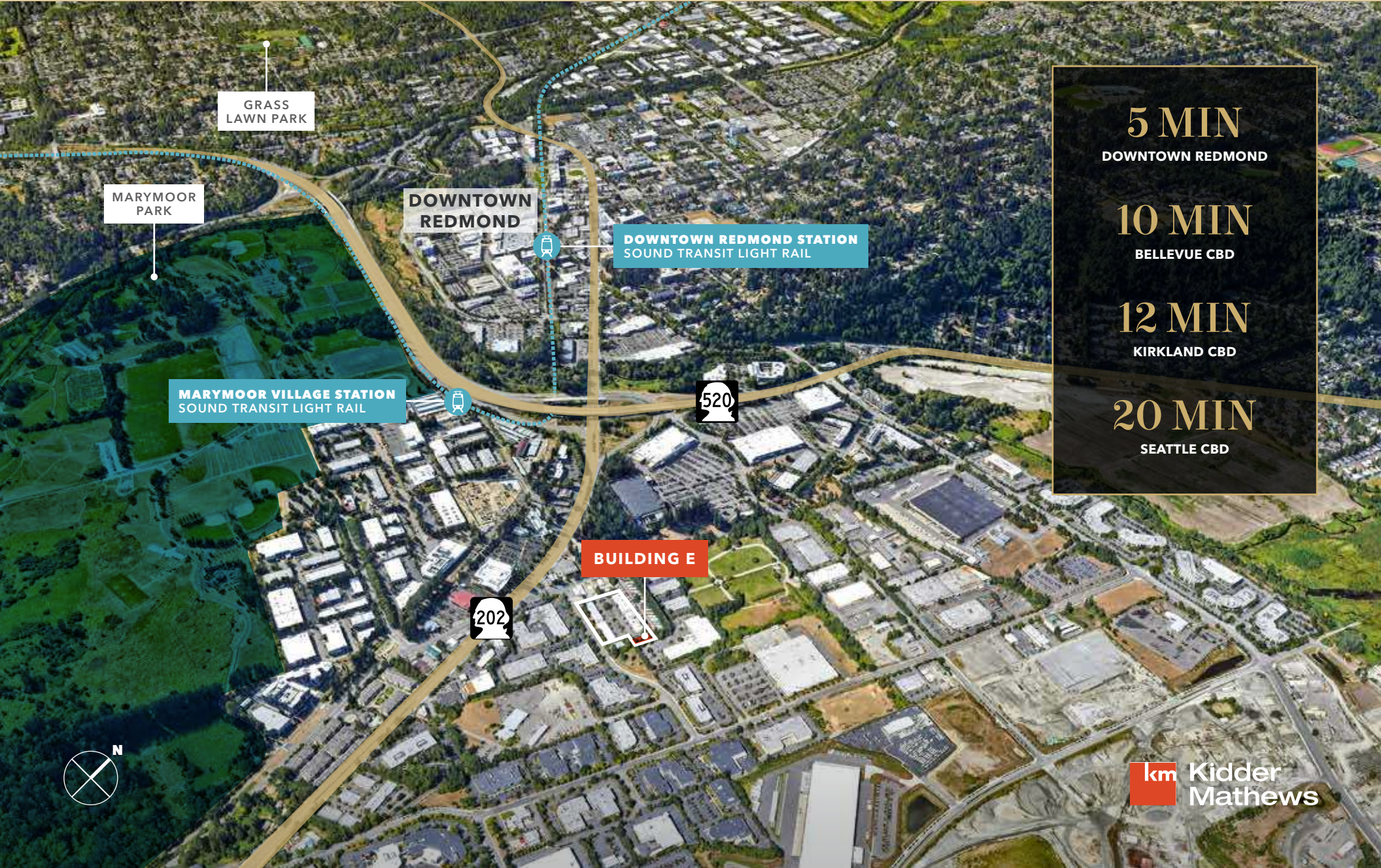
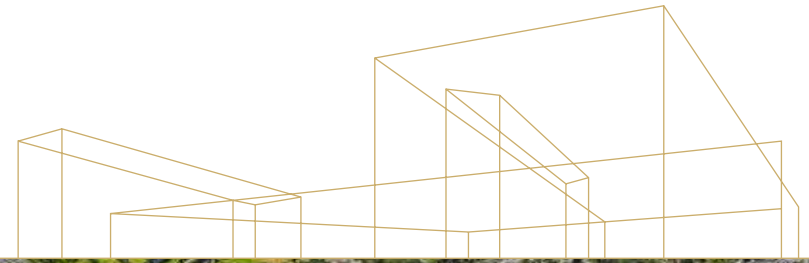

GRASS
LAWN PARK

MARYMOOR
PARK

DOWNTOWN
REDMOND

DOWNTOWN REDMOND STATION
SOUND TRANSIT LIGHT RAIL

MARYMOOR VILLAGE STATION
SOUND TRANSIT LIGHT RAIL

520

202

BUILDING E

5 MIN
DOWNTOWN REDMOND

10 MIN
BELLEVUE CBD

12 MIN
KIRKLAND CBD

20 MIN
SEATTLE CBD





For more information, contact

JASON BLOOM

425.450.1102

jason.bloom@kidder.com

TODD GAUTHIER

425.450.1118

todd.gauthier@kidder.com

KIDDER.COM

This information supplied herein is from sources we deem reliable. It is provided without any representation, warranty, or guarantee, expressed or implied as to its accuracy. Prospective Buyer or Tenant should conduct an independent investigation and verification of all matters deemed to be material, including, but not limited to, statements of income and expenses. Consult your attorney, accountant, or other professional advisor.