



WCCR

West Coast Commercial Realty

2720 4th Avenue | Seattle, WA 98121



Find your passion, find your verve. This modern and spacious retail space is available in the shadow of Seattle's iconic space needle. Enjoy being nestled in the heart of the city's rich musical history and culture, just steps away from the best concerts and festivals. Hugging the cusp of Queen Anne and Belltown, this storefront features expansive windows, manicured sidewalks, and contemporary finishes. Perfect for flower shop, beauty, medical, real-estate.



**1,221 SF**

Prime retail space available at the ground floor level of the Verve Apartments.

# FLOOR PLAN

**1,221 SF  
AVAILABLE**

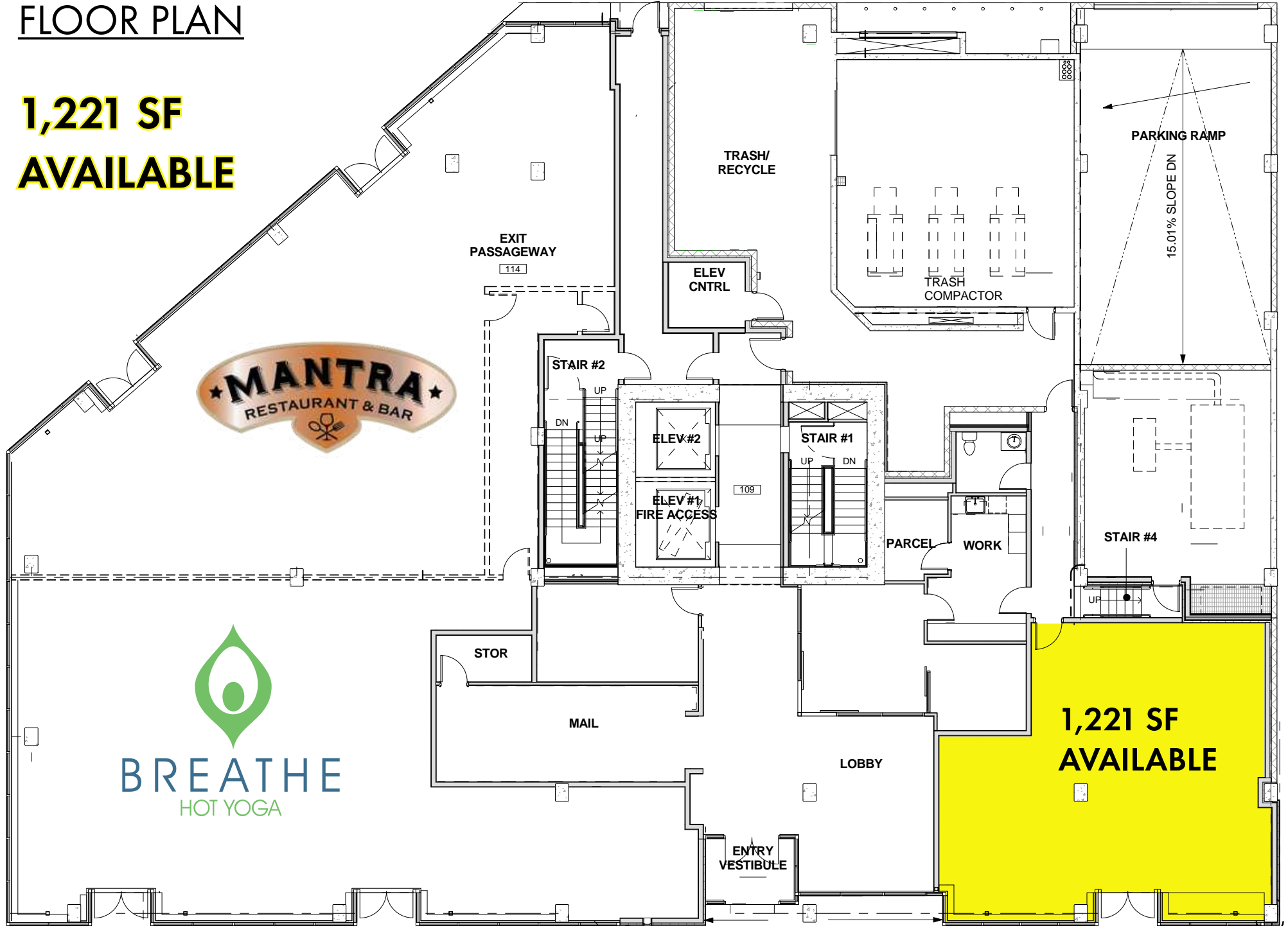





# DEMOGRAPHICS

## TOTAL POPULATION

1-Mile: 67,385  
3-Mile: 259,113  
5-Mile: 488,091

## MEDIAN HOUSEHOLD INCOME

1-Mile: \$115,334  
3-Mile: \$115,334  
5-Mile: \$112,231

## HOUSEHOLDS

1-Mile: 43,502  
3-Mile: 138,046  
5-Mile: 237,251





2720 4th Avenue | Seattle, WA 98121

**WCCR**

West Coast Commercial Realty

## LEASING INFORMATION

**Tiffini Connell**

tiffini@wccommercialrealty.com

**Jennifer Israel**

jenniferi@wccommercialrealty.com

**(206) 283-5212**

[www.wccommercialrealty.com](http://www.wccommercialrealty.com)

DISCLAIMER: The above information has been secured from sources believed to be reliable, however, no representations are made to its accuracy. Prospective tenants or buyers should consult their professional advisors and conduct their own independent investigation. Site plan and configuration are subject to change. Properties are subject to change in price and/or availability without notice. West Coast Commercial Realty, LLC