

FOR LEASE

SOUTHCENTER
PLAZA

14900 Interurban Ave S
Tukwila, WA

SUITES AVAILABLE

Suite 100	1,647 RSF
Suite 136	1,828 RSF
Suite 175	1,119 RSF

HIGHLIGHTS

- Beautiful landscaping offers a park-like setting
- Serene Views of Green River and Fort Dent Park
- Ideal for bike commuters/riders, near the Green River Trail and Lake to Sound Trail
- Ample free parking surrounding the building provides convenient access via the 3 main building entries
- Convenient Metro bus access on main arterial linking Seattle to the South King County (Route 150)
- Tenants can utilize a City of Seattle address
- **Rental Rate:** \$26.50 per RSF per Year, Fully Serviced



For more information:

Mike George
+1 425 586 5618
mgeorge@nai-psp.com

Tony Rona
+1 425 586 5634
trona@nai-psp.com

CURRENT AVAILABLE SUITES ON 1ST FLOOR

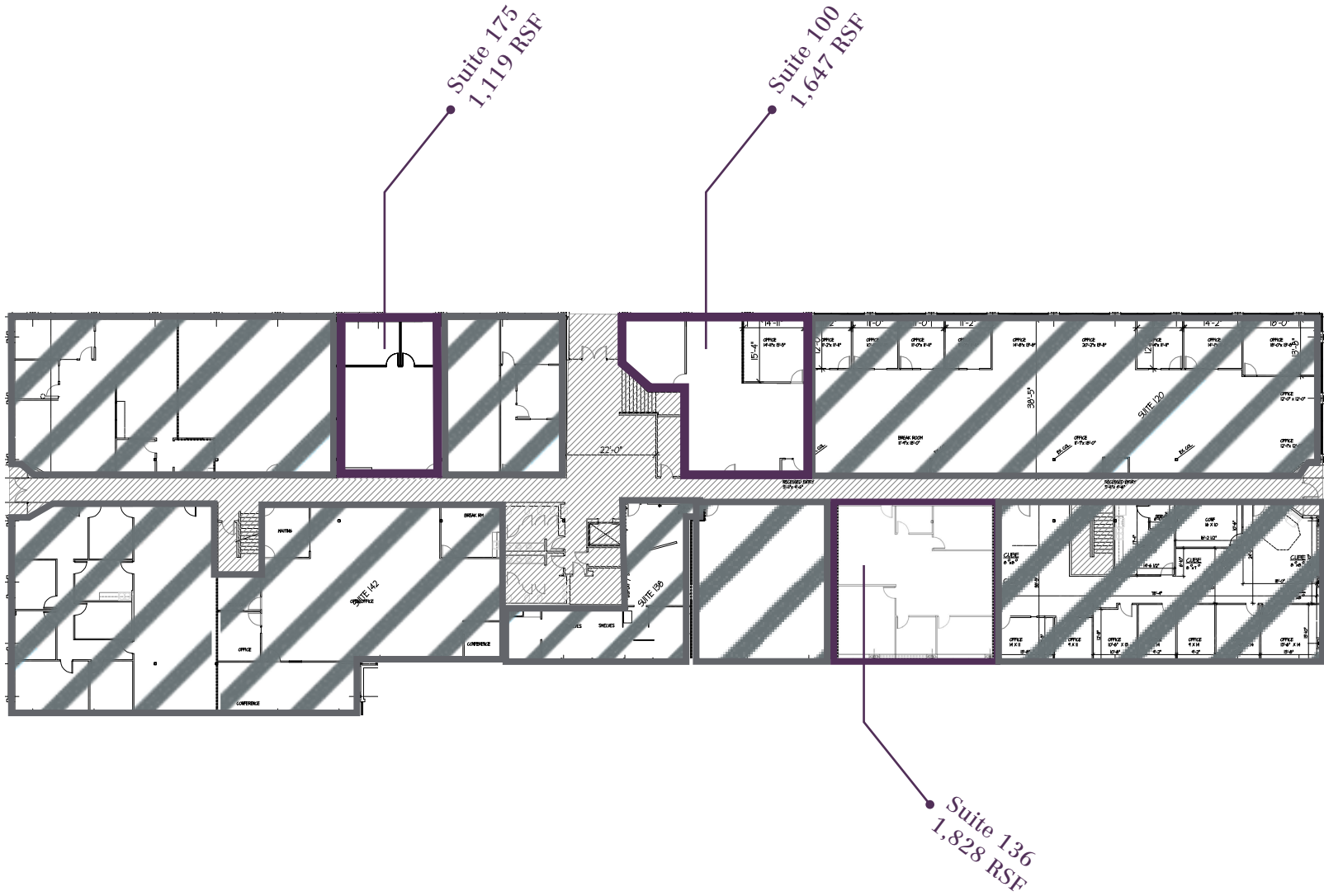

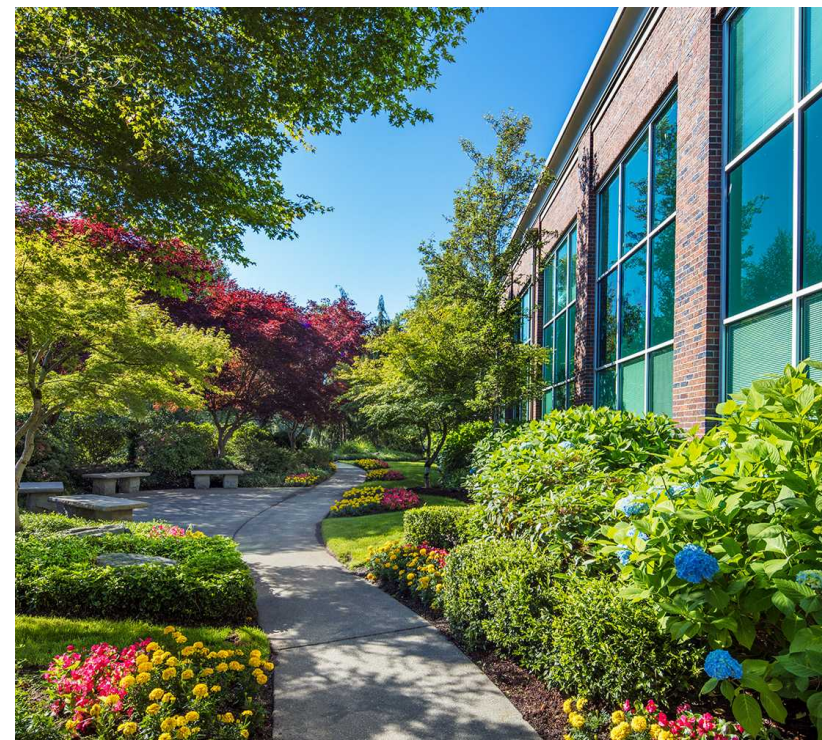

SOUTHCENTER PLAZA – 14900 INTERURBAN AVE S, TUKWILA, WA

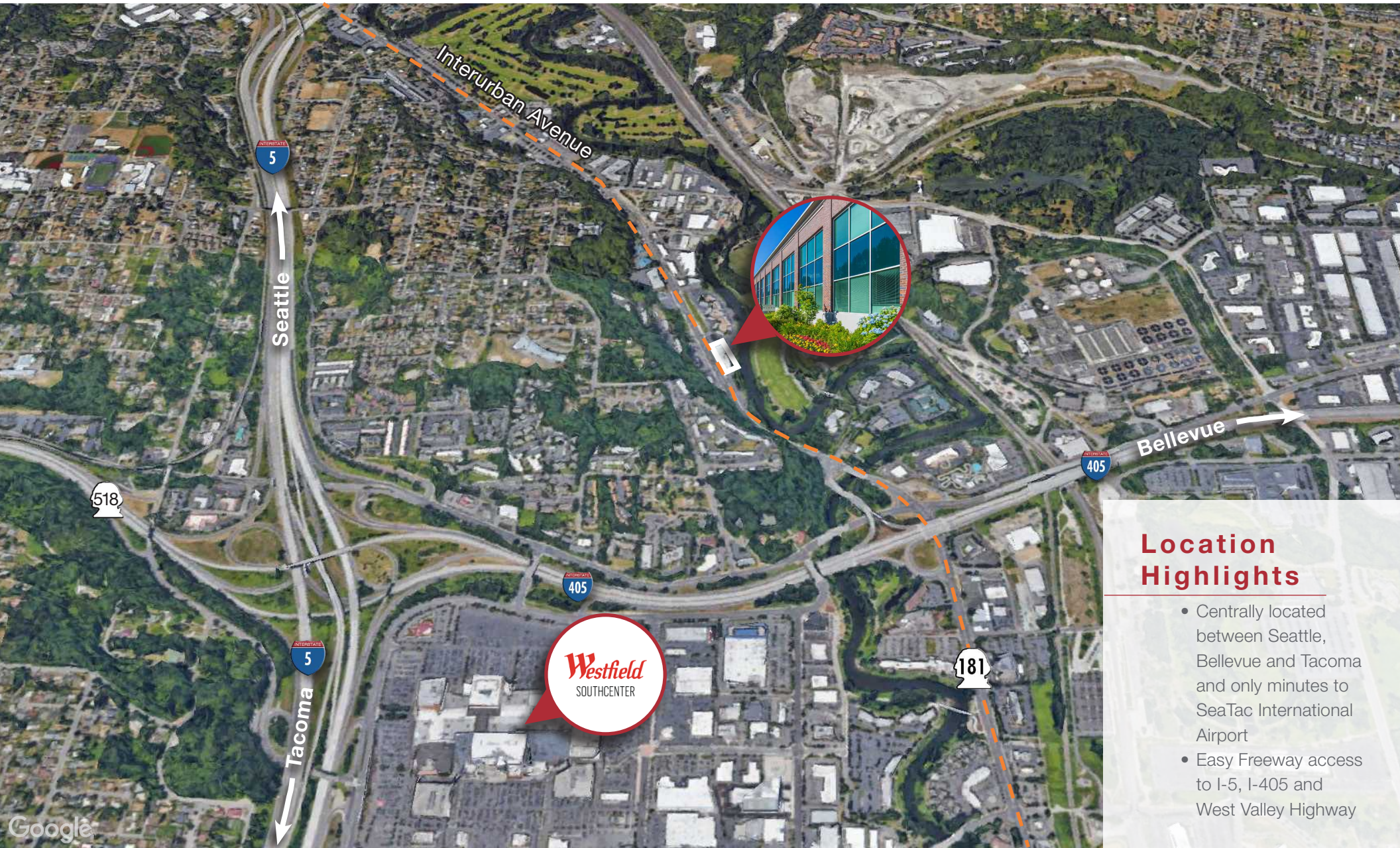

Location Highlights

- Centrally located between Seattle, Bellevue and Tacoma and only minutes to SeaTac International Airport
- Easy Freeway access to I-5, I-405 and West Valley Highway