

For Lease
Lakeland Shopping Center

NAI Black



Lakeland Shopping Center

16376 N. Highway 41, Rathdrum, Idaho 83858

Property Description

Space Available:

- Space B: 6,000 SF ±
- Space C: 1,504 SF ±
- TIA Available
- Pad: 2,400 SF ±

Located on Busy Highway 41

Nearby Tenants:

- Westwood Guns
- Dollar Tree
- Rathdrum Drug
- Wells Fargo Bank
- Heritage Health
- North Idaho Physical Therapy
- ID State Liquor Store
- BiMart

Sprinklered

2 (200 Amp) Panels

High Ceiling

Gas Heat



Space B Lease Rate: \$15.00/PSF/YR NNN

Space C Lease Rate: \$20.00/PSF/YR NNN

Pad: Build - To - Suit or Ground Lease

For more information

Stephen Pohl

O: 509 622 3568

spohl@naiblack.com | ID #AB42233

No warranty or representation, expression or implied, is made as to the accuracy of the information contained herein, and the same is submitted subject to errors, omissions, change or price, rental or other conditions, prior to sale, lease, financing, or withdrawal without notice, and of special listing conditions imposed by our principals no warranties or representations are made as to the condition of the property or any hazards contained therein or any to be implied.

801 W. Riverside Avenue, Suite 300

Spokane, WA 99201

509 623 1000 tel

naiblack.com

For Lease
Lakeland Shopping Center

NAI Black



NAI Black respects the intellectual property rights of others. If you believe that your intellectual property rights have been violated by NAI Black or by a third party who has uploaded Content on our Site, please provide the following information to the NAI Black designated copyright agent as addressed below: a. A description of the copyrighted work or other intellectual property that you claim has been infringed; b. A specific description of where the material that you claim is infringing is located on the Site so the agent is able to locate it; c. An address, telephone number, and e-mail address where NAI Black can contact you and, if different, an e-mail address where the alleged infringing party, if not NAI Black, can contact you; d. A signed statement that you have a good-faith belief that the material use is not authorized by the copyright owner or other intellectual property rights owner, by its agent, or by law. E. A signed statement by you under penalty of perjury that the information in your notice is accurate and that you are the copyright or intellectual property owner or are authorized to act on the owner's behalf. After reviewing the complaint and determining if the complaint is valid, NAI Black will work to quickly remove the infringing material or disable access to it. Note: There are substantial penalties for false claims. NAI Black may request additional information before removing any infringing material. NAI Black may provide the alleged infringing party with your e-mail address so that that person can respond to your allegations. NAI Black has registered a designated agent with the Copyright Office pursuant to 17 U.S.C. 512(c). If you believe your copyright material is being used on this Site without permission, please notify the designated agent as follows:
By e-mail: mary@commercialmls.com | Subject Line: Copyright Concern
By mail: Commercial Brokers Association! Attn: DMCA Designated Agent | 12131 113th Ave NE Suite 101 | Kirkland, WA 98034

If e-mailing your copyright infringement notice, then NAI Black must receive the signed statement(s) mentioned above by mail, or attached to the e-mail, before we are required to take action.

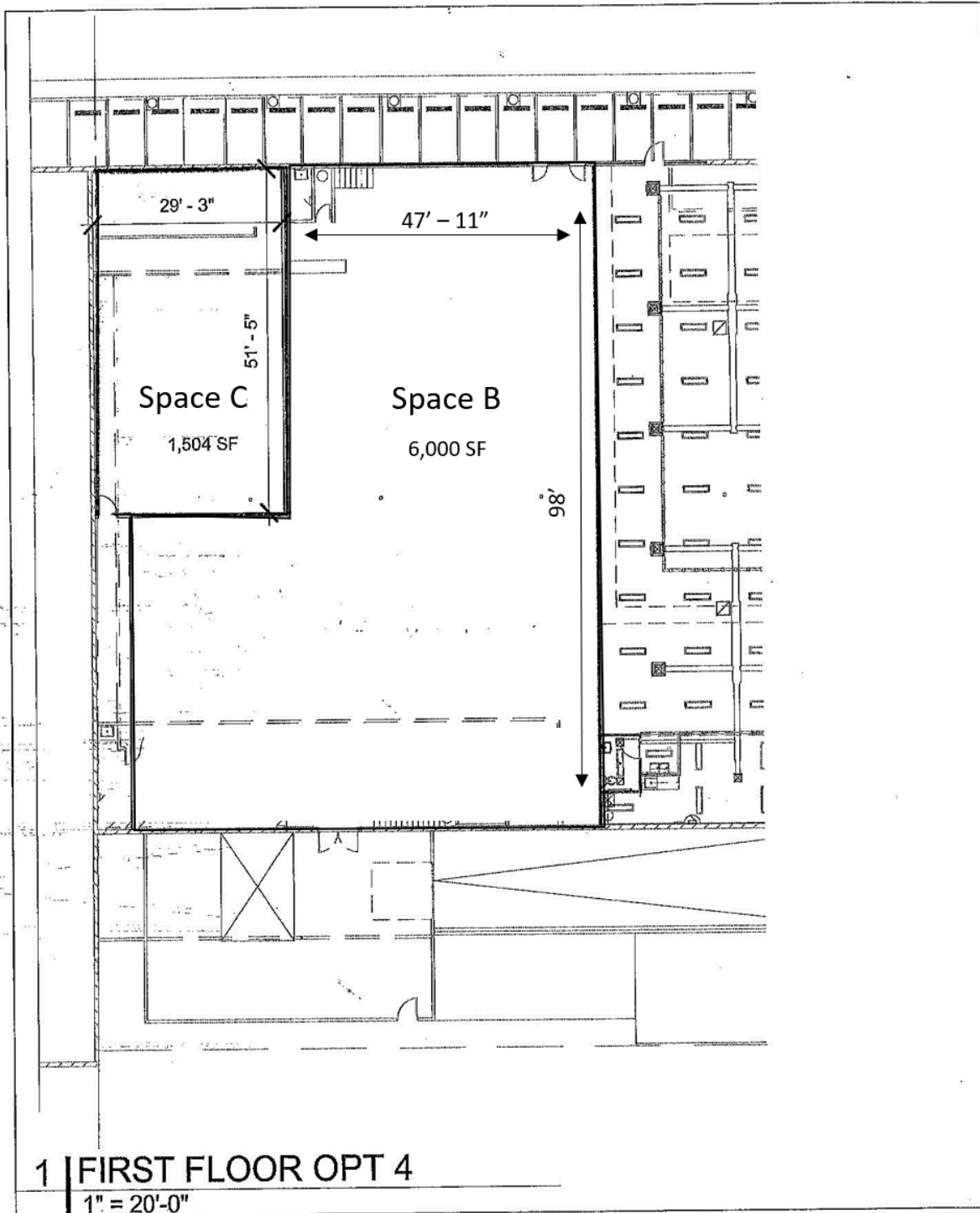

**INDIGO DIGGS
ARCHITECTURE**
1912 E SPRAGUE AVE,
SPOKANE, WA 99202
OFFICE: 509.443.6435

RATHDRUM TI

OWNER
STREET AND CITY
PHONE NUMBER

OPTION 4

A04

Date 03/10/22

For Lease
Retail

NAIBlack

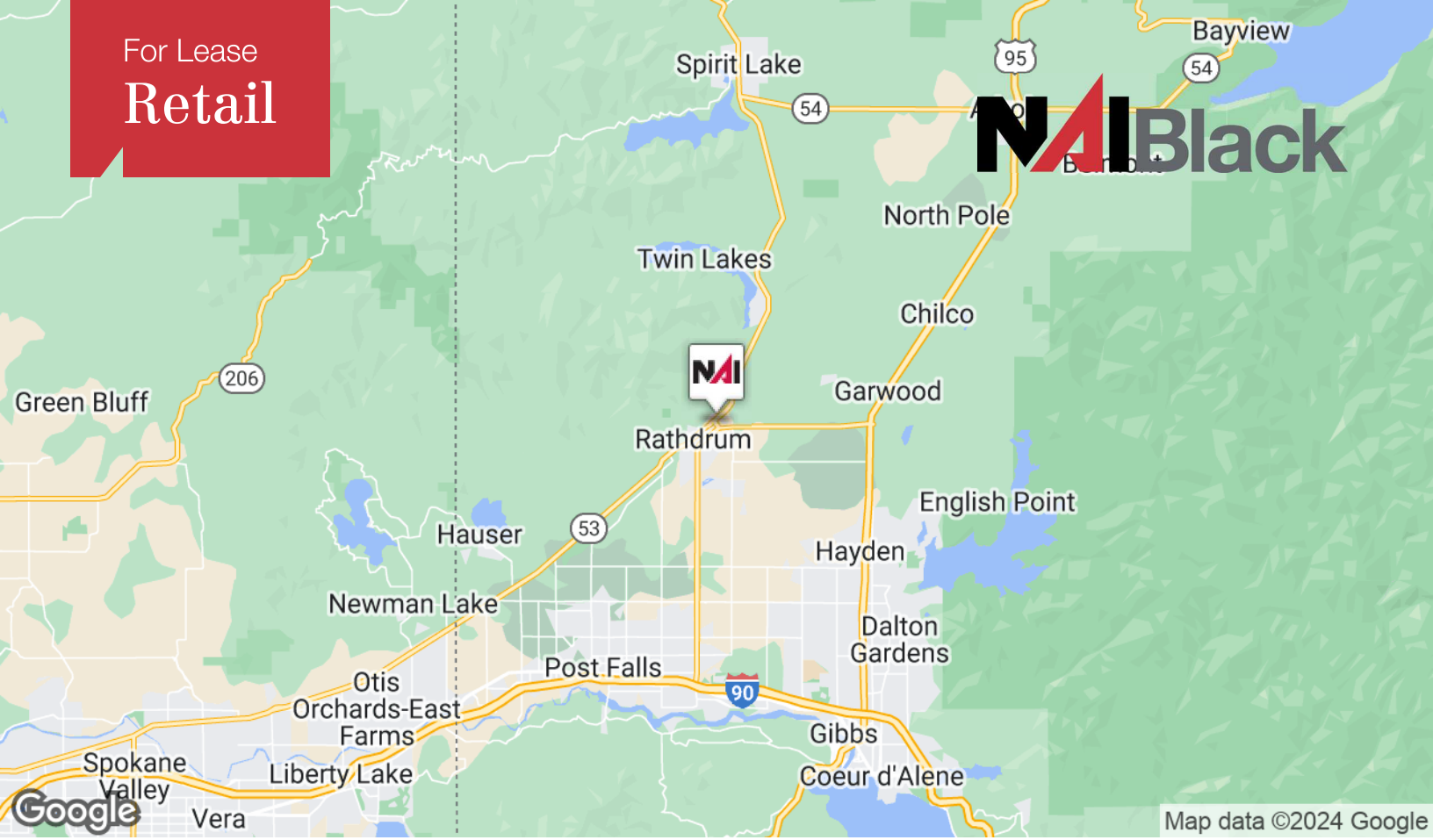

Map data ©2024 Google



Map data ©2024 Imagery ©2024 Airbus,
Maxar Technologies

NAI Black respects the intellectual property rights of others. If you believe that your intellectual property rights have been violated by NAI Black or by a third party who has uploaded Content on our Site, please provide the following information to the NAI Black designated copyright agent as addressed below: a. A description of the copyrighted work or other intellectual property that you claim has been infringed; b. A specific description of where the material that you claim is infringing is located on the Site so the agent is able to locate it; c. An address, telephone number, and e-mail address where NAI Black can contact you and, if different, an e-mail address where the alleged infringing party, if not NAI Black, can contact you; d. A signed statement that you have a good-faith belief that the material use is not authorized by the copyright owner or other intellectual property rights owner, by its agent, or by law. E. A signed statement by you under penalty of perjury that the information in your notice is accurate and that you are the copyright or intellectual property owner or are authorized to act on the owner's behalf. After reviewing the complaint and determining if the complaint is valid, NAI Black will work to quickly remove the infringing material or disable access to it. Note: There are substantial penalties for false claims. NAI Black may request additional information before removing any infringing material. NAI Black may provide the alleged infringing party with your e-mail address so that that person can respond to your allegations. NAI Black has registered a designated agent with the Copyright Office pursuant to 17 U.S.C. 512(c). If you believe your copyright material is being used on this Site without permission, please notify the designated agent as follows:
By e-mail: mary@commercialnais.com | Subject Line: Copyright Concern
By mail: Commercial Brokers Association Attn: DMCA Designated Agent | 12131 113th Ave NE Suite 101 | Kirkland, WA 98034

If e-mailing your copyright infringement notice, then NAI Black must receive the signed statement(s) mentioned above by mail, or attached to the e-mail, before we are required to take action.

For Lease
Lakeland Shopping Center



Miles	3 Miles	5 Miles	10 Miles
Total Population	13,987	19,438	156,179
Median Age	37.5	39.6	39.6
Average Household Income	99,558	102,392	95,715,

Drive Time	5 Mins.	10 Mins.	15 Mins.
Total Population	2,921	15,173	44,189
Median Age	37.1	39.3	38.9
Average Household Income	\$98,514	\$112,758	\$111,972

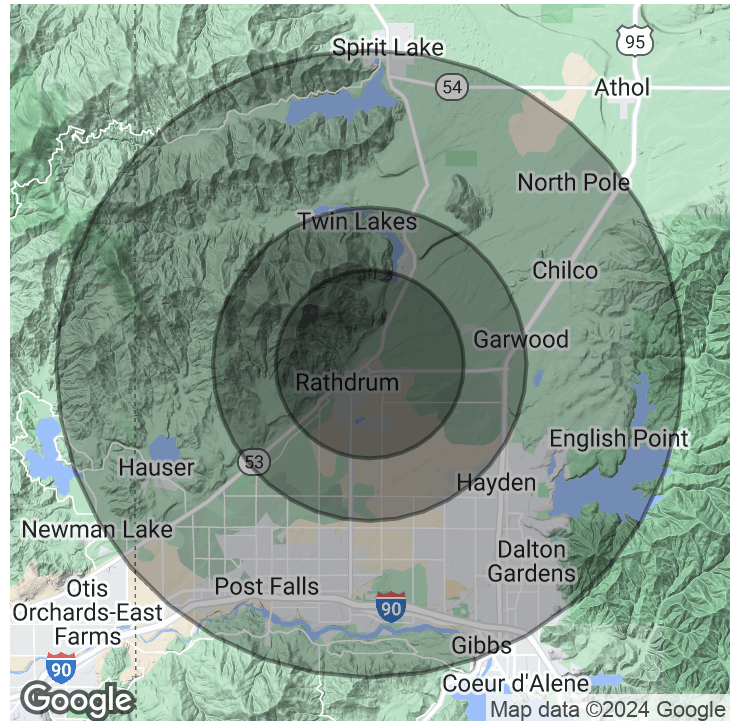

NAI Black respects the intellectual property rights of others. If you believe that your intellectual property rights have been violated by NAI Black or by a third party who has uploaded Content on our Site, please provide the following information to the NAI Black designated copyright agent as addressed below: a. A description of the copyrighted work or other intellectual property that you claim has been infringed; b. A specific description of where the material that you claim is infringing is located on the Site so the agent is able to locate it; c. An address, telephone number, and e-mail address where NAI Black can contact you and, if different, an e-mail address where the alleged infringing party, if not NAI Black, can contact you; d. A signed statement that you have a good-faith belief that the material use is not authorized by the copyright owner or other intellectual property rights owner, by its agent, or by law. E. A signed statement by you under penalty of perjury that the information in your notice is accurate and that you are the copyright or intellectual property owner or are authorized to act on the owner's behalf. After reviewing the complaint and determining if the complaint is valid, NAI Black will work to quickly remove the infringing material or disable access to it. Note: There are substantial penalties for false claims. NAI Black may request additional information before removing any infringing material. NAI Black may provide the alleged infringing party with your e-mail address so that that person can respond to your allegations. NAI Black has registered a designated agent with the Copyright Office pursuant to 17 U.S.C. 512(c). If you believe your copyright material is being used on this Site without permission, please notify the designated agent as follows:
By e-mail: mary@commercialmls.com | Subject Line: Copyright Concern
By mail: Commercial Brokers Association! Attn: DMCA Designated Agent | 12131 113th Ave NE Suite 101 | Kirkland, WA 98034

If e-mailing your copyright infringement notice, then NAI Black must receive the signed statement(s) mentioned above by mail, or attached to the e-mail, before we are required to take action.