



FORMER HAYMAKER RESTURANT

*Turnkey Restaurant in the heart of the West
Seattle Junction*

4706 CALIFORNIA AVE SW, SEATTLE WA

3,100 SF
AVAILABLE

\$45
PSF + NNN

\$7.50/SF
APPROX. NNN

FORMER HAYMAKER RESTAURANT

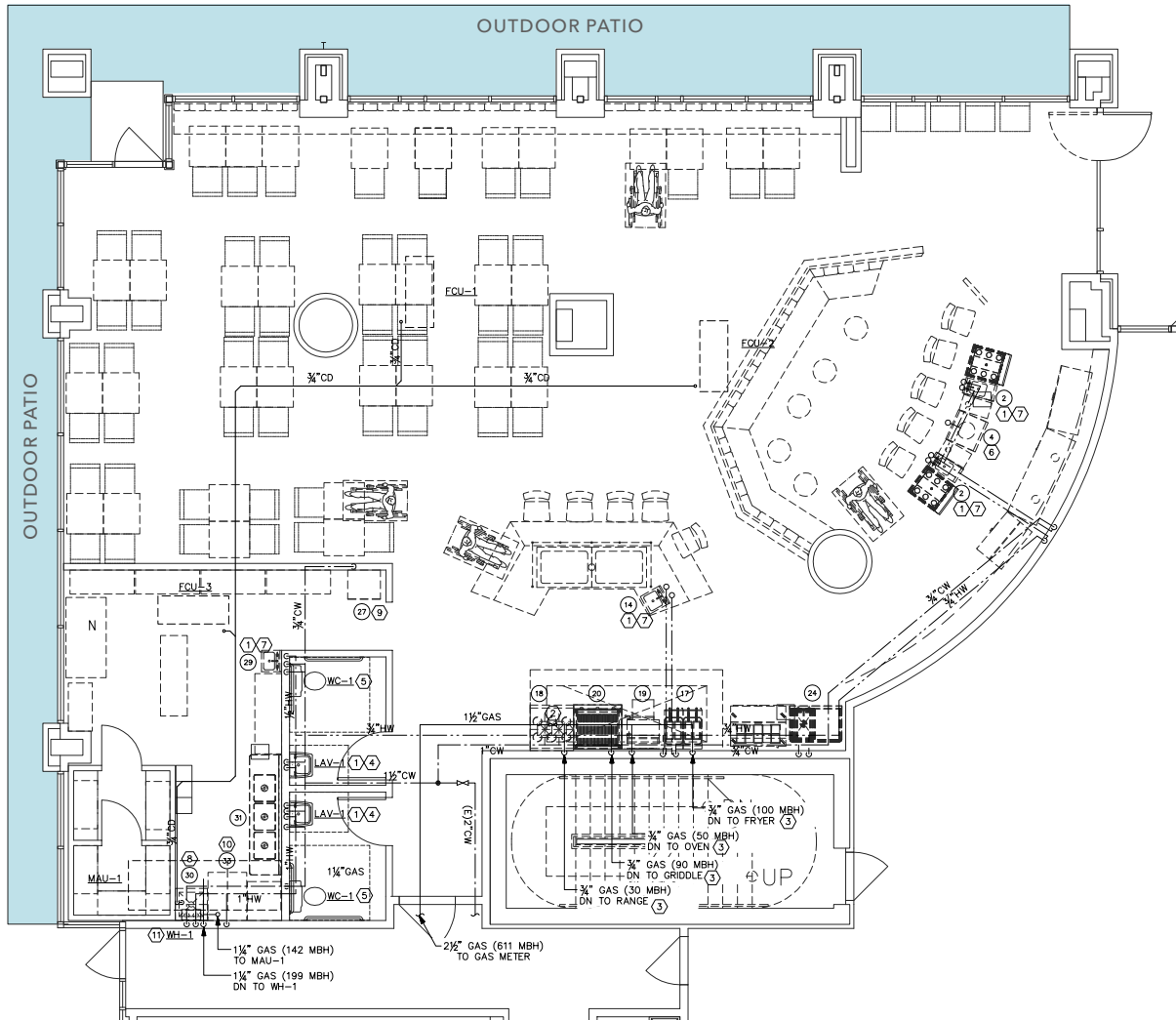

3,100 SF

AVAILABLE

\$45

PSF + NNN

\$7.50/SF

APPROX. NNN

TYPE 1

HOOD IN PLACE

OUTDOOR

PATIO AVAILABLE



DEMOGRAPHICS

POPULATION

	1 Mile	1.5 Miles	2 Miles
ESTIMATED POPULATION (2023)	28,222	50,439	64,977
PROJECTED POPULATION (2028)	30,256	53,409	68,122
PROJECTED ANNUAL GROWTH (2023-2028)	2,034 (1.4%)	2,970 (1.2%)	3,145 (1.0%)

HOUSEHOLDS

	1 Mile	1.5 Miles	2 Miles
ESTIMATED HOUSEHOLDS (2023)	13,777	23,134	29,947
PROJECTED HOUSEHOLDS (2028)	14,612	24,207	30,994
PROJECTED ANNUAL GROWTH (2023-2028)	834 (1.2%)	1,074 (0.9%)	1,047 (0.7%)
ESTIMATED AVERAGE HOUSEHOLD INCOME (2023)	\$177,819	\$180,982	\$185,189
PROJECTED AVERAGE HOUSEHOLD INCOME (2028)	\$183,162	\$188,973	\$195,785

DAYTIME DEMOGRAPHICS

	1 Mile	1.5 Miles	2 Miles
TOTAL BUSINESSES	1,580	2,844	3,566
TOTAL EMPLOYEES	7,651	14,260	18,598

Data Source: ©2023, Sites USA

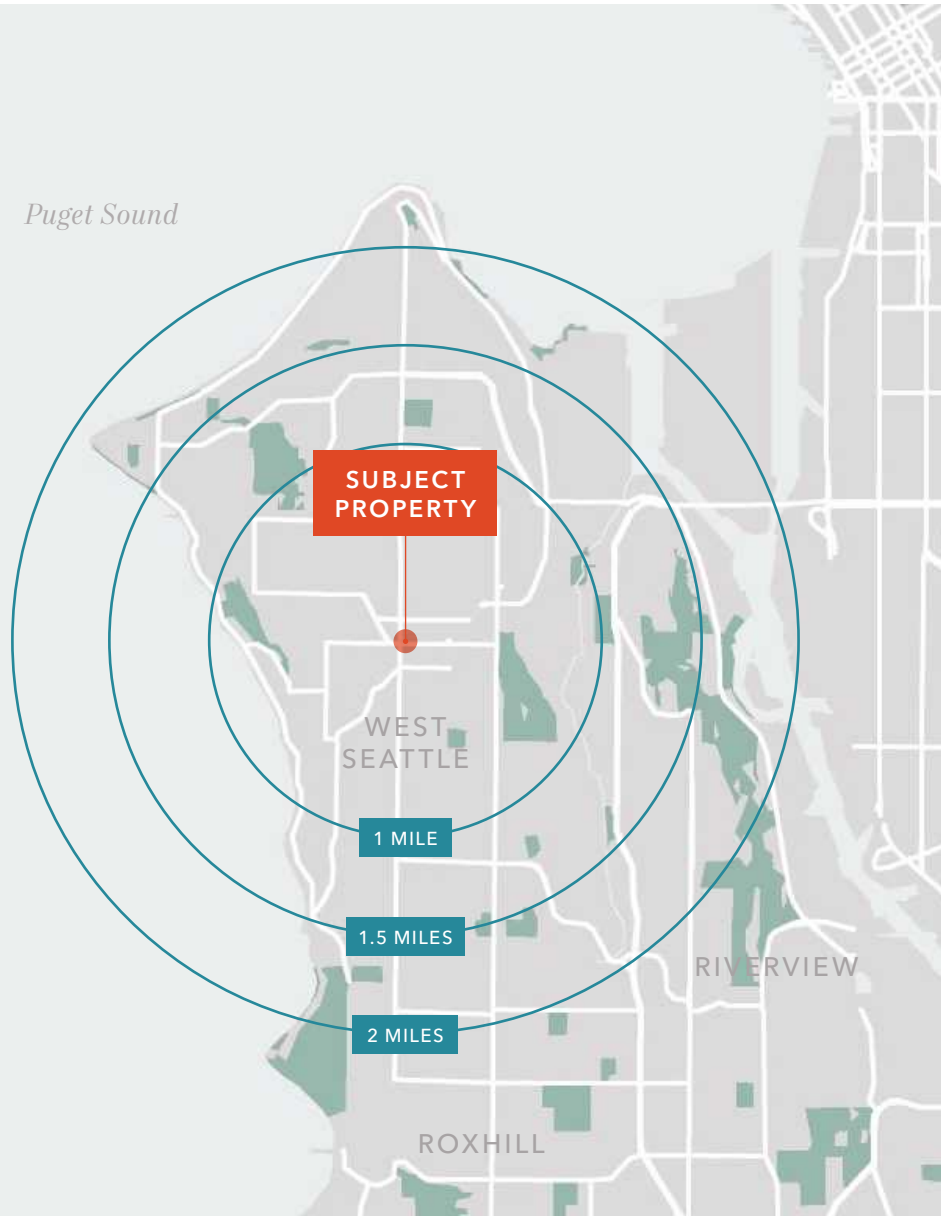

FORMER HAYMAKER RESTAURANT





FORMER HAYMAKER RESTAURANT

*For more information on
this property, please contact*

JASON MILLER
206.296.9649
jason.miller@kidder.com

KIDDER.COM

This information supplied herein is from sources we deem reliable. It is provided without any representation, warranty, or guarantee, expressed or implied as to its accuracy. Prospective Buyer or Tenant should conduct an independent investigation and verification of all matters deemed to be material, including, but not limited to, statements of income and expenses. Consult your attorney, accountant, or other professional advisor.

km Kidder
Mathews