

INDUSTRIAL FOR LEASE



LEASE DETAILS

Office Lease Rate:	\$1.00 PSF/Month
Warehouse Lease Rate:	\$1.00 PSF/Month
NNN Expense:	\$0.16 PSF/Month
Total Available Space:	±5,000 SF
Office Area:	±768 SF
Warehouse Area:	±4,232 SF
Mezzanine Storage:	±768 SF (40lbs PSF load as posted)
Lot Size:	±31,741 SF
Parcel Number:	35132.0106
Zoning:	Industrial (I)
Year Built:	1980
HVAC -	
Office:	Gas forced air heat & electric A/C
Warehouse:	Gas fired unit heaters
Grade-Level Doors:	Two (2) 12'W x 14'H
Clearance:	18'6" to 19'
Power:	3 Phase, 400 amps, 240 Volt & 400 Amp single phase
Sewer & Water:	Serviced by City of Spokane
Construction Type:	Concrete Tilt

1507

Building Size:	±10,000 SF
Office:	±1,000 SF
Warehouse:	±9,070 SF

1511

Building Size:	±5,000 SF
Office:	±768 SF
Warehouse:	±4,232 SF

INDUSTRIAL OFFICE & WAREHOUSE

1511 N Thierman Road
Spokane Valley, WA

BUILDING HIGHLIGHTS

- Central location
- Easy I-90 access
- Great truck access
- Building will be painted inside and out
- Offices will have new carpet and paint

CARL GUENZEL

509.755.7543

carlg@kiemlehagood.com

**KIEMLE
HAGOOD**



FLOOR PLAN

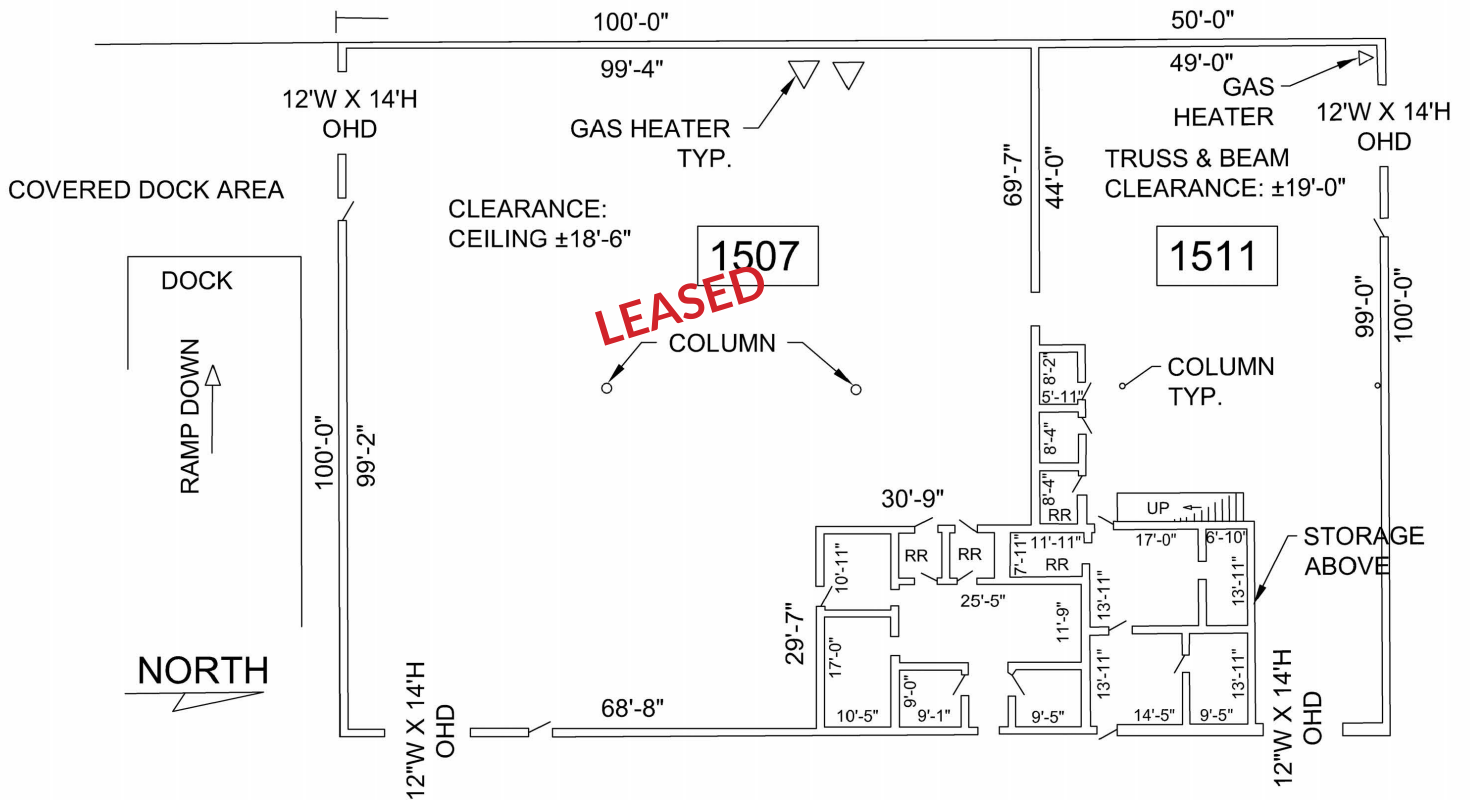

THIS DRAWING IS FOR CONVENIENCE ONLY. ALL CRITICAL MEASUREMENTS SHOULD BE VERIFIED BY PURCHASER OR LESSEE. ALL RIGHTS RESERVED.

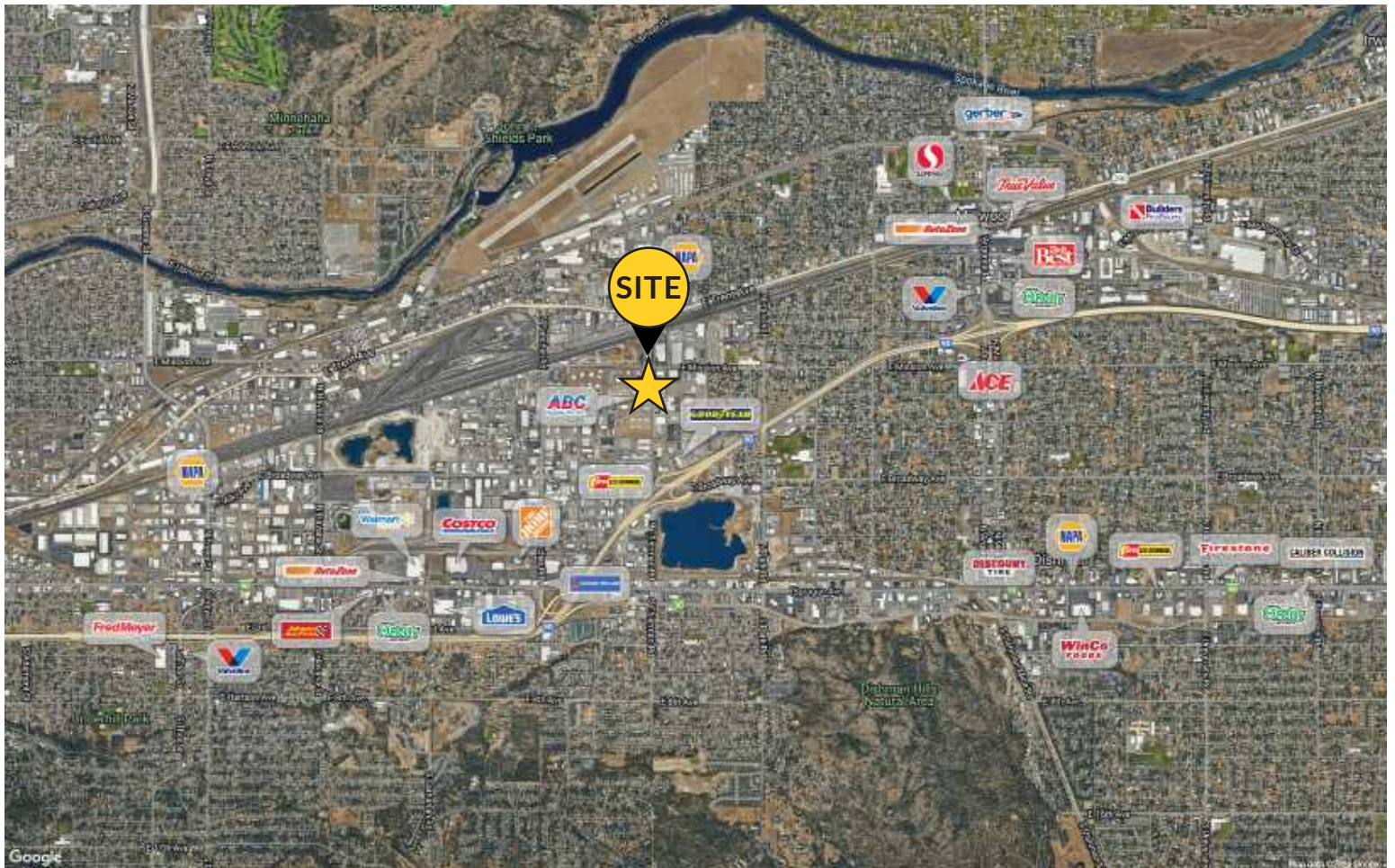

**INDUSTRIAL
OFFICE &
WAREHOUSE**

1511 N Thierman Road
Spokane Valley, WA

CARL GUENZEL
509.755.7543
carlg@kiemlehagood.com

OFFICE LOCATIONS
SPOKANE | COEUR D'ALENE | TRI-CITIES | PALOUSE | MISSOULA

**KIEMLE
HAGOOD**

601 W MAIN AVENUE, SUITE 400
SPOKANE, WA 99201

No warranty or representation, expressed or implied, is made by Kiemle Hagood, its agents or its employees as to the accuracy of the information contained herein. All information furnished is from sources deemed reliable and submitted subject to errors, omissions, change of terms and conditions, prior sale, lease or financing, or withdrawal without notice. No one should rely solely on the above information, but instead should conduct their own investigation to independently satisfy themselves.

Kiemle Hagood respects the intellectual property of others:
If you believe the copyright in your work has been violated through this Website, please contact our office for notice of claims of copyright infringement. For your complaint to be valid under the Digital Millennium Copyright Act of 1998 (DMCA), you must provide the following information when providing notice of the claimed copyright infringement: Identify the material on the Website that you believe infringes your work, with enough detail so that we may locate it on the Website; provide your address, telephone number and email address; provide a statement that you have a good faith belief that the disputed use is not authorized by the copyright owner, its agent, or the law; provide a statement that the information in the notification is accurate, and under penalty of perjury, that the complaining party is authorized to act on behalf of the owner of an exclusive right that is allegedly infringed; and provide your physical or electronic signature. Upon receiving your complaint, Kiemle Hagood will, upon review, remove content that you believe infringes your copyright if the complaint is found to be valid.

