

FOR LEASE

FORMER REGAL MOVIE THEATER

*25,788 sf stand-alone building
under renovation.*

1435 OLNEY AVE SE, PORT ORCHARD, WA 98366

SUBJECT
PROPERTY

SE MILE HILL DR

FORMER REGAL MOVIE THEATER



Property Highlights

Great visibility and location on SE Mile Hill Drive retail corridor

25,788 SF building, available for single tenant or can be demised

148,210 SF of land area (3.4 acres)

11/1,000 parking or 287 parking stalls

CMU construction built in 1989

20 - 24 ft clear height with open floor plan available

Two tax parcels: Kitsap County
302402-3-048-2008 & 302402-3-052-2001

DEMOGRAPHICS

2024	1 Mile	3 Miles	5 Miles
POPULATION	8,517	50,892	106,235
MEDIAN HH INCOME	\$89,589	\$85,365	\$86,359
TOTAL EMPLOYEES	2,240	12,838	27,594

FORMER REGAL MOVIE THEATER



MANCHESTER

Sinclair Inlet

166

PORT ORCHARD

BIG 5 SPORTING GOODS

JOANN

SOUTH KITSAP HIGH SCHOOL

SUBJECT PROPERTY

DOLLAR TREE

BOWL HI JOY

166

SE MILE HILL DR

PARKWOOD

ACE

GOODWILL

GROCERY OUTLET

ALBERTSONS

PAPA MURPHY'S

ORCHARD HEIGHTS ELEMENTARY

Arby's

MIDAS

7 ELEVEN

WELLS FARGO

BURGER KING

MARCUS WHITEMAN MIDDLE SCHOOL

Walgreens

Staples

16

Auto Zone

RITE AID

Kitsap Bank

TacoTime

SAFEWAY

O'Reilly

BIG LOTS!

Fred Meyer

Jiffy Lube

GameStop

Walmart

Wendy's

verizon

Great Clips

Dutch Bros

THE UPS STORE

AT&T

160



FORMER REGAL MOVIE THEATER

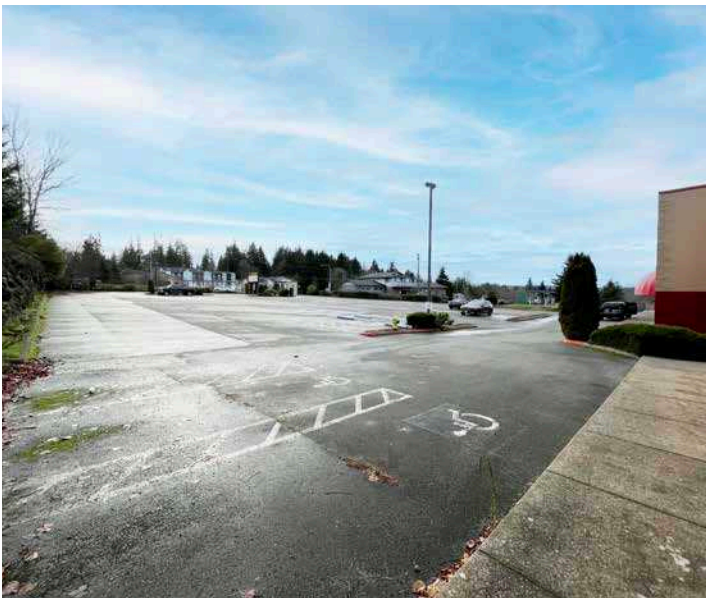

FLOOR PLANS - GROUND FLOOR

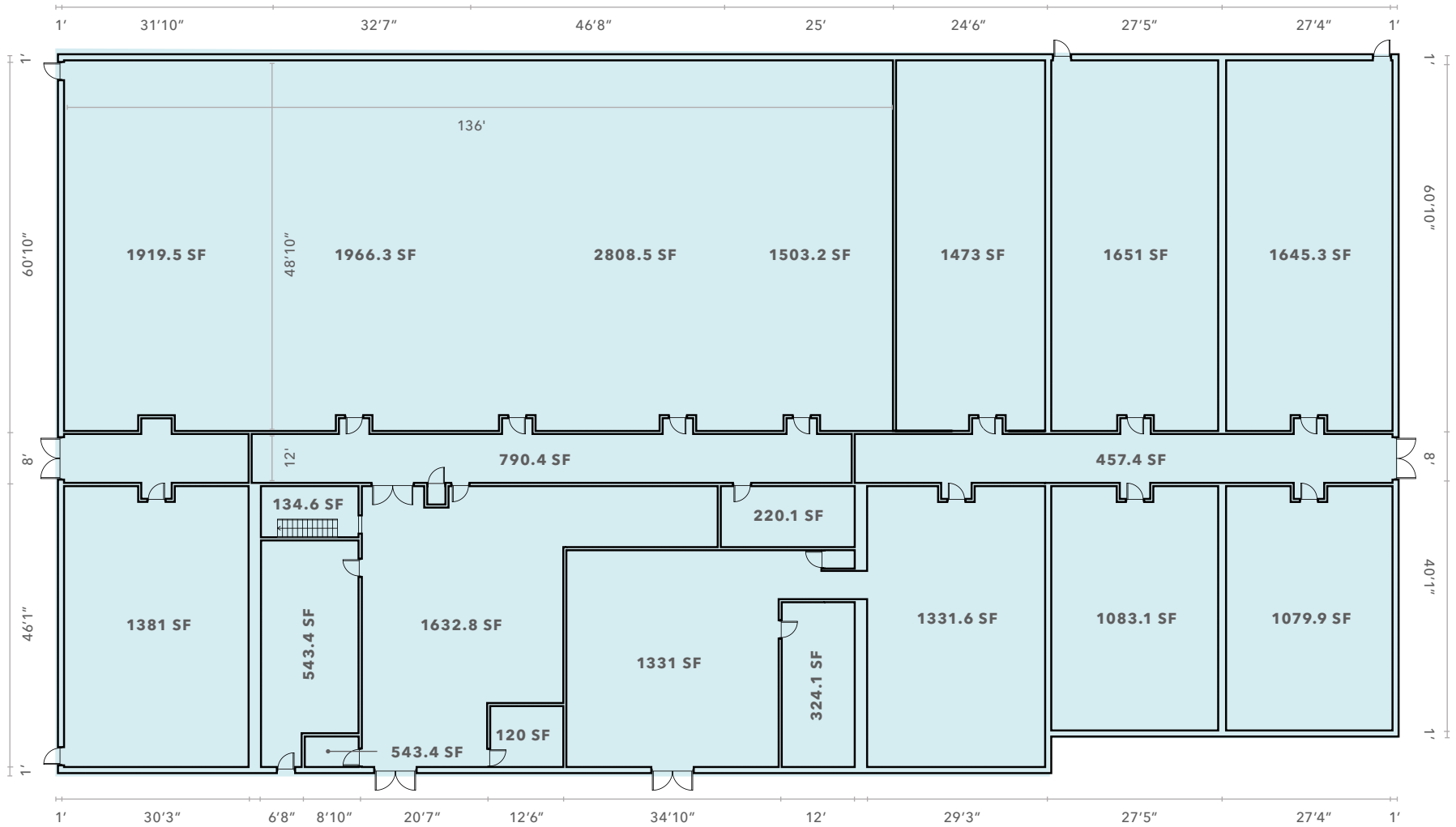

*Entire first renovated and entire first floor can be high ceiling area



FLOOR PLANS - SECOND FLOOR

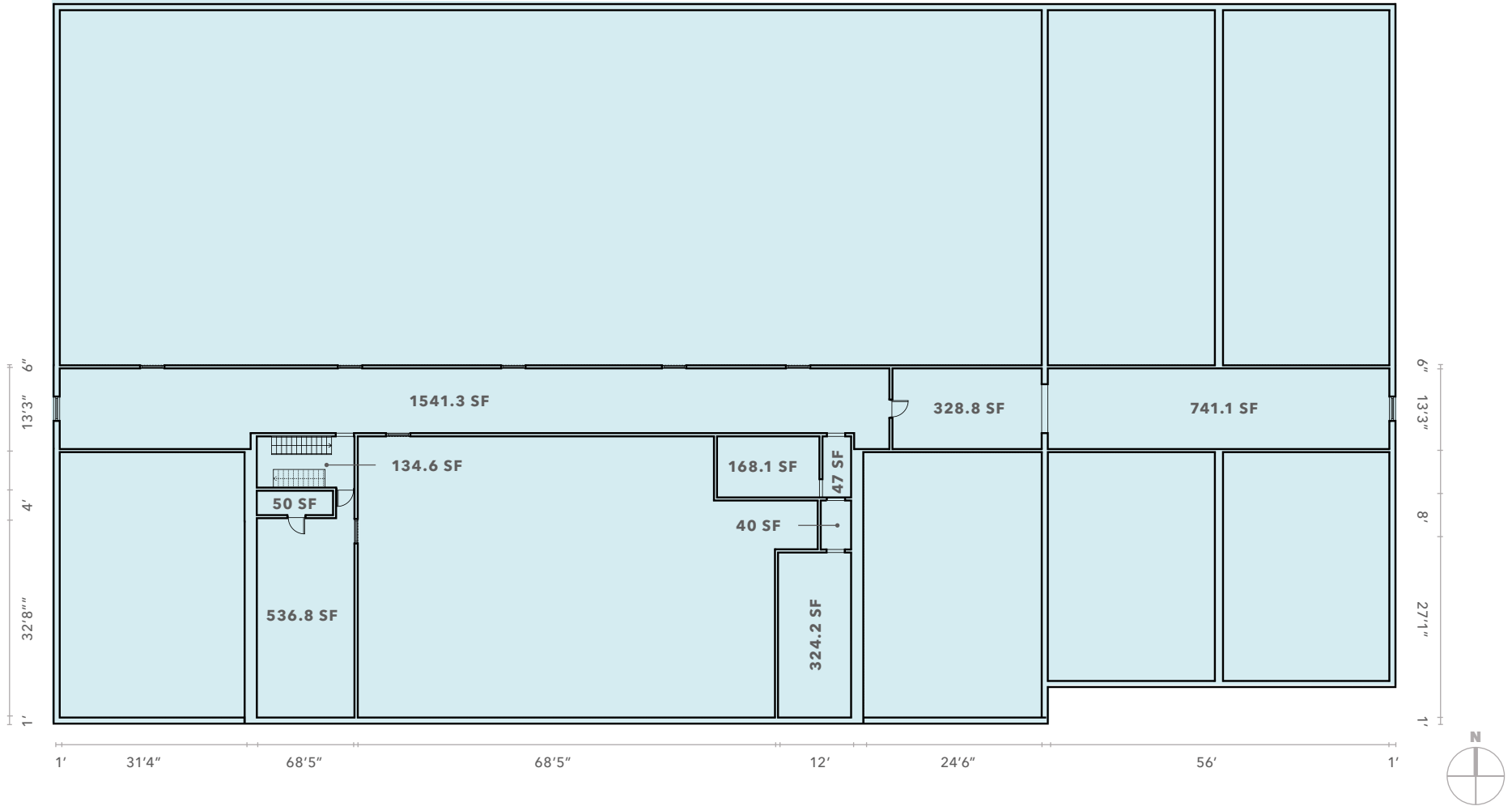

FORMER REGAL MOVIE THEATER

SITE PLAN





SUBJECT
PROPERTY

SE MILE HILL DR

FORMER REGAL MOVIE THEATER

*For more information on
this property, please contact*

BEN NORBE
Executive Vice President
253.722.1410
ben.norbe@kidder.com

KIDDER.COM

This information supplied herein is from sources we deem reliable. It is provided without any representation, warranty, or guarantee, expressed or implied as to its accuracy. Prospective Buyer or Tenant should conduct an independent investigation and verification of all matters deemed to be material, including, but not limited to, statements of income and expenses. Consult your attorney, accountant, or other professional advisor. All Kidder Mathews designs are the sole property of Kidder Mathews. Branded materials and layouts are not authorized for use by any other firm or person.

