

OFFICE FOR LEASE

HALL CREEK OFFICE PARK

6912 220TH STREET SW, MOUNTLAKE TERRACE, WA 98043

LEE & ASSOCIATES
COMMERCIAL REAL ESTATE SERVICES



LISTING DATA

SUITE 113: 1,036 SF

LEASE RATE: \$26.00 SF / Yr (Full Service)

PROPERTY INFORMATION

Flexible space plan includes:

- » Entry/reception with flexible open space
- » Coffee bar with cabinets
- » Two large private or conference rooms
- » Conveniently located near I-5 and Highway 99
- » Fiber available
- » Recent major building upgrades
- » Three-story building
- » Lobbies on both the 1st and 2nd floors

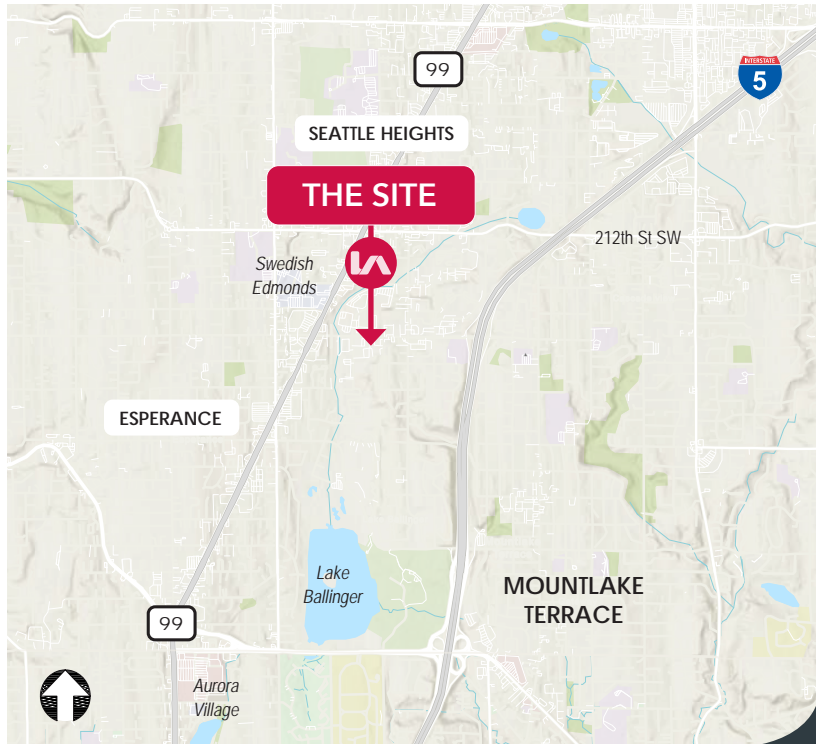

OFFICE FOR LEASE

HALL CREEK OFFICE PARK

6912 220TH STREET SW, MOUNTLAKE TERRACE, WA 98043

**LEE &
ASSOCIATES**
COMMERCIAL REAL ESTATE SERVICES

SUITE 113

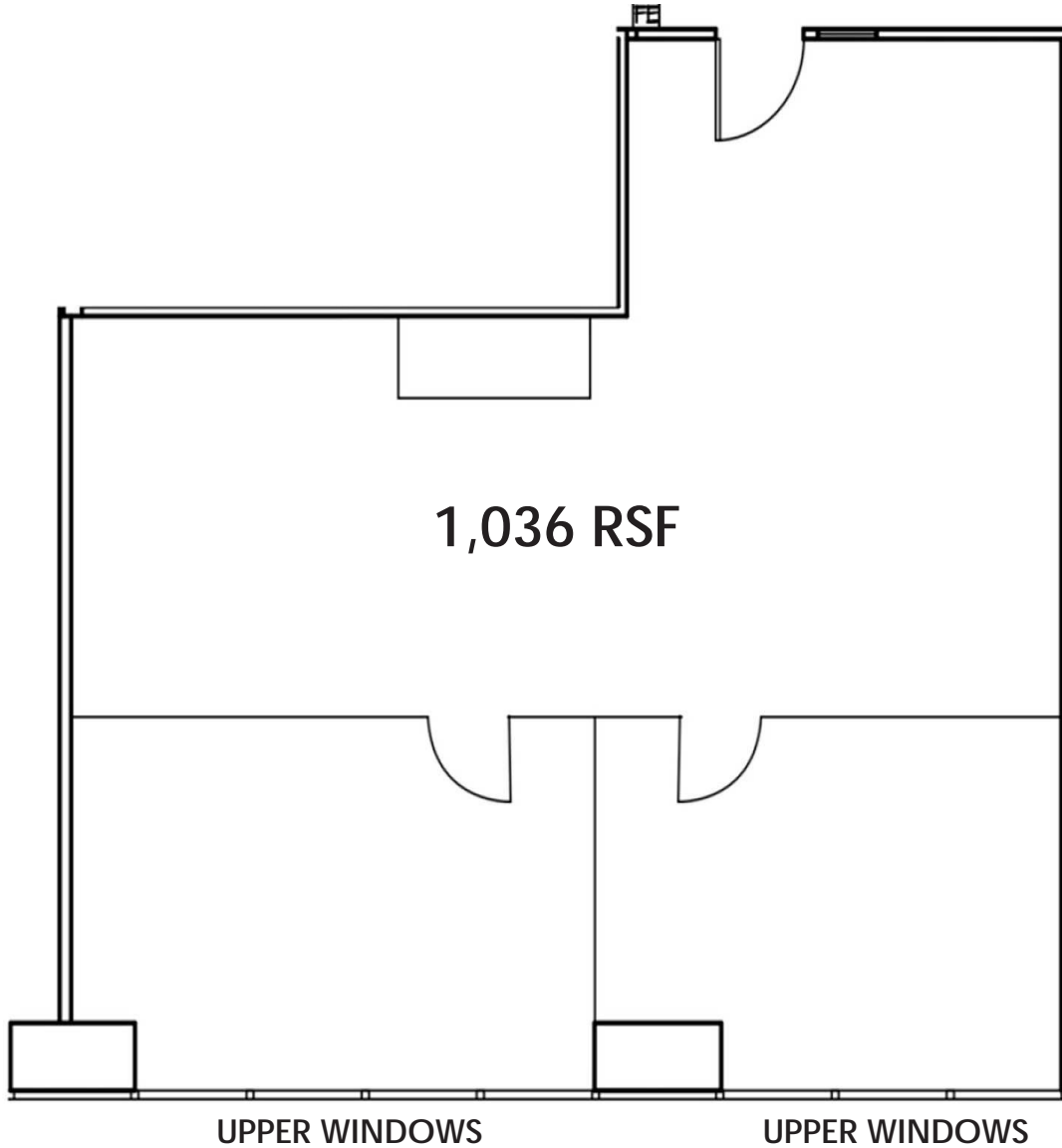

CONTACT

MASON COGLE
mcogle@lee-associates.com
C 425.681.8008

CHRIS PETERSON SIOR, CCIM
cpeterson@lee-associates.com
D 206.773.2678

RICHARD PETERSON
rpeterson@lee-associates.com
D 206.773.2677

All information furnished regarding property for sale, rental or financing is from sources deemed reliable, but no warranty or representation is made to the accuracy thereof and same is submitted to errors, omissions, change of price, rental or other conditions prior to sale, lease or financing or withdrawal without notice. No liability of any kind is to be imposed on the broker herein.

OFFICE FOR LEASE

HALL CREEK OFFICE PARK

6912 220TH STREET SW, MOUNTLAKE TERRACE, WA 98043

LEE & ASSOCIATES
COMMERCIAL REAL ESTATE SERVICES

PHOTOS



CONTACT

MASON COGLE

mcogle@lee-associates.com

C 425.681.8008

CHRIS PETERSON SIOR, CCIM

cpeterson@lee-associates.com

D 206.773.2678

RICHARD PETERSON

rpeterson@lee-associates.com

D 206.773.2677

All information furnished regarding property for sale, rental or financing is from sources deemed reliable, but no warranty or representation is made to the accuracy thereof and same is submitted to errors, omissions, change of price, rental or other conditions prior to sale, lease or financing or withdrawal without notice. No liability of any kind is to be imposed on the broker herein.