

MOUNTAIN INDUSTRIAL CENTER



MOUNTAIN INDUSTRIAL CENTER

For Lease: ±2,976 - 20,998 SF, Available Now

3411 90TH ST S, LAKEWOOD, WA 98499

MATT MCLENNAN, SIOR, CCIM
253.722.1458
matt.mclennan@kidder.com

LAURA FOX, CCIM
253.722.1441
laura.fox@kidder.com

KIDDER.COM

 **Kidder
Mathews**

MOUNTAIN INDUSTRIAL CENTER



PROPERTY OVERVIEW

BAY SIZES AVAILABLE	±2,976 SF ±3,059 SF
GRADE LEVEL DOORS	14' x 12'
CLEAR HEIGHT	21' - 26' (pitched roof)
OFFICE SPACE	Build-to-suit
BASE RENT (MONTHLY)	\$1.50/SF, NNN
NNN	Est. \$0.30/SF Industrial (AC-2) APZ-11 Overlay
ZONING	→ LAND USE TABLE → ZONING CODE → ZONING CODE

KIDDER.COM

This information supplied herein is from sources we deem reliable. It is provided without any representation, warranty, or guarantee, expressed or implied as to its accuracy. Prospective Buyer or Tenant should conduct an independent investigation and verification of all matters deemed to be material, including, but not limited to, statements of income and expenses. Consult your attorney, accountant, or other professional advisor.



MOUNTAIN INDUSTRIAL CENTER

3 MIN

TO I-5

5 MIN

TO SR-512

15 MIN

TO PORT OF TACOMA

30 MIN

TO SEATAC AIRPORT

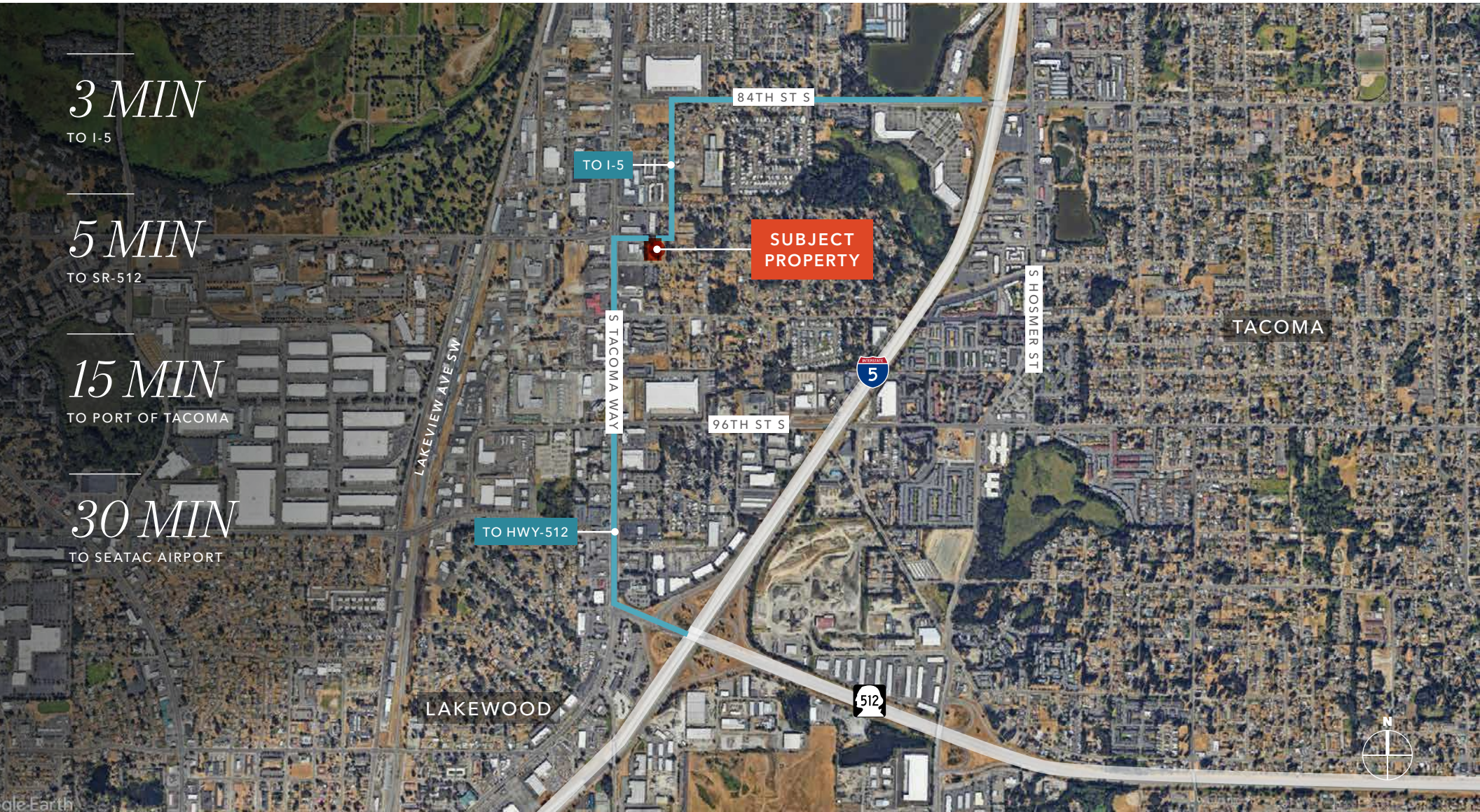

KIDDER.COM

This information supplied herein is from sources we deem reliable. It is provided without any representation, warranty, or guarantee, expressed or implied as to its accuracy. Prospective Buyer or Tenant should conduct an independent investigation and verification of all matters deemed to be material, including, but not limited to, statements of income and expenses. Consult your attorney, accountant, or other professional advisor.



PROPOSED DIVISION 1

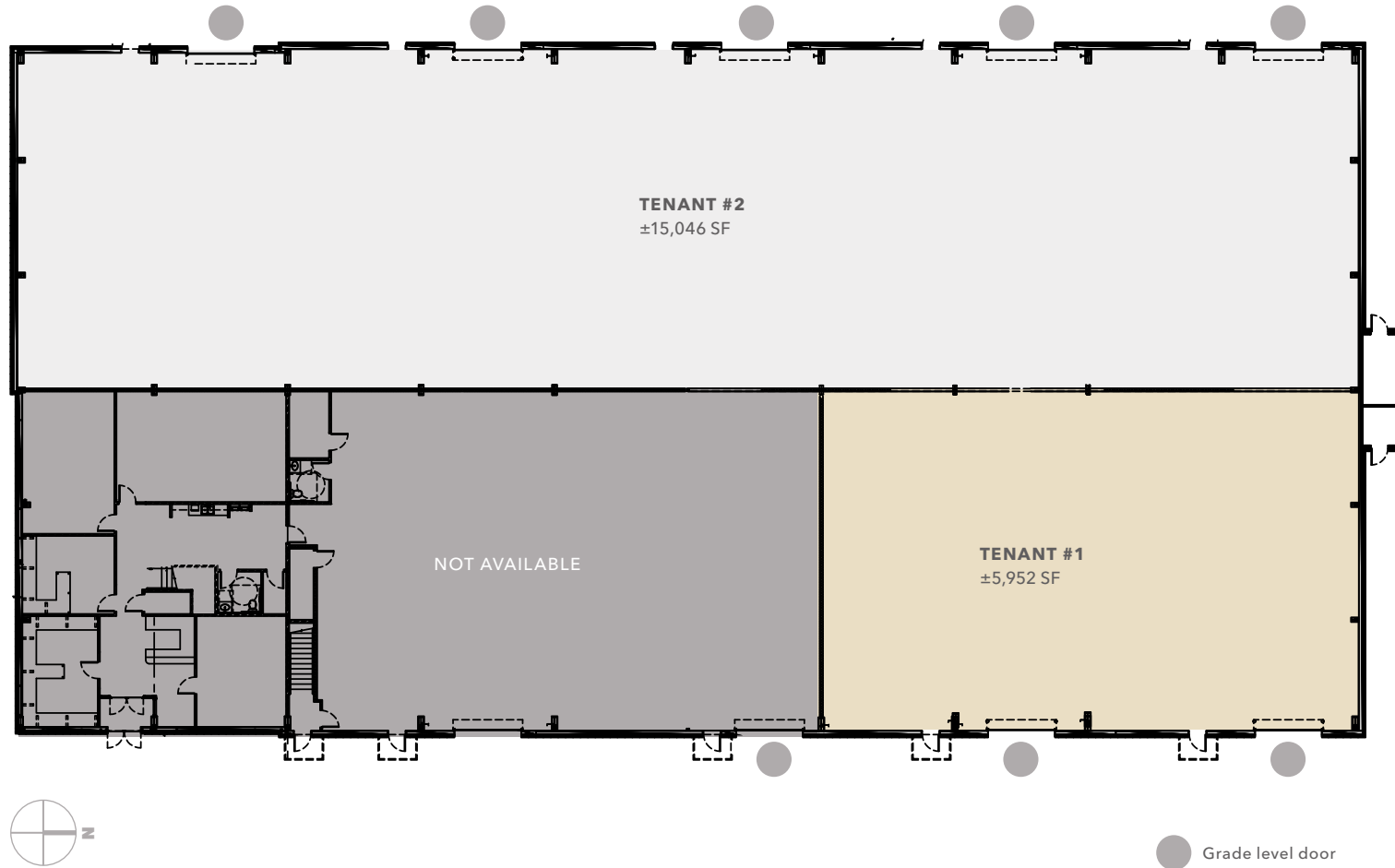

PROPOSED DIVISION 2

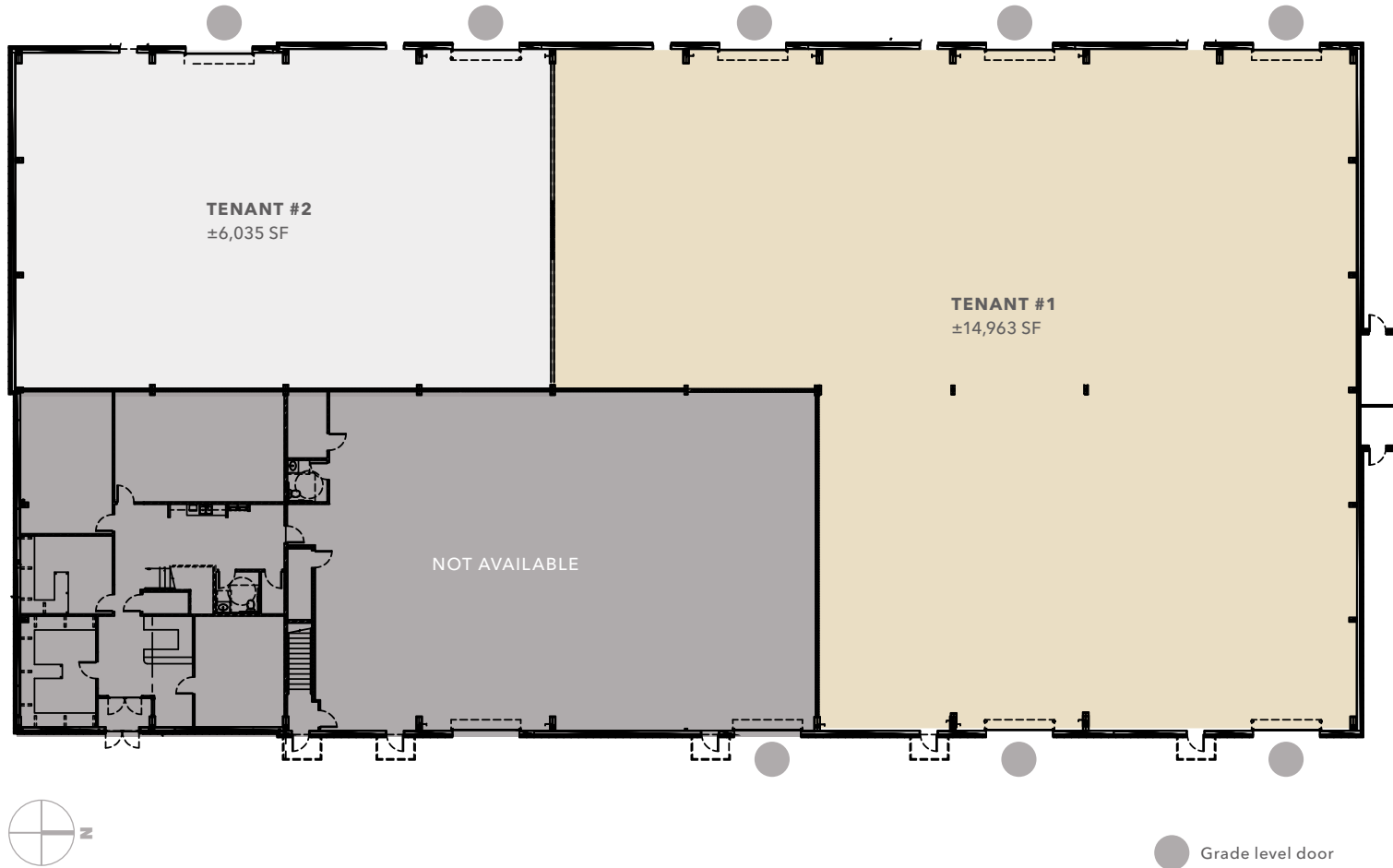

PROPOSED DIVISION 3

