

# LEASE

## ENUMCLAW ACTIVE USE STORAGE

2024 Farman St N Enumclaw, WA 98022



### OFFERING SUMMARY

Lease Rate:	\$1,300.00 - 1,900.00 per month (Full Service)
Available Unit Sizes:	1,300 SF and 1,500 SF
Available Units:	27
Year Built:	2024
Zoning:	LI

### PROPERTY OVERVIEW

Active Use Storage and Garage space. Allowed uses include small business storage and distribution, light fabrication and assembly, RV, Boat, and Auto Storage, personal workshop. 1,300 - 1,500 SF Units available. Shared bathrooms and kitchenette area. Fully fenced with electronic gate access. 24/7 monitored camera and security. Ambient heated floors for freeze protection. 110 power available with options for upgrade. Common vehicle wash bay.

### PROPERTY HIGHLIGHTS

**PREMIUM UNITS- 52' X 29', 24' CLEAR HEIGHT  
28'W X 20'H MOTORIZED BIFOLD HANGAR STYLE OH DOORS**

**STANDARD UNITS- 52' X 25', 18' CLEAR HEIGHT  
16'W X 14'H MOTORIZED OH DOORS**

**Danette Selk**

253 222 1282

danette@cbcworldwide.com

**Brandon Thomas**

206 303 9595

bthomas@cbcworldwide.com



**COLDWELL BANKER  
COMMERCIAL**  
DANFORTH

# LEASE

## ENUMCLAW ACTIVE USE STORAGE

2024 Farman St N Enumclaw, WA 98022

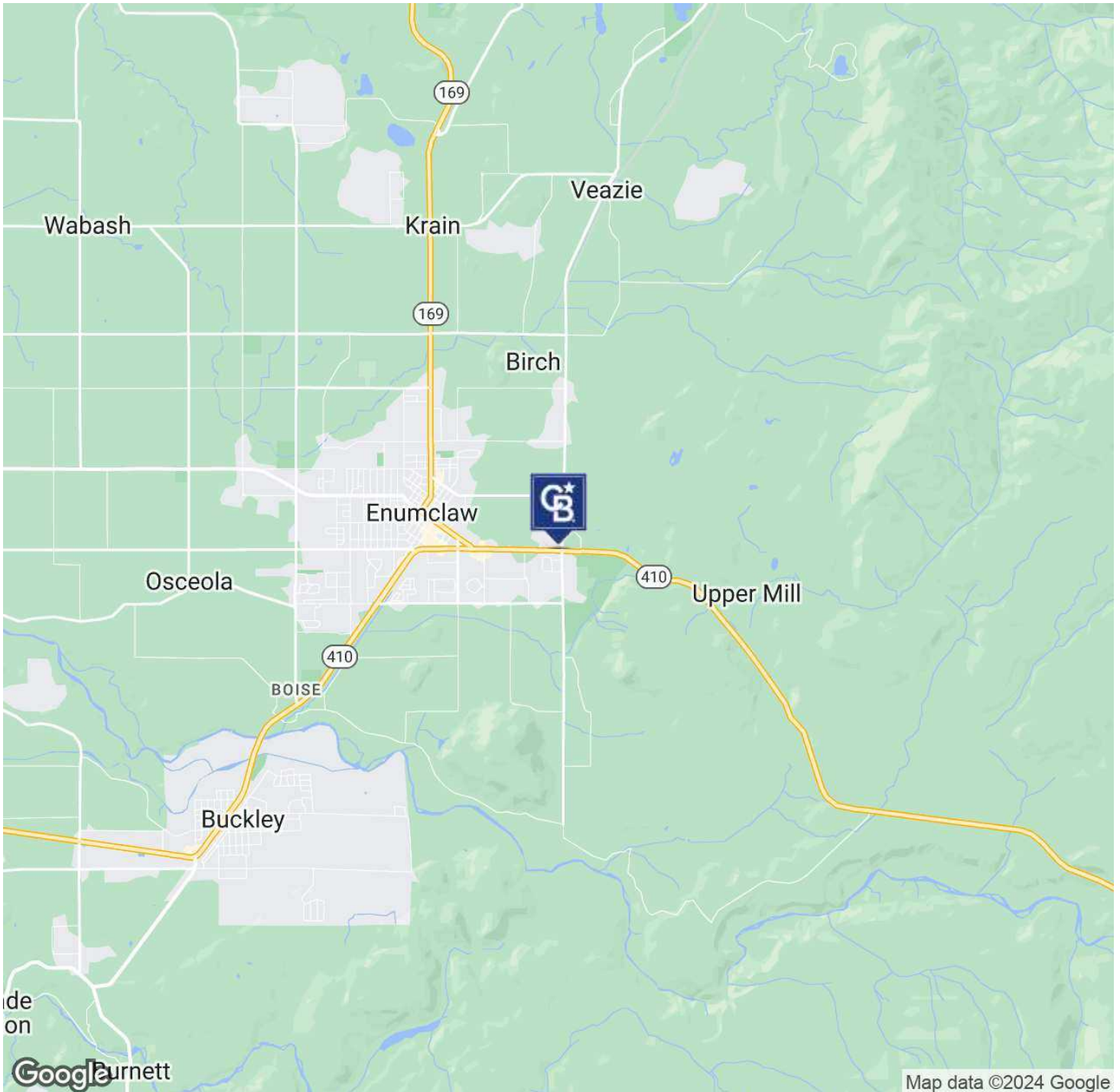

**Danette Selk**  
253 222 1282  
danette@cbcworldwide.com

**Brandon Thomas**  
206 303 9595  
bthomas@cbcworldwide.com



**COLDWELL BANKER  
COMMERCIAL**  
DANFORTH

# LEASE

## ENUMCLAW ACTIVE USE STORAGE

2024 Farman St N Enumclaw, WA 98022

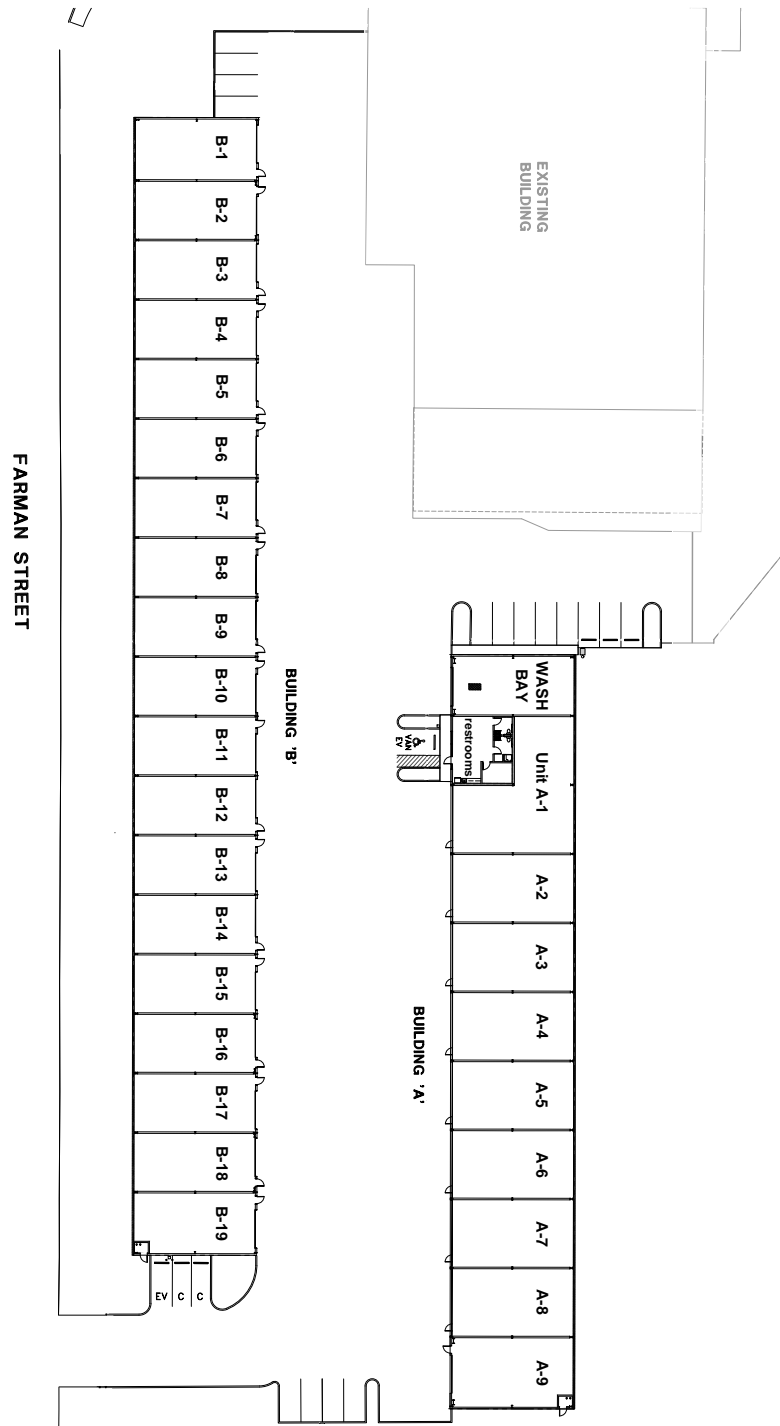

**Danette Selk**

253 222 1282

danette@cbcworldwide.com

**Brandon Thomas**

206 303 9595

bthomas@cbcworldwide.com



**COLDWELL BANKER  
COMMERCIAL**  
DANFORTH

# LEASE

## ENUMCLAW ACTIVE USE STORAGE

2024 Farman St N Enumclaw, WA 98022



**Danette Selk**

253 222 1282

[danette@cbcworldwide.com](mailto:danette@cbcworldwide.com)

**Brandon Thomas**

206 303 9595

[bthomas@cbcworldwide.com](mailto:bthomas@cbcworldwide.com)



**COLDWELL BANKER  
COMMERCIAL**  
DANFORTH