

FOR LEASE

PROPERTY HIGHLIGHTS

- Immediate access to Highway 167
- Exposure to S 180th Street
- Located on the tri-border of Kent, Tukwila and Renton
- Ample parking for employees and customers
- High quality image project

SPRINGBROOK I & II BUSINESS PARK

SOUTH 180TH STREET | KENT, WA 98032



NEWMARK

THAD MALLORY, SIOR
Vice Chairman
425.362.1410
thad.mallory@nrmk.com

CAM WARREN
Managing Director
425.362.1395
cam.warren@nrmk.com

FLOOR PLANS | SPRINGBROOK I

SOUTH 180TH STREET | KENT, WA 98032

SUITE 7863

9,900 SF (1,100 SF OFFICE)

- AVAILABLE NOW
- 19' CLEAR HEIGHT
- 4 DOCK HIGH DOORS

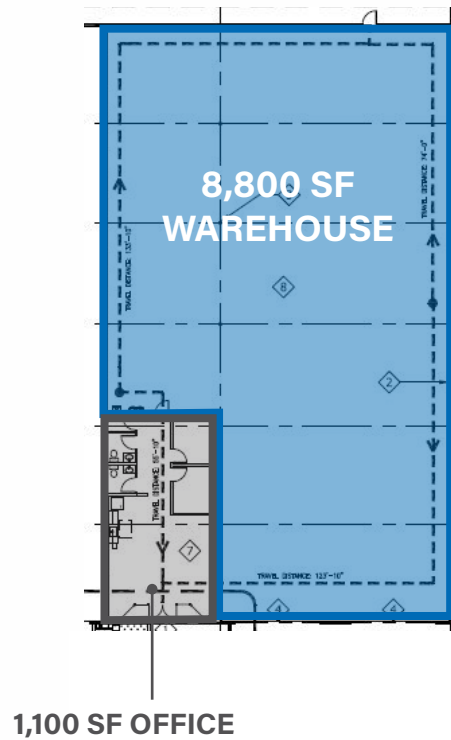

SUITE 7877

14,543 SF (3,881 SF OFFICE)

- AVAILABLE NOW
- 19' CLEAR HEIGHT
- 2 DOCK HIGH DOORS & 1 GRADE LEVEL
- SMALL FENCED SIDE YARD

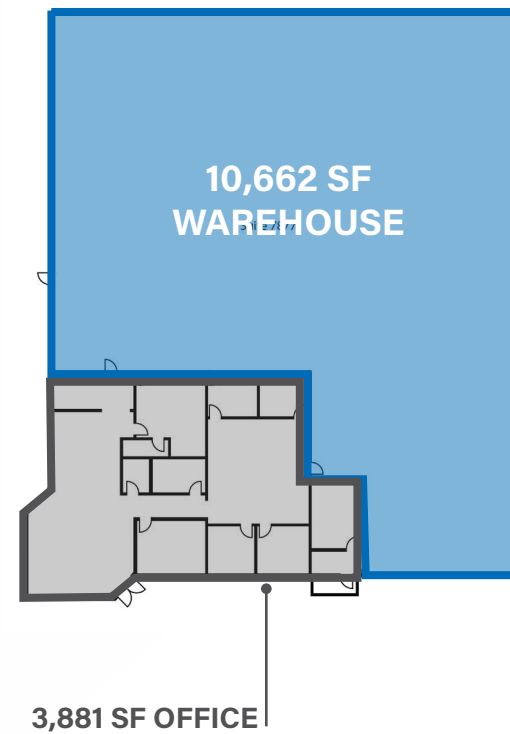

FLOOR PLANS | SPRINGBROOK II

SOUTH 180TH STREET | KENT, WA 98032

SUITE 7687

4,665 SF (2,957 SF OFFICE)

- AVAILABLE NOW
- 1 GRADE LEVEL DOOR
- 14' CLEAR HEIGHT

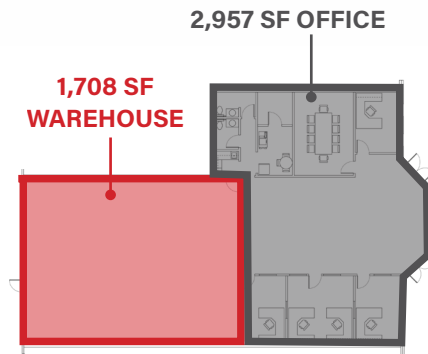

SUITE 7649

4,874 SF (2,180 SF OFFICE)

- AVAILABLE NOW
- 1 GRADE LEVEL DOOR
- 14' CLEAR HEIGHT

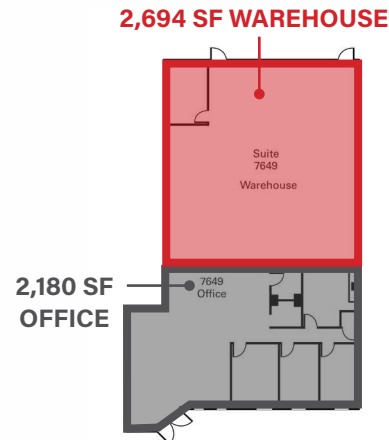

SUITE 7651

6,092 SF (1,778 SF OFFICE)

- AVAILABLE NOW
- 1 DOCK HIGH & 1 GRADE LEVEL DOOR
- 14' CLEAR HEIGHT

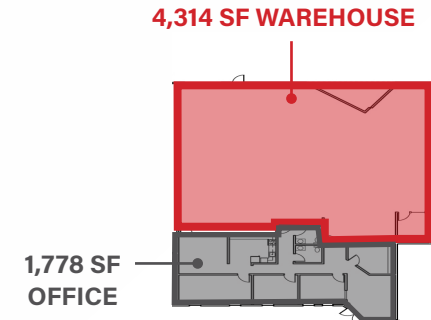



**SPRINGBROOK I & II
BUSINESS PARK**

5 MILES TO SEATAC AIRPORT / 15 MILES TO PORT OF SEATTLE / 22 MILES TO PORT OF TACOMA

NEWMARK

The distributor of this communication is performing acts for which a real estate license is required. The information contained herein has been obtained from sources deemed reliable but has not been verified and no guarantee, warranty or representation, either express or implied, is made with respect to such information. Terms of sale or lease and availability are subject to change or withdrawal without notice.

THAD MALLORY, SIOR
Vice Chairman
425.362.1410
thad.mallory@nmrk.com

CAM WARREN
Managing Director
425.362.1395
cam.warren@nmrk.com