

FOR LEASE

SEATTLE GATEWAY CENTER 1

90,354 SF | 1201 S 140th St, Suite 120, Burien, WA



NEWMARK

THAD MALLORY, SIOR

thad.mallory@nmrk.com
425-362-1410

TAYLOR HOFF, SIOR

taylor.hoff@nmrk.com
425-362-1388

CAM WARREN

cam.warren@nmrk.com
425-362-1395

EVAN LUGAR

evan.lugar@nmrk.com
425-362-1403

FOR LEASE

SEATTLE GATEWAY CENTER 1

90,354 SF | 1201 S 140th St, Suite 120, Burien, WA

FLOOR PLAN

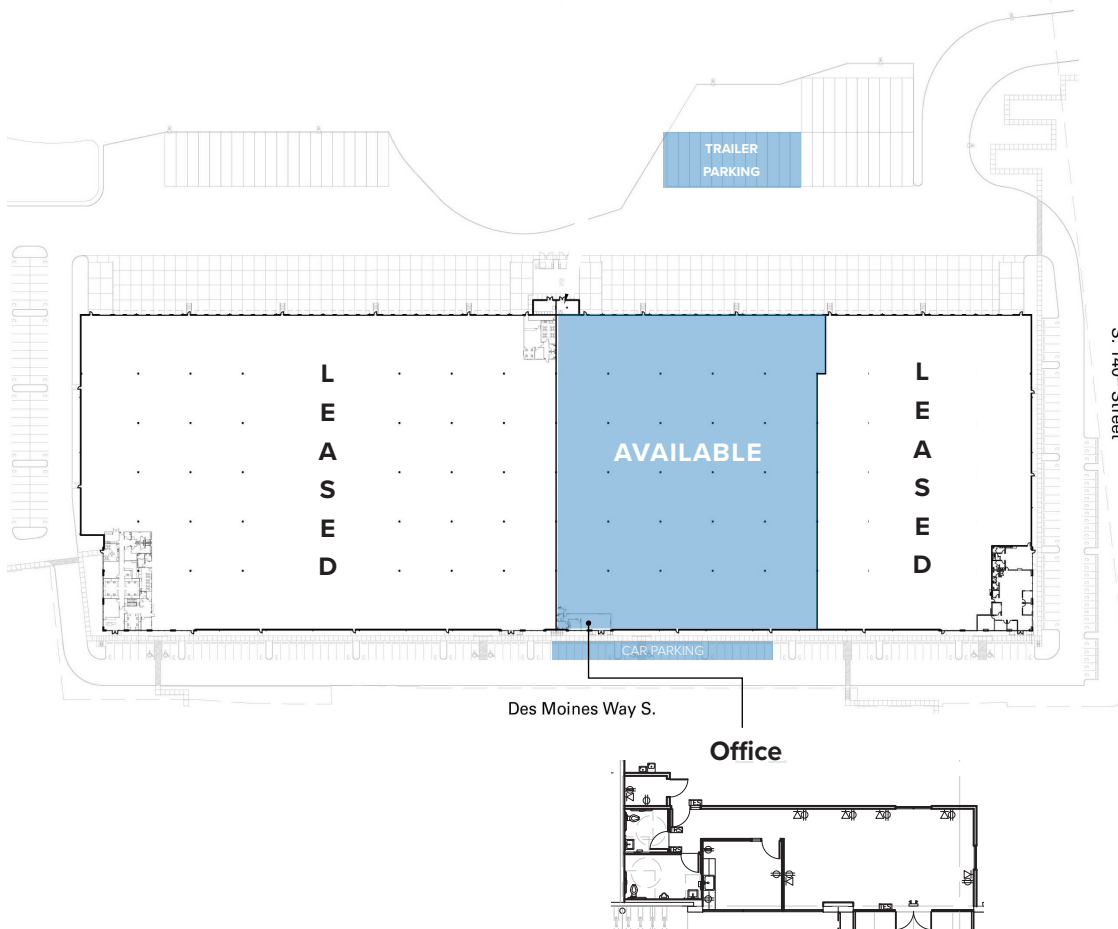

BUILDING DETAILS

ADDRESS

1201 S 140th St, Suite 120
Burien, WA

TOTAL SF

90,354 SF (1,048 SF Office)

CLEAR HEIGHT

36'

LOADING

18 Dock High Doors
1 Grade Level Door

TRAILER PARKING

12 stalls

CAR PARKING

25 stalls

PROPERTY HIGHLIGHTS

- Available May 1, 2025
- ESFR Sprinklers

FOR LEASE

SEATTLE GATEWAY CENTER 1

90,354 SF | 1201 S 140th St, Suite 120, Burien, WA

AERIAL MAP

