

±25,251 SF

Industrial Space For Lease



Prologis Fife 15



7217 45th Ct St E, Suite 103
Fife, WA 98424

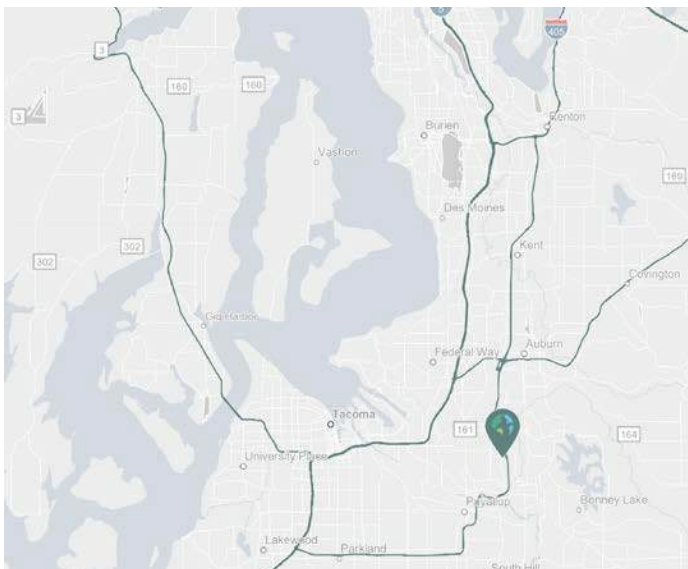

LOCATION

- Excellent access to I-5 & Port of Tacoma
- Five miles to the Port of Tacoma Main Gate

FACILITY

- ±25,251 total SF
- ±22,270 SF of warehouse
- ±2,981 SF of office
- 5 dock-high doors, 1 drive-in door
- 28' clear-height
- Column spacing 54' x 50'
- ESFR
- LED lighting
- Fiber optic internet to building

Your single-source service for efficient move-in and operations: prologisessentials.com

±25,251 SF



Industrial Space For Lease

Prologis Fife 15

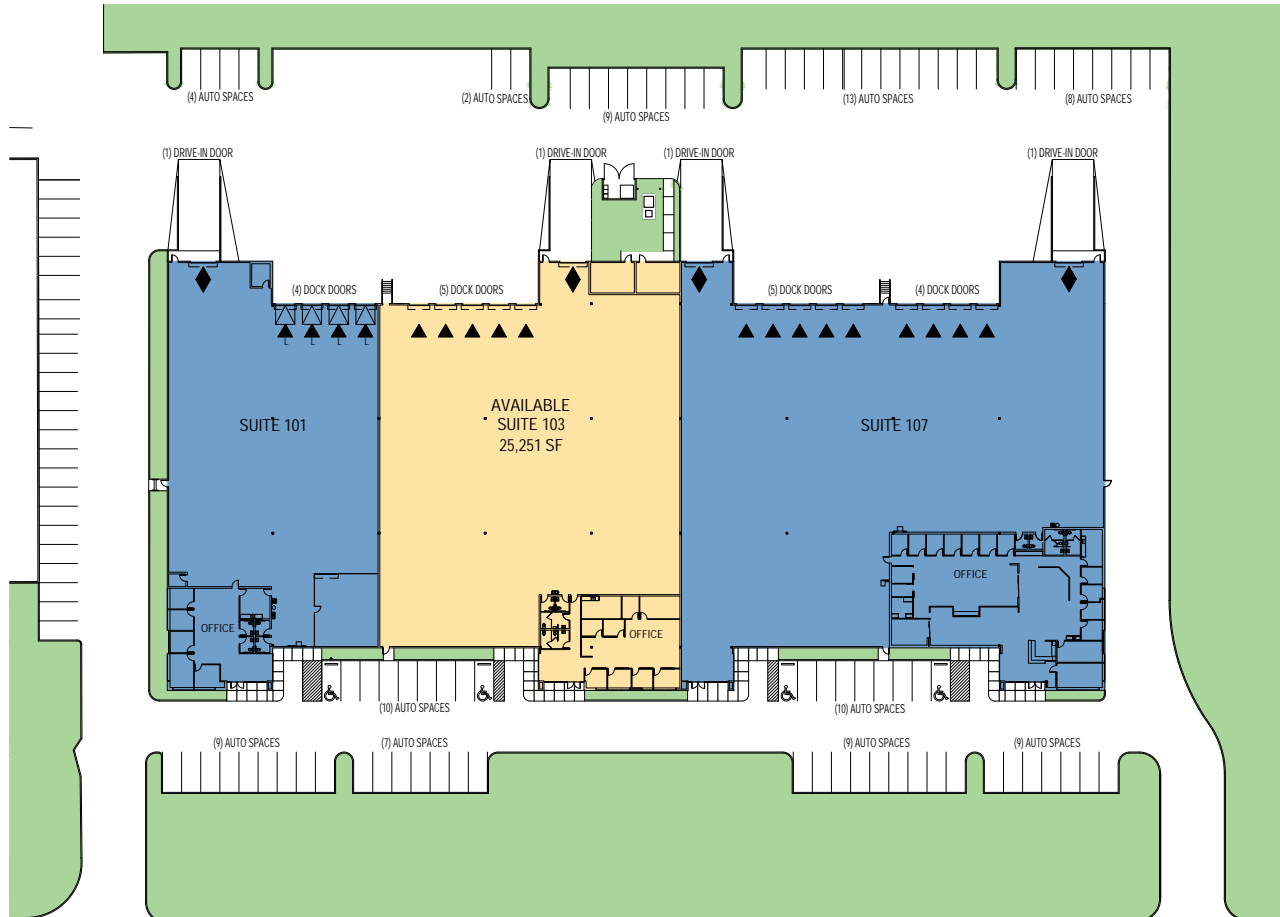

BUILDING OVERALL PLAN



Kidder Mathews

Todd Clarke
todd.clarke@kidder.com
ph +1 253 722 1422
cell +1 253 381 5500
1201 Pacific Ave
Suite 1400
Tacoma, WA 98402 USA

Kidder Mathews

Laura Fox
laura.fox@kidder.com
ph +1 253 722 1441
cell +1 253 686 5888
1201 Pacific Ave
Suite 1400
Tacoma, WA 98402 USA

Kidder Mathews

Ty Clarke
ty.clarke@kidder.com
ph +1 253 722 1419
cell +1 253 720 2211
1201 Pacific Ave
Suite 1400
Tacoma, WA 98402 USA

Kidder Mathews

Hunter Clarke
hunter.clarke@kidder.com
ph +1 253 722 1454
cell +1 253 549 5517
1201 Pacific Ave
Suite 1400
Tacoma, WA 98402 USA

Prologis

Lucca Merlino
lmerlino@prologis.com
ph +1 206 414 7621
cell +1 206 498 6511
33930 Weyerhaeuser Way S
Suite 100
Federal Way, WA 98001 USA