

# OFFICE/MEDICAL SPACE FOR LEASE



*First time ever available for lease*

OFFICE/MEDICAL SPACE

110 W. Cliff Drive  
Spokane, Washington 99204

**ERIK NELSON, MANAGING BROKER**  
509.220.4042 erik.nelson@kiemleahagood.com

**CRAIG SOEHREN, BROKER**  
509.755.7548 craigs@kiemleahagood.com

**KIEMLE  
HAGOOD**

# OVERVIEW & LOCATION

110 W. Cliff Drive  
Spokane, Washington 99204

OFFICE/MEDICAL SPACE  
**FOR LEASE**

## PROPERTY OVERVIEW

Parcel Number	35194.2129
Total Building Size	±70,274 SF
Total Site	±134,329 SF (±3.08 ac)
Year Built	1970 / 2001

## LEASE DETAILS

Total Space Available	±20,788 SF (Suites 410, 420, 430)
Lease Rate	Contact Listing Brokers
NNN Expenses	Contact Listing Brokers



VIEW  
LOCATION



# AVAILABLE SPACE

110 W. Cliff Drive  
Spokane, Washington 99204

OFFICE/MEDICAL SPACE  
FOR LEASE

**4TH FLOOR**

CONTACT LISTING BROKERS FOR LEASE RATES

<u>SUITE #</u>	<u>SIZE</u>
SUITE 410	±5,765 SF
SUITE 420	±5,498 SF
SUITE 430	±9,525 SF

\*SUITES CAN BE COMBINED FOR ±20,788 SF

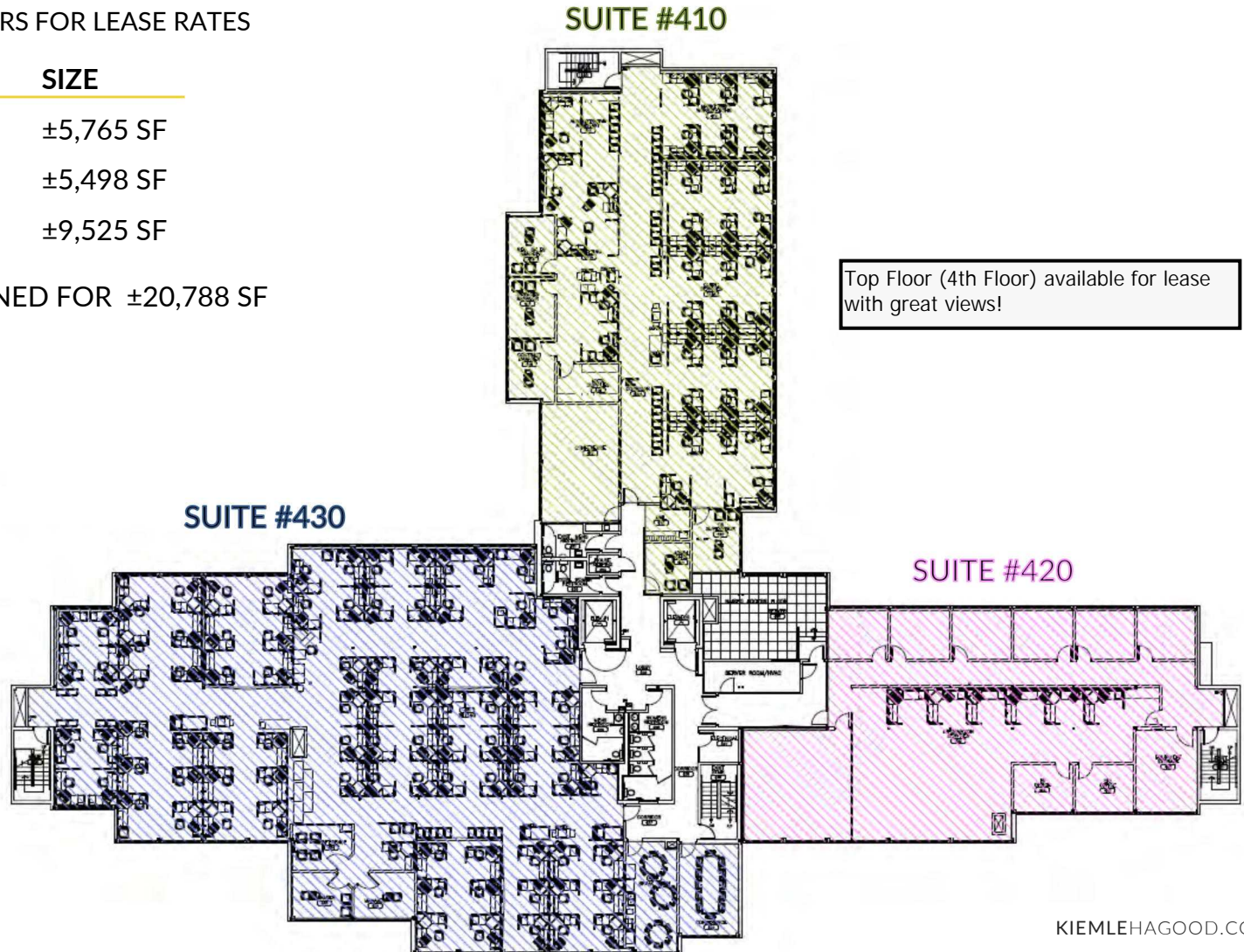

# EXTERIOR COLORS UNDER CONSIDERATION

110 W. Cliff Drive  
Spokane, Washington 99204

OFFICE/MEDICAL SPACE  
**FOR LEASE**

The ownership is working with its architect/designer to select new exterior paint colors. Painting of the building is slated to commence spring of 2025.



# BUILDING SIGNAGE OPPORTUNITIES

110 W. Cliff Drive  
Spokane, Washington 99204

OFFICE/MEDICAL SPACE  
**FOR LEASE**

**4TH FLOOR**

Building signage is available for select tenants depending on lease term, size, and location within the building.



## THE AREA

110 W. Cliff Drive  
Spokane, Washington 99204

OFFICE/MEDICAL OFFICE  
**FOR LEASE**

**110 W. Cliff Dr** has convenient access to Hwy 395 and I-90 and ample parking for clients and patients. The property is located across the street from Providence Sacred Heart Medical Center and Children's Hospital, the largest advanced care medical facility between Seattle and Minneapolis.



# OFFICE/MEDICAL BUILDING SPACE FOR LEASE

110 W. Cliff Drive  
Spokane, Washington 99204

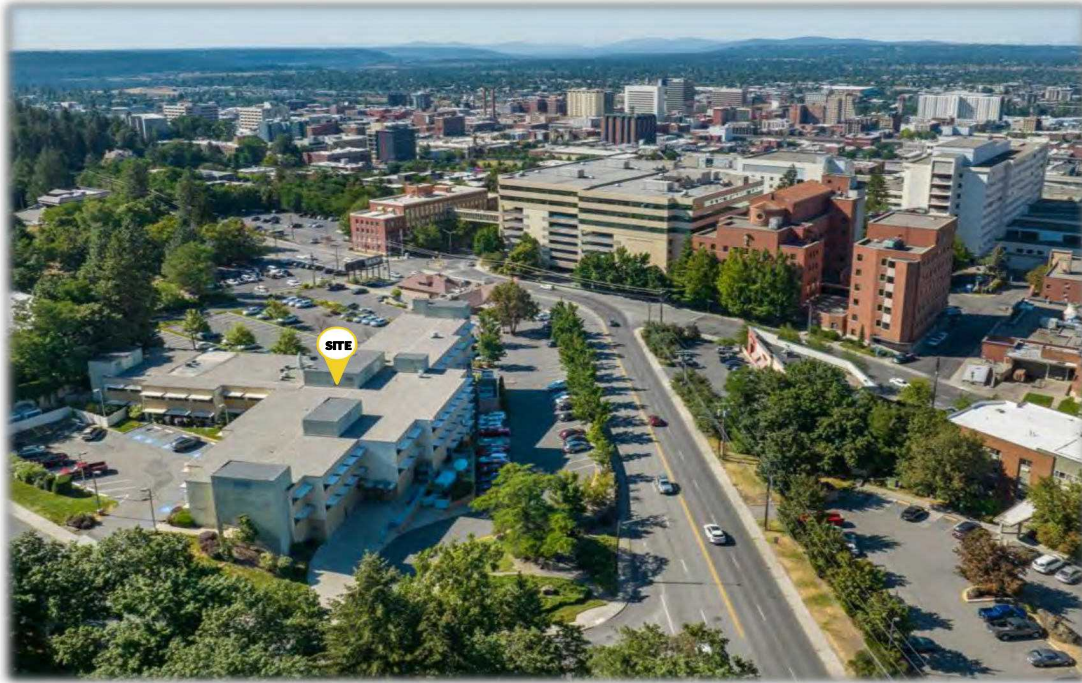

For more information on this opportunity:

**ERIK NELSON, SIOR  
MANAGING BROKER**

509.220.4042

[erik.nelson@kiemlehgagood.com](mailto:erik.nelson@kiemlehgagood.com)

**CRAIG SOEHREN  
BROKER**

509.755.7548

[craigs@kiemlehgagood.com](mailto:craigs@kiemlehgagood.com)

No warranty or representation, expressed or implied, is made by Kiemle Hagood, its agents or its employees as to the accuracy of the information contained herein. All information furnished is from sources deemed reliable and submitted subject to errors, omissions, change of terms and conditions, prior sale, lease or financing, or withdrawal without notice. No one should rely solely on the above information, but instead should conduct their own investigation to independently satisfy themselves.

Kiemle Hagood respects the intellectual property of others:

If you believe the copyright in your work has been violated through this Website, please contact our office for notice of claims of copyright infringement. For your complaint to be valid under the Digital Millennium Copyright Act of 1998 (DMCA), you must provide the following information when providing notice of the claimed copyright infringement: Identify the material on the Website that you believe infringes your work, with enough detail so that we may locate it on the Website; provide your address, telephone number and email address; provide a statement that you have a good faith belief that the disputed use is not authorized by the copyright owner, its agent, or the law; provide a statement that the information in the notification is accurate, and under penalty of perjury, that the complaining party is authorized to act on behalf of owner of an exclusive right that is allegedly infringed; provide your physical or electronic signature. Upon receiving your complaint, Kiemle Hagood will, upon review, remove content that you believe infringes your copyright if the complaint is found valid.

**KIEMLE  
HAGOOD**

