

Industrial Property For Lease



Scannell Supersonic Industrial Center

±125,048 SF For Lease

2200 100th St. SW, Everett WA

 **JLL** SEE A BRIGHTER WAY

PROPERTY FEATURES

- Prime Everett / Seaway Location
- Located 3 blocks from Paine Field Airport
- Convenient Access to Airport Road, SR-526, Pacific Hwy 99, I-5, and I-405
- Zoning is light industrial 2 (LI-2) City of Everett
- Corporate Neighbors include Boeing, ZeroAvia, Majestic Glove, Fluke, Aviation Technical Services, and Helion Energy



BUILDING FEATURES

Building Size:	125,048 SF divisible to 25,000 SF
Height:	32' Clear Height
Signage:	High Image Corporate Identity
Construction:	Quality Concrete Tilt Construction
Dock High:	45 Dock high Doors (9' x 10')
Mechanical Pit Levelers:	15 @ 35k lbs pre-installed
Grade Level:	4 Grade Level Ramp Doors (12' x 14')
Truck Court:	130' Deep Single Loaded Truck Court
Electrical:	2,500 amps of 480/277v 3 Phase Power
Warehouse lighting:	20 fc average
Sprinklers:	ESFR Sprinkler System
Parking:	122 Stalls

Site Plan

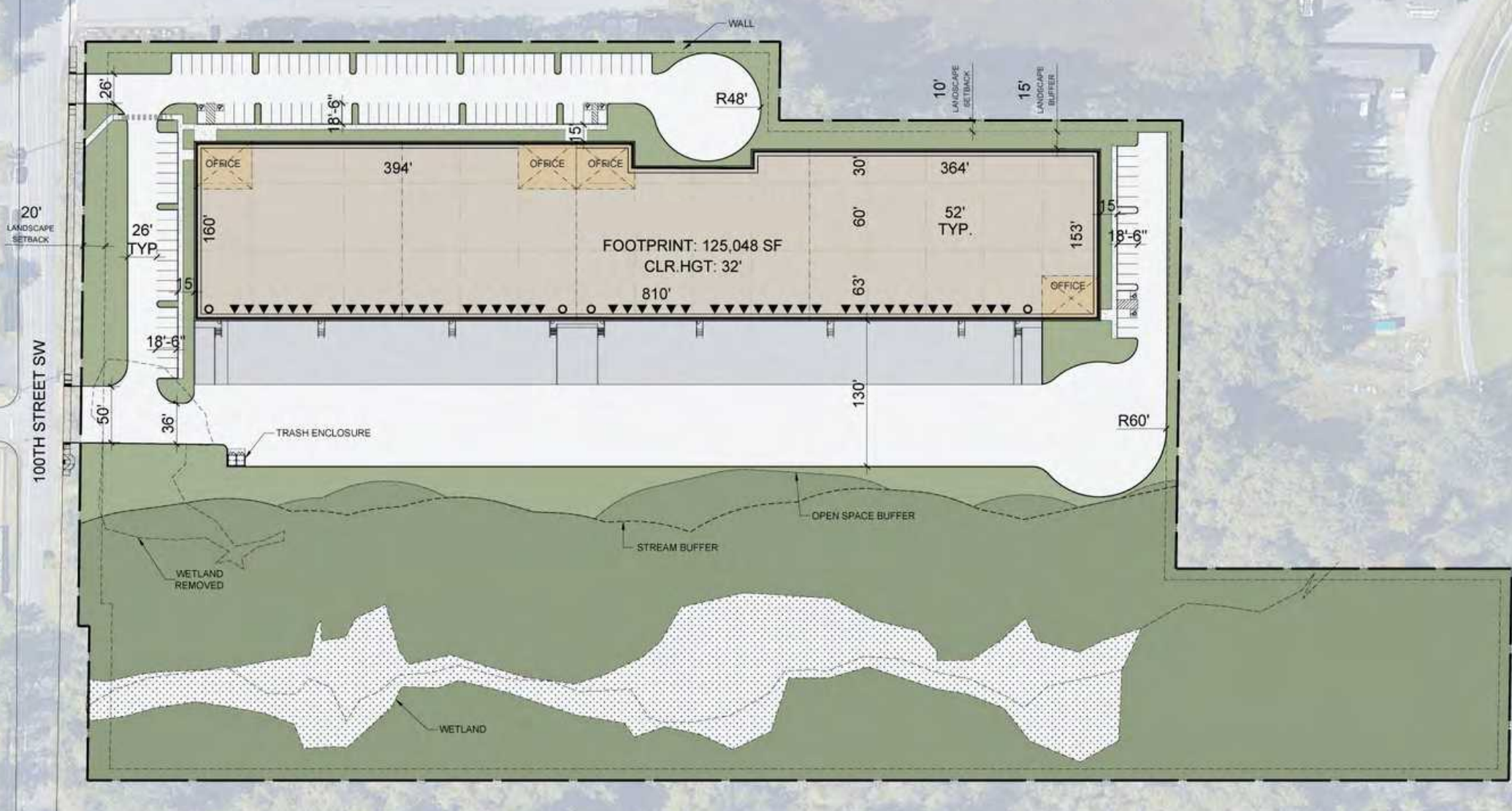

Renderings



Location



FOR MORE INFORMATION

BRENT JACKSON

brent.jackson@jll.com

+1 425 449 2715

GABE SMITH

gabe.smith@jll.com

+1 206 450 0898

MCKENNA HARTMAN

mckenna.hartman@jll.com

+1 206 245 0708

Jones Lang LaSalle Americas, Inc. License #: CO508577000