

FOR LEASE

Owned and Operated by 

Small Bay Industrial Building

9860 40th Ave S, Seattle, WA

16,057 SF

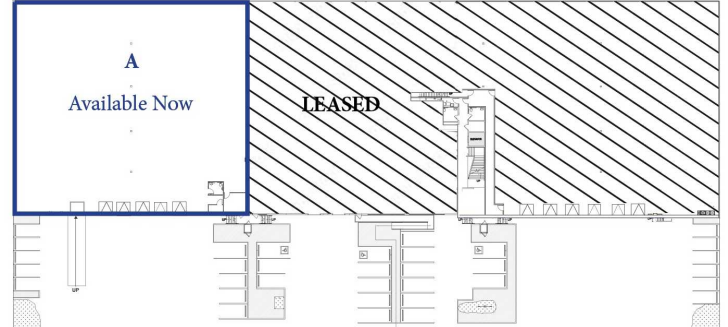
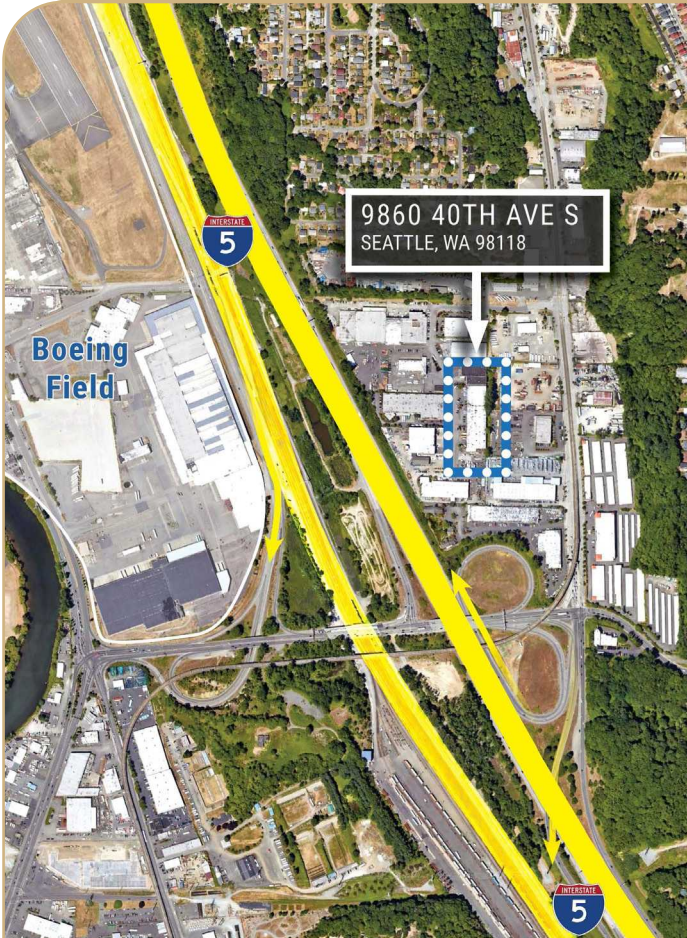

Options:

A: 16,057 SF (342 SF Office) | 5 DH & 1 GL Doors

- Lot Size: 71,090 SF (1.63 Acres)
- Clear Height: 24'
- Auto Parking Stalls: 10 Surface Stalls
- Comments: Stand-alone building with great access to I-5

LEASING INFO
& CONTACT

Thad Mallory, SIOR 425-362-1410 / thad.mallory@nmrk.com
Taylor Hoff, SIOR 425-362-1388 / taylor.hoff@nmrk.com

NEWMARK