

12345 NE 116TH STREET, KIRKLAND WA 98034

SLATER 116

OFFICE/RETAIL FOR LEASE



FOR MORE INFORMATION PLEASE CONTACT:

LAURA MILLER

laura@gibraltarusa.com
206.351.3573

TRACY CORNELL

tracyc@gibraltarusa.com
206.948.0630





SUITE 11



SUITE 11

PROJECT OVERVIEW

- Rare opportunity to lease high-visibility office/retail space in Kirkland's Totem Lake neighborhood
- Located on the ground level of Slater 116, an upscale apartment community with 108 residential units
- Convenient access to I-405
- Join a diverse mix of tenants including Waxing the City, The Art of Coffee, and Covertti



SUITE	AVAILABLE	SIZE	RATE	2024 NNN	
11	Available Now	2,386 SF	\$34/SF	\$10.44/SF	<ul style="list-style-type: none"> • Modern space sits between Building outdoor plaza and customer/residential parking garage. • Features large storefront windows on 3 sides, ensuite ADA restroom, kitchenette, and polished concrete floors • Ideal for fitness, physical therapy, financial services, real estate office, tutoring/education, insurance, or retail • 5 designated parking stalls available for customers/employees at \$110/stall per month
15	February 1, 2025	2,185 SF	\$34/SF	\$10.44/SF	<ul style="list-style-type: none"> • High visibility corner space located at intersection of 124th Ave NE and NE 116th St • Large storefront windows, ensuite ADA restroom, 6 offices, and open retail/lobby/work area • Ideal for med-spa, health/beauty, financial services, education, retail • 3 designated parking stalls available for customers/employees @ \$110/stall per month



SUITE 15

DEMOGRAPHICS

POPULATION	54,461
HOUSEHOLDS	22,416
AVERAGE HH INCOME	\$152,651

* 2024 DEMOGRAPHICS BASED ON A 2-MILE RADIUS



SUITE 11



OUTDOOR PLAZA ADJACENT TO SUITE 11

SUITE 11

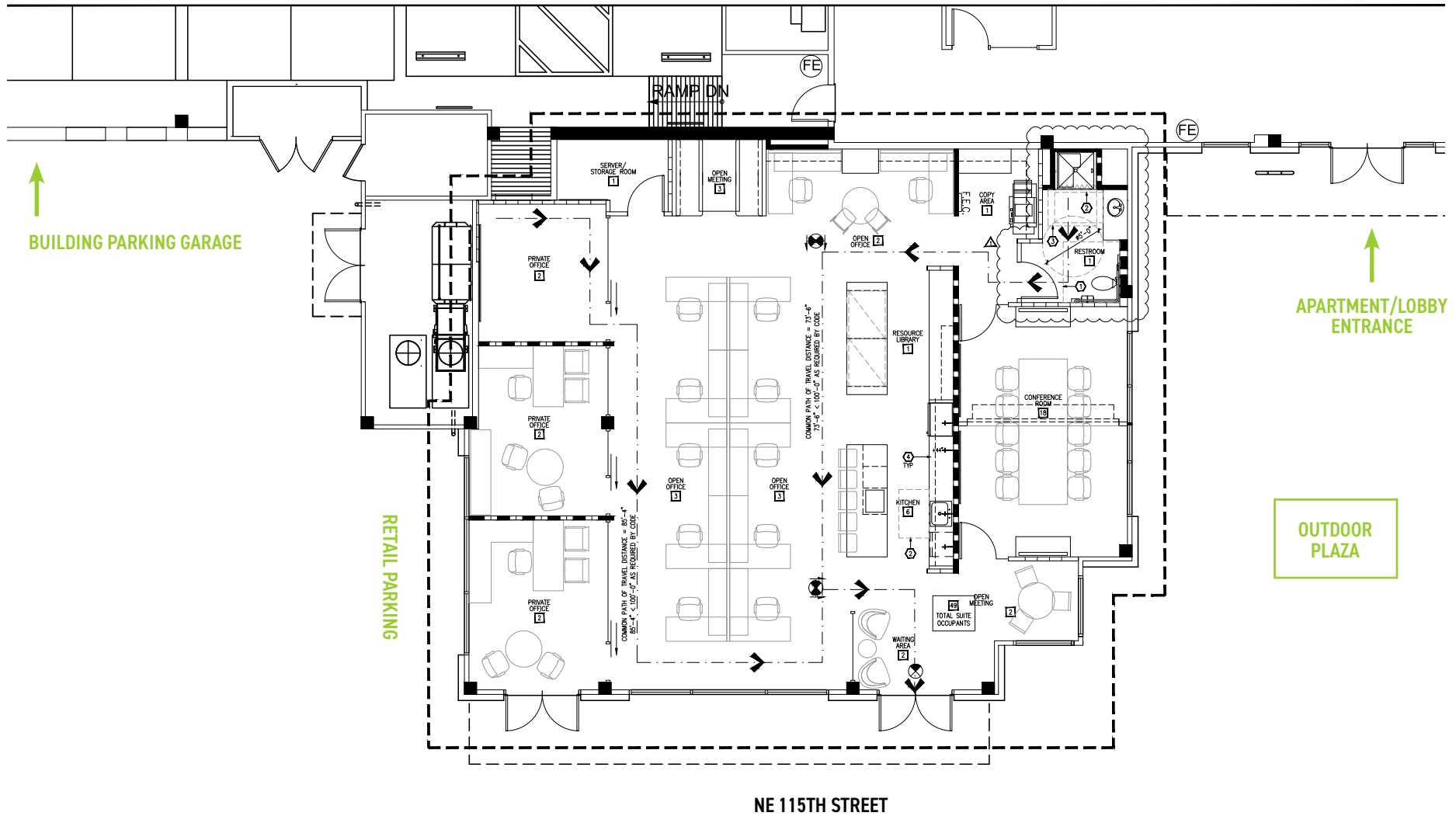

SUITE 15

