

FOR LEASE

*Multiple industrial spaces
with minimal office
available in Monroe*

17404 147TH ST SE
MONROE, WA

ZACH VALL-SPINOSA
425.450.1115
zach.vallspinosa@kidder.com

KIDDER.COM



17404 INDUSTRIAL BLDG



UNIT K DETAILS

| | |
|----------------|-----------------------------|
| UNIT SIZE | 4,108 SF (713 SF Office) |
| LEASE RATE | \$4,410 / Month |
| NNN | \$863 / Month |
| DATE AVAILABLE | 01/01/2025 |
| CLEAR HEIGHT | 18 - 20' |
| POWER | 175 AMPS, 208V, 3-phase |
| LOADING | 1 Grade-Level Loading Doors |

UNIT G DETAILS

| | |
|----------------|-----------------------------|
| UNIT SIZE | 4,108 SF (200 SF Office) |
| LEASE RATE | \$4,000 / Month |
| NNN | \$863 / Month |
| DATE AVAILABLE | 01/01/2025 |
| POWER | 175 AMPS, 208V, 3-phase |
| CLEAR HEIGHT | 18 - 20' |
| LOADING | 2 Grade-Level Loading Doors |



FLOOR PLAN

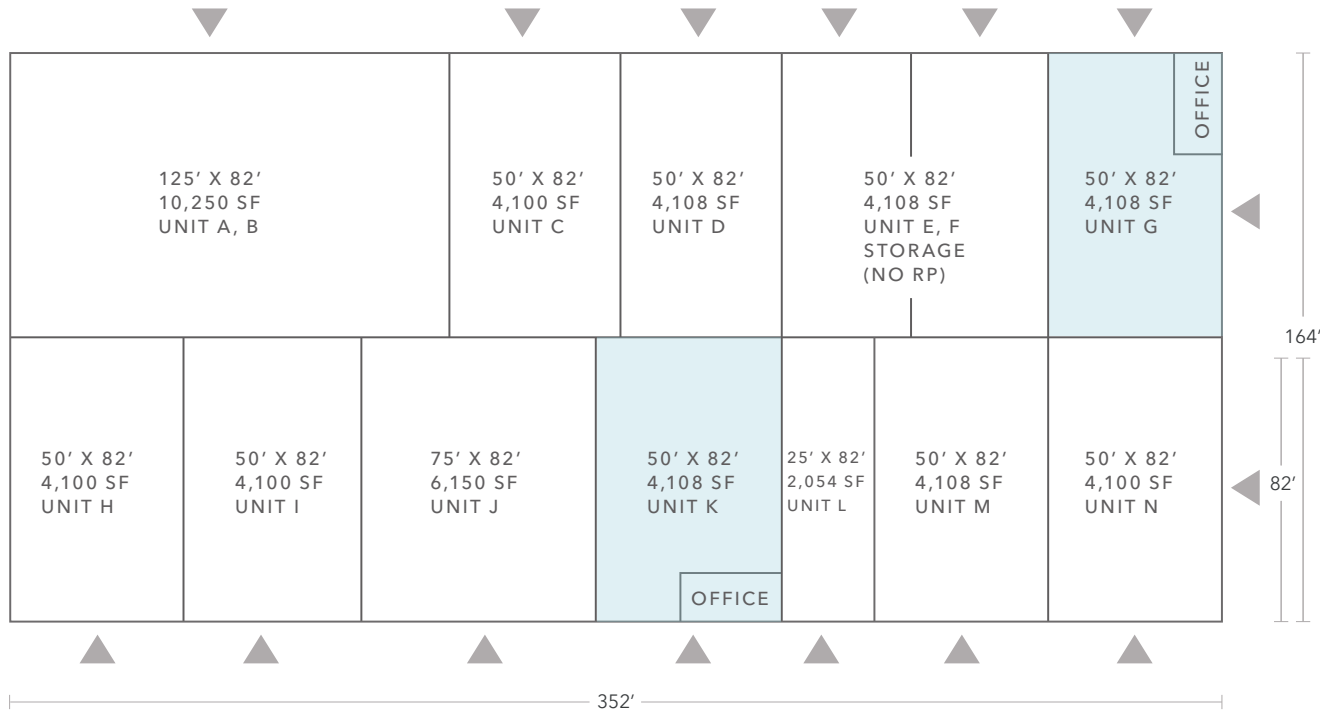

4,108 SF

UNIT K

4,108 SF

UNIT G

01/01/25

AVAILABLE

Exclusively leased by

ZACH VALL-SPINOSA
 425.450.1115
 zach.vallspinosa@kidder.com



▲ Grade-level loading

KIDDER.COM

This information supplied herein is from sources we deem reliable. It is provided without any representation, warranty, or guarantee, expressed or implied as to its accuracy. Prospective Buyer or Tenant should conduct an independent investigation and verification of all matters deemed to be material, including, but not limited to, statements of income and expenses. Consult your attorney, accountant, or other professional advisor. All Kidder Mathews designs are the sole property of Kidder Mathews. Branded materials and layouts are not authorized for use by any other firm or person.

