

FOR SUBLEASE
15,000 SF BUILDING AVAILABLE

4620 95th St SW | Lakewood, WA



NEWMARK

MORGAN RICHEY, SIOR
morgan.richey@nmrk.com
425-362-1409

FOR SUBLEASE

15,000 SF BUILDING AVAILABLE

4620 95th St SW | Lakewood, WA

SITE PLAN

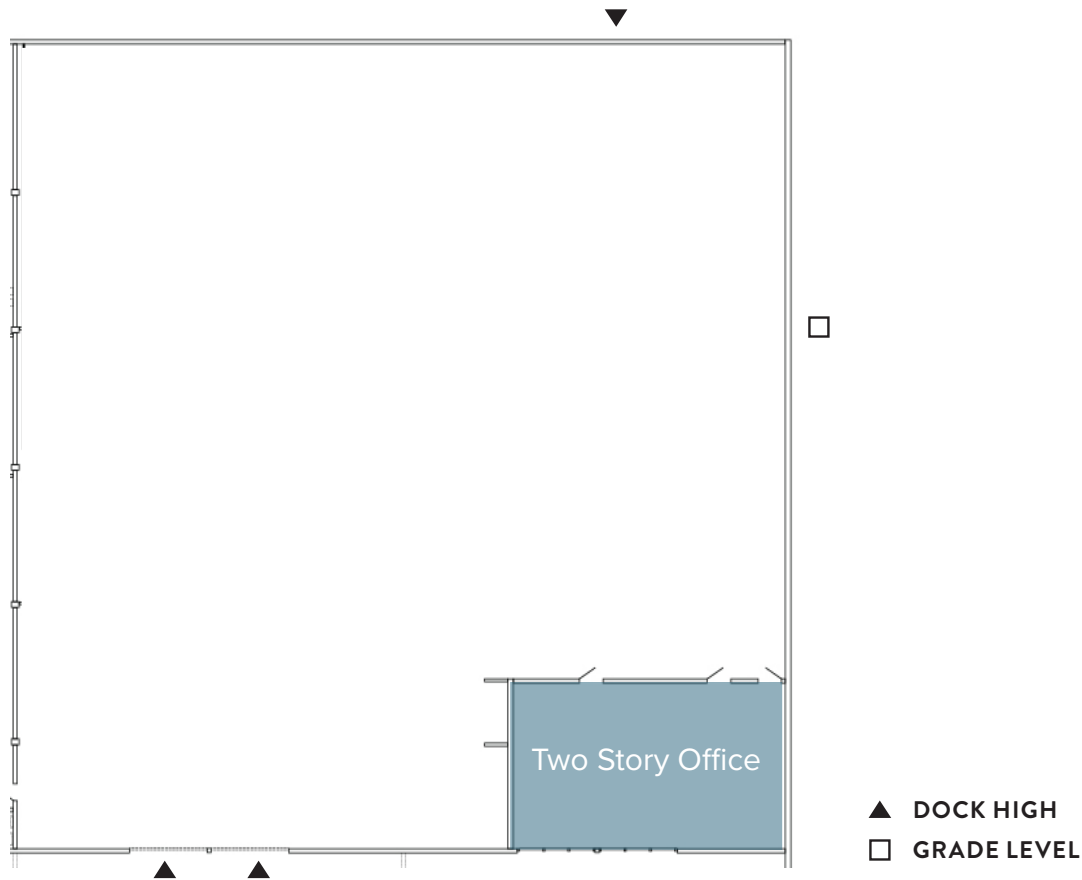

BUILDING DETAILS

BUILDING SF

15,000 SF

OFFICE SF

±2,280 SF Office (two stories)

CLEAR HEIGHT

24'

LOADING

3 Dock High Doors

1 Grade Level Door

PROPERTY HIGHLIGHTS

- Available Immediately
- Master lease through May 31, 2034
- Flexible term options

FOR SUBLEASE
15,000 SF BUILDING AVAILABLE
4620 95th St SW | Lakewood, WA

