

500 SW 16TH STREET RENTON, WA

FOR LEASE | 3.2 ACRES | 13,123 SF (5,115 SF OFFICE)

Capital Improvements Now Complete!

Repaved Yard · New Exterior Lighting · Complete
Office Refresh · New Grade Level Door · New HVAC



NEWMARK

THAD MALLORY, SIOR

thad.mallory@nrmk.com
425-362-1410

CAM WARREN

cam.warren@nrmk.com
425-362-1395

EVAN LUGAR

evan.lugar@nrmk.com
425-362-1403

BUILDING FLOOR PLAN

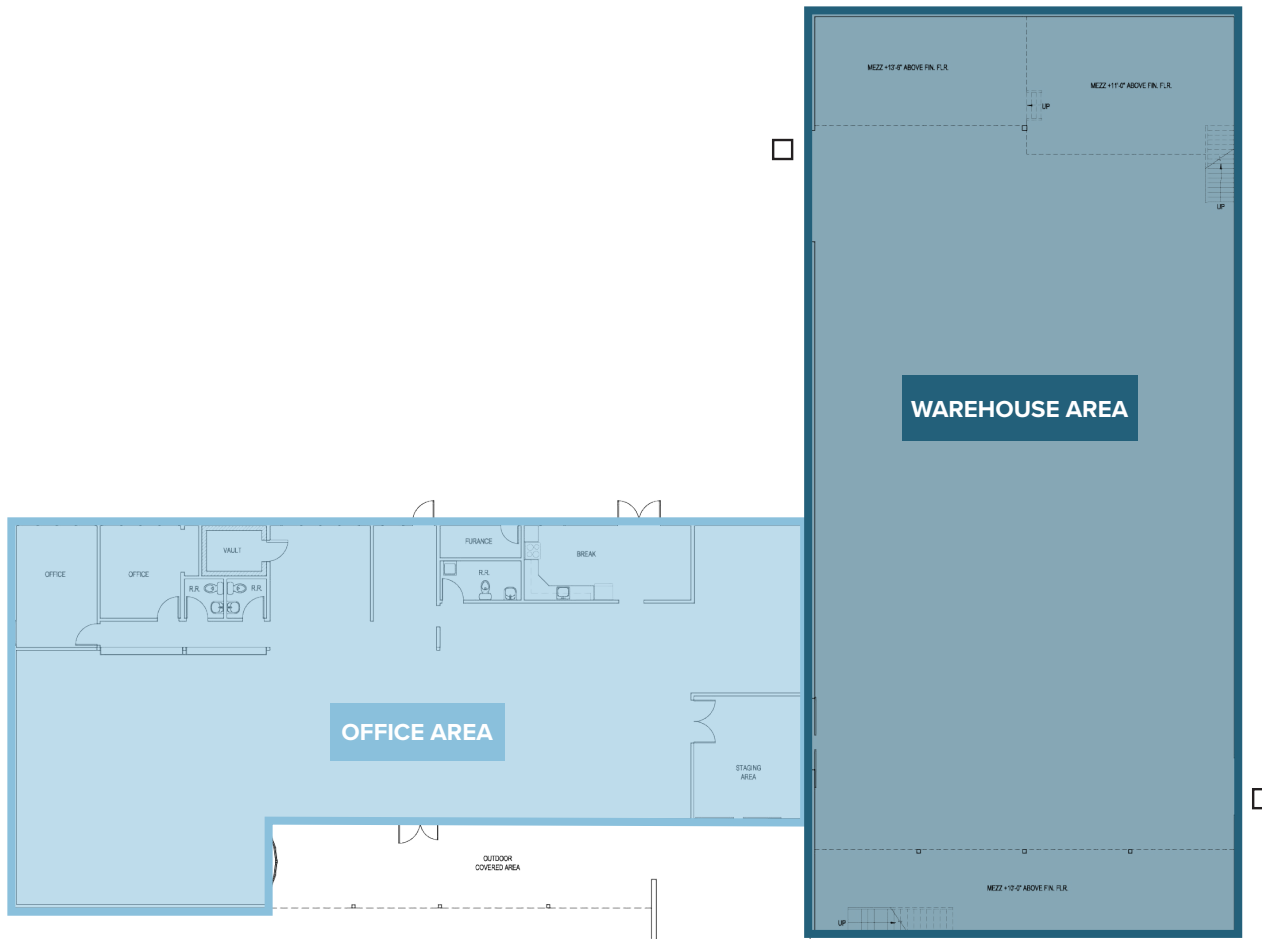

□ GRADE LEVEL

BUILDING DETAILS

ADDRESS

500 SW 16th St
Renton, WA

AVAILABLE SF

13,123 SF

OFFICE SF

5,115 SF

CLEAR HEIGHT

16'

LAND AREA

3.2 AC

CAPITAL IMPROVEMENTS

- LED lighting upgrade
- Paved yard area
- Office refresh (flooring, paint, windows, bathrooms)
- Install 1 grade level door
- New HVAC

PROPERTY HIGHLIGHTS

- Available Now
- Rare Yard Space in Renton
- Kent Valley Location
- Immediate Access & Exposure to I-405
- Capital Improvements Complete
- Rate: \$0.40 per land square foot, plus NNN

500 SW 16TH ST | RENTON, WA

FOR LEASE | 3.2 ACRES | 13,123 SF (5,115 SF OFFICE)



500 SW 16TH ST | RENTON, WA

FOR LEASE | 3.2 ACRES | 13,123 SF (5,115 SF OFFICE)

DRIVE TIMES

Seattle-Tacoma International Airport	5 Miles
Port of Seattle	15 Miles

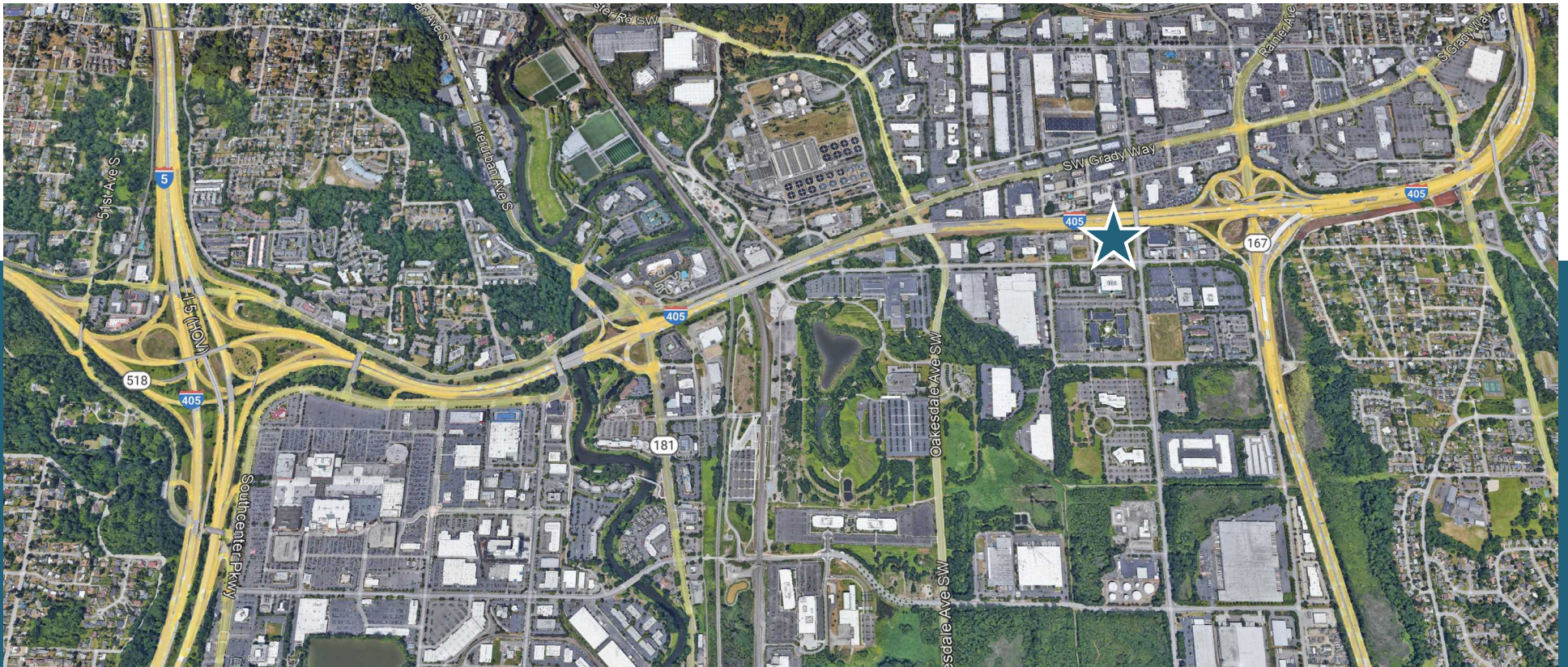

The information contained herein has been obtained from sources deemed reliable but has not been verified and no guarantee, warranty or representation, either express or implied, is made with respect to such information. Terms of sale or lease and availability are subject to change or withdrawal without notice.