



## Retail For Sublease With Options

### **RYAN AMOS**

Senior Associate  
ryan.amos@colliers.com  
+1 (425) 409-4811

### **JEFF KAISER**

Senior Vice President  
jeff.kaiser@colliers.com  
+1 (425) 999-9156

### **COLLIERS**

11225 SE 6th Street  
Suite 240  
Bellevue, WA 98004



# 14215 SE Petrovitsky Road

## Renton, WA 98058

### **Property Highlights**

- Building size: 43,130 SF
- Rental Rate: \$16.00 PSF
- Situated in a busy commercial area of Renton, with high traffic and visibility
- Plenty of parking space for customers and employees
- Shared parking lot with King County Sheriff Substation
- ADA-compliant with easy access for deliveries and loading
- Shadow anchored by Safeway, Rite Aid, and AutoZone
- Additional Retailers Nearby: Walmart, Fred Meyer, Starbucks, McDonald's, and various local businesses, making this area a vibrant retail hub

**Retail For Sublease**

14215 SE Petrovitsky Road | Renton, WA 98058

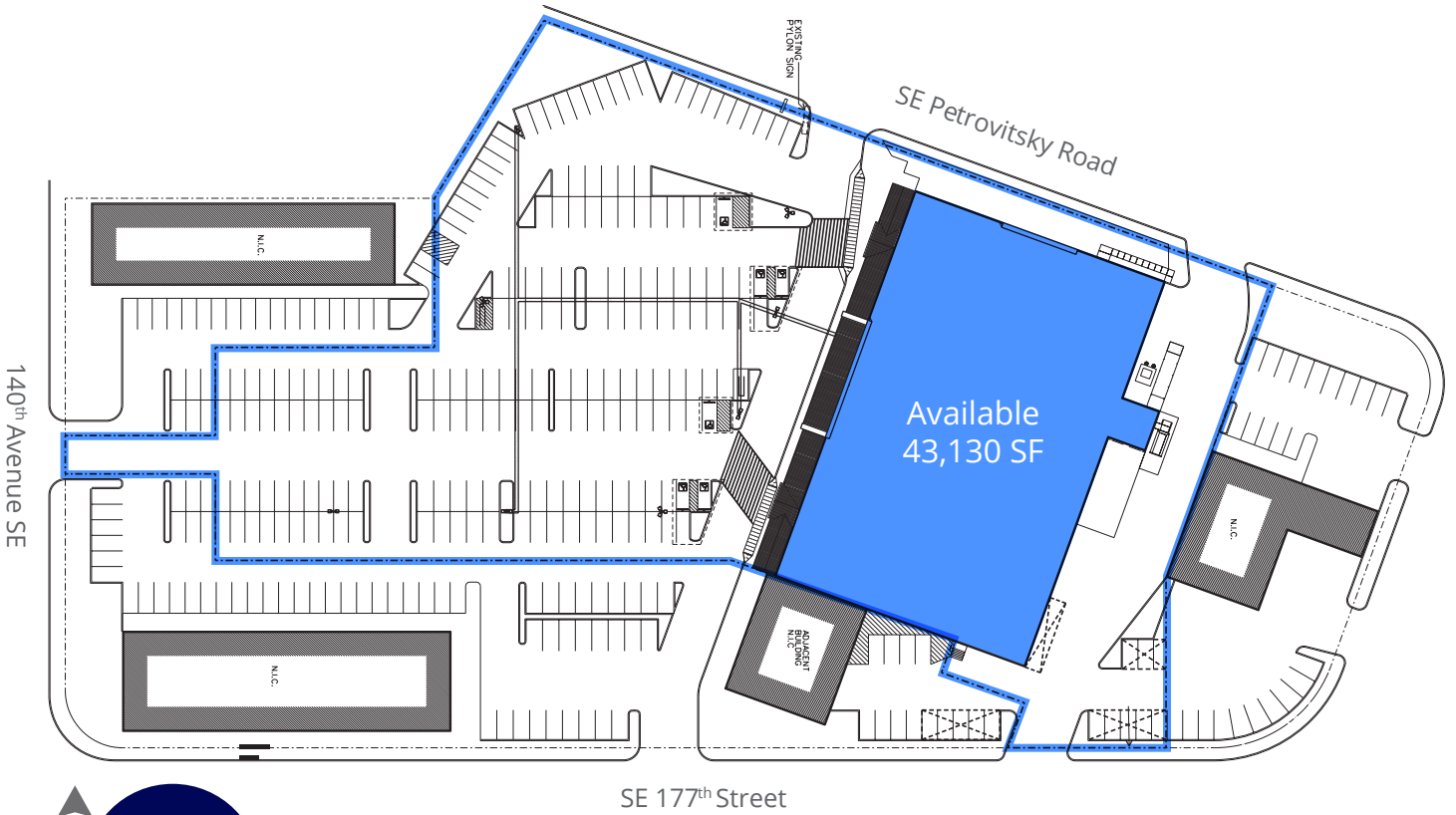

**±50,000**  
Avg. Daily  
Traffic

**±25,000**  
Avg. Daily  
Traffic

**±24,000**  
Avg. Daily  
Traffic





### Demographic

	Total Population	Daytime Population	Businesses	Median HH Income
1 mile	13,035	8,837	188	\$109,757
3 miles	92,595	64,409	1,231	\$110,268
5 miles	207,066	218,316	6,585	\$106,481



**COLLIERS**  
 11225 SE 6th Street  
 Suite 240  
 Bellevue, WA 98004

**RYAN AMOS**  
 Senior Associate  
 ryan.amos@colliers.com  
 +1 (425) 409-4811

**JEFF KAISER**  
 Senior Vice President  
 jeff.kaiser@colliers.com  
 +1 (425) 999-9156

This document has been prepared by Colliers for advertising and general information only. Colliers makes no guarantees, representations or warranties of any kind, express or implied, regarding the information including but not limited to, warranties of content, accuracy and reliability. Any interested party should undertake their own inquiries as to the accuracy of the information. Colliers excludes unequivocally all inferred or implied terms, conditions and warranties arising out of this document and excludes all liability for loss and damages arising therefrom. This publication is the copyrighted property of Colliers and/or its licensor(s). © 2024. All rights reserved.