

# OFFICE FOR LEASE

MAPLE GARDENS OFFICE PARK  
9505 19TH AVE SE | EVERETT, WA 98208



## AVAILABLE IMMEDIATELY:

### • SUITE 100 | 2,754 RSF

- Reception & Waiting Room
- 3 Exam Rooms
- 4 Offices
- X-Ray Room
- Restroom
- Storage and Break Room

### • SUITE 102 | 1,309 RSF

- Open Space

### • SUITE 103 | 695 RSF

- 1 Office
- Reception & Work Area
- Lunch/ Staff Room

**LEASE RATE: \$16.50/RSF, NNN**

*3 Months Free Base Rent on 3-Year Term!*

*Formerly Known as: Terrace East Professional Center*

## PROPERTY FEATURES:

- Good Handicap Access
- Easy Access to I-5 & SR-527
- On Bus Line
- Courtyard & Ample Free Parking
- Retail & Restaurant Amenities
- Easy Access to Everett Mall & Costco



*Exclusively Represented By:*

**Tom Wallin** 

President • Leibsohn Wallin Management

(425) 586-4648 | twallin@leibsohn.com

 **Leibsohn Wallin Management**  
COMMERCIAL REAL ESTATE SERVICES



*The information contained herein has been received from sources we deem reliable. While we have no reason to doubt its accuracy, we do not guarantee it. You are advised to independently verify all information.*

# MAPLE GARDENS OFFICE PARK

9505 19TH AVE SE | EVERETT, WA 98208

# OFFICE FOR LEASE

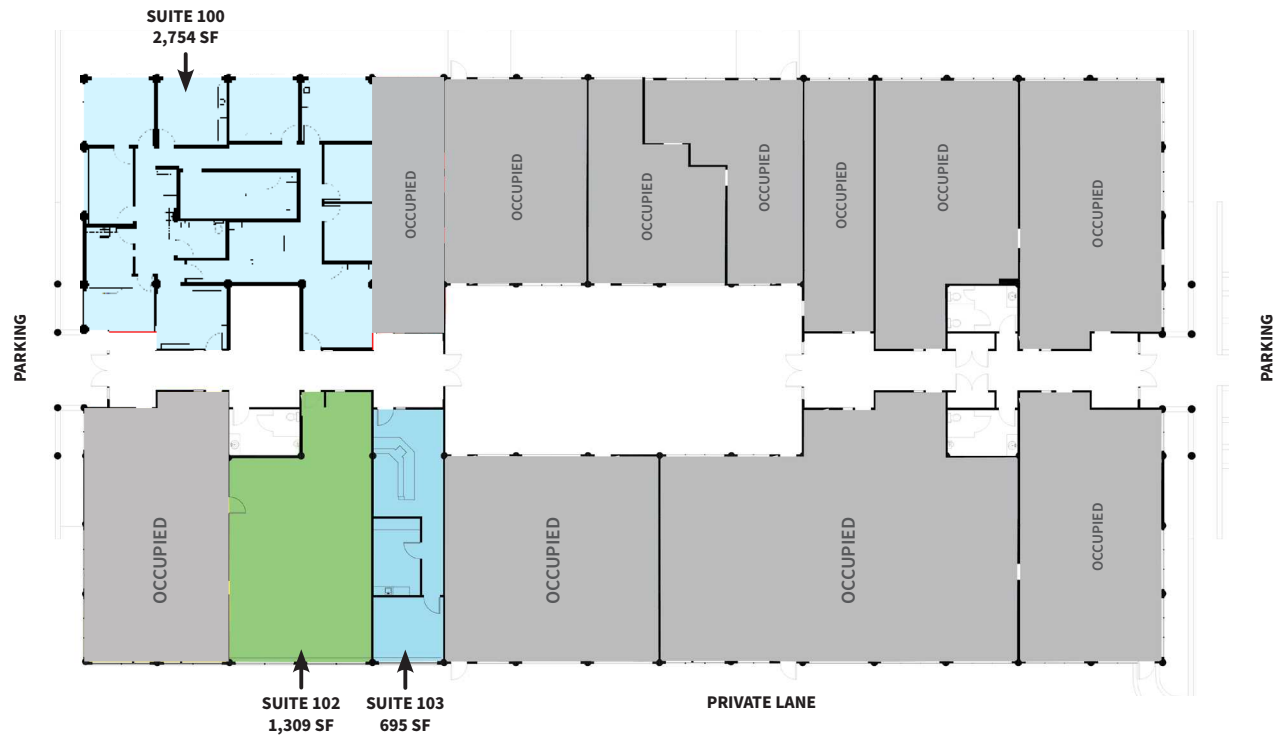

Suite	Size	Lease Rate	Availability
<b>100</b>	2,754 RSF	\$16.50 /RSF NNN	Immediately
<b>102</b>	1,309 RSF	\$16.50 /RSF NNN	Immediately
<b>103</b>	695 RSF	\$16.50 /RSF NNN	Immediately



Exclusively Represented By:

**Tom Wallin** 

President • Leibsohn Wallin Management

(425) 586-4648 | twallin@leibsohn.com

 **Leibsohn Wallin Management**  
COMMERCIAL REAL ESTATE SERVICES



The information contained herein has been received from sources we deem reliable. While we have no reason to doubt its accuracy, we do not guarantee it. You are advised to independently verify all information.