



TOK COMMERCIAL
REAL ESTATE



MILLWORX NORTH YARDS RETAIL | FOR LEASE

909 E 4th Ave | Post Falls | Idaho



HIGHLIGHTS

Part of the 50-acre redevelopment of the Idaho Veneer Millsite.

Considered the eastern most portion of Downtown Post Falls.

Brand new community commercial spaces.

Drive-thru available.

Surrounded by 500+ existing residences.

DETAILS

PROPERTY TYPE

Mixed use with Retail/Office available

BUILDING SIZE

67 apartments+ 8,423SF of commercial space

AVAILABLE

Q1 2025

SUBMARKET

POST FALLS

AVAILABILITY

SUITE	SIZE	RATE
C 100	1,969 SF	\$25.00/SF
C 101	1,988 SF	\$25.00/SF
C 102	1,727 SF	\$25.00/SF



FLOOR PLAN

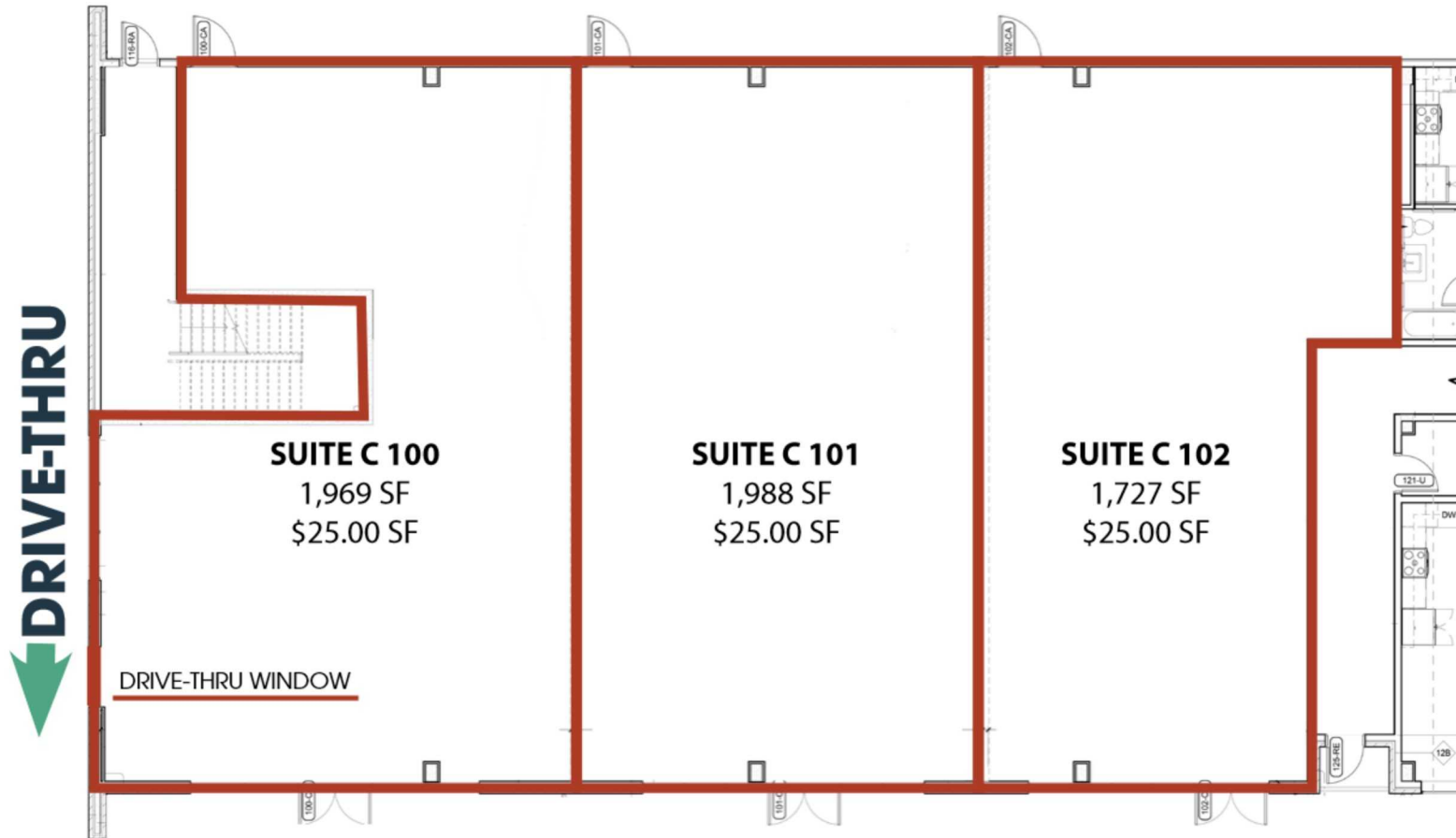

E 4TH AVE



SITE PLAN NORTH YARDS

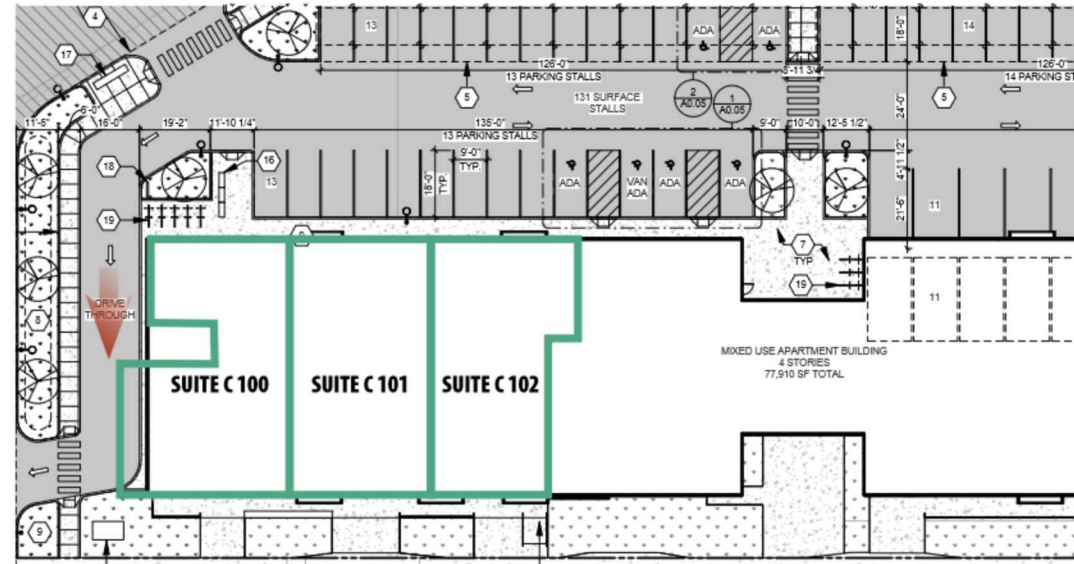

DRIVE-THRU
ENDCAP DESIGNED FOR DRIVE-THRU

SYNERGY
WELL ESTABLISHED COMMUNITY INCLUDING HYATT HOTEL, KINDRED AND COMPANY, AND SHIFT FITNESS.

8,422 SF
OF COMMERCIAL SPACE

67
Apartments

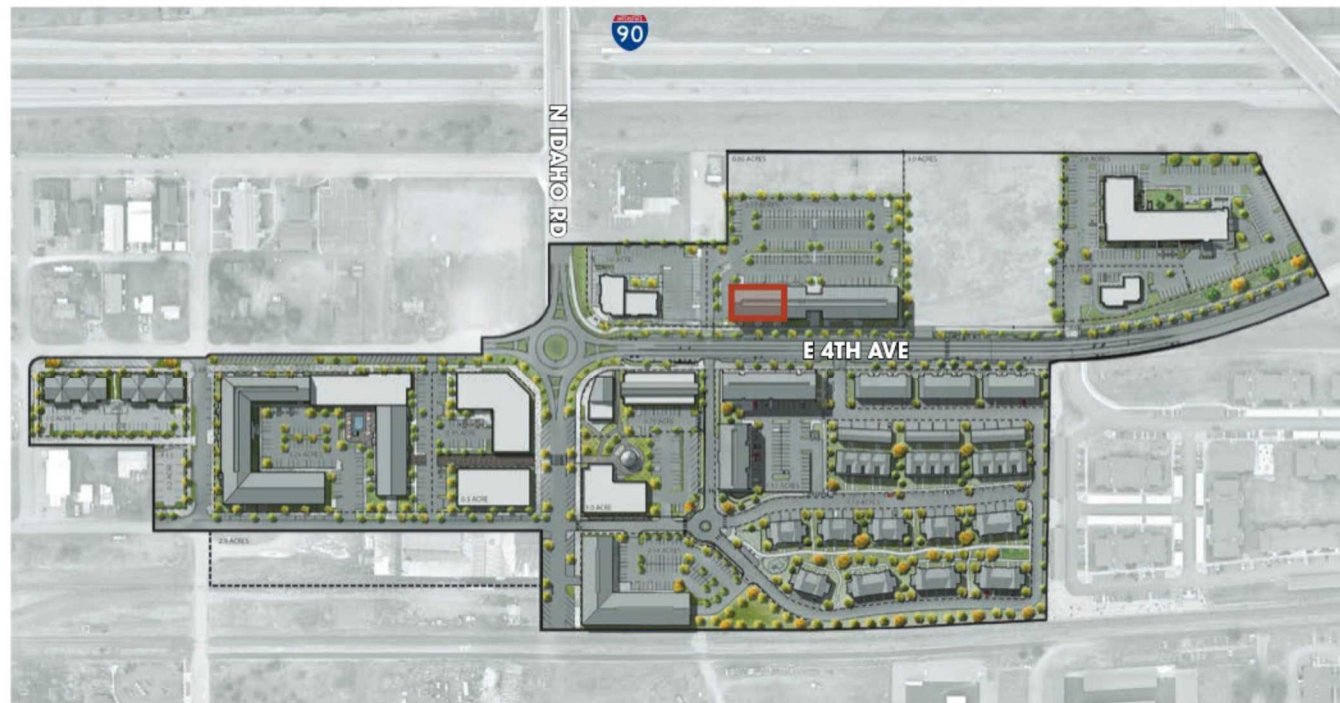



PROJECT RENDERINGS





SELTICE WAY

909 4TH AVE

29,797 VPD



KOOTENAI COUNTY
FIRE STATION

LOT 3
2 ACRES

HYATT

1,406 VPD

E 4TH AVE

KINDRED
& CO

LOT 4
0.987 ACRES

14,891 VPD

MILLSITE REDEVELOPMENT

WOODLAND MEADOWS
330 UNITS



TIMBERWORX
TOWNHOMES AT
MILLWORX