

8,125 SF

## Prologis Park Trans-Pacific 9



3204 20th Street E  
Fife, WA 98424 USA

### LOCATION

- Immediate access to Interstate 5
- Three miles to the Port of Tacoma main gate
- No City of Fife B&O taxes
- Union Pacific Rail Service

### FACILITY

- 8,125 SF shell
- 1,851 SF office
- 3 dock-high doors
- 2 drive-in doors

### ADVANTAGES AND AMENITIES

- Use Prologis Essentials to help with pricing on forklifts and racking for your move-in

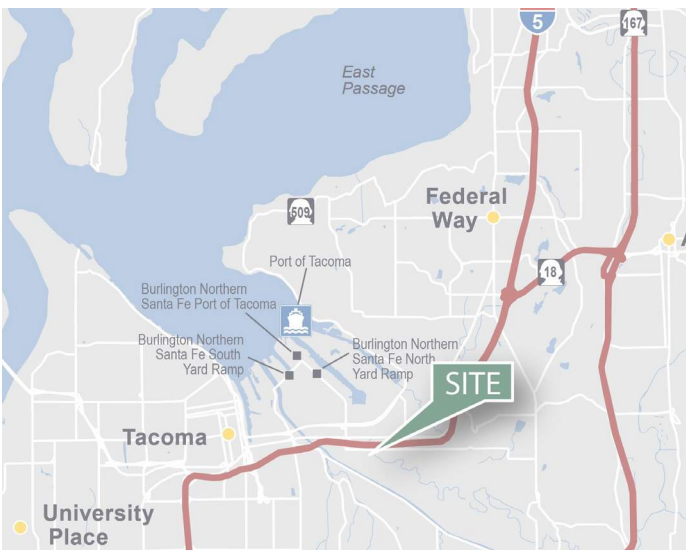

**Prologis Essentials: your single-source service for efficient move-in and operations at [prologisessentials.com](https://www.prologisessentials.com)**

8,125 SF



# Prologis Park Trans-Pacific 9

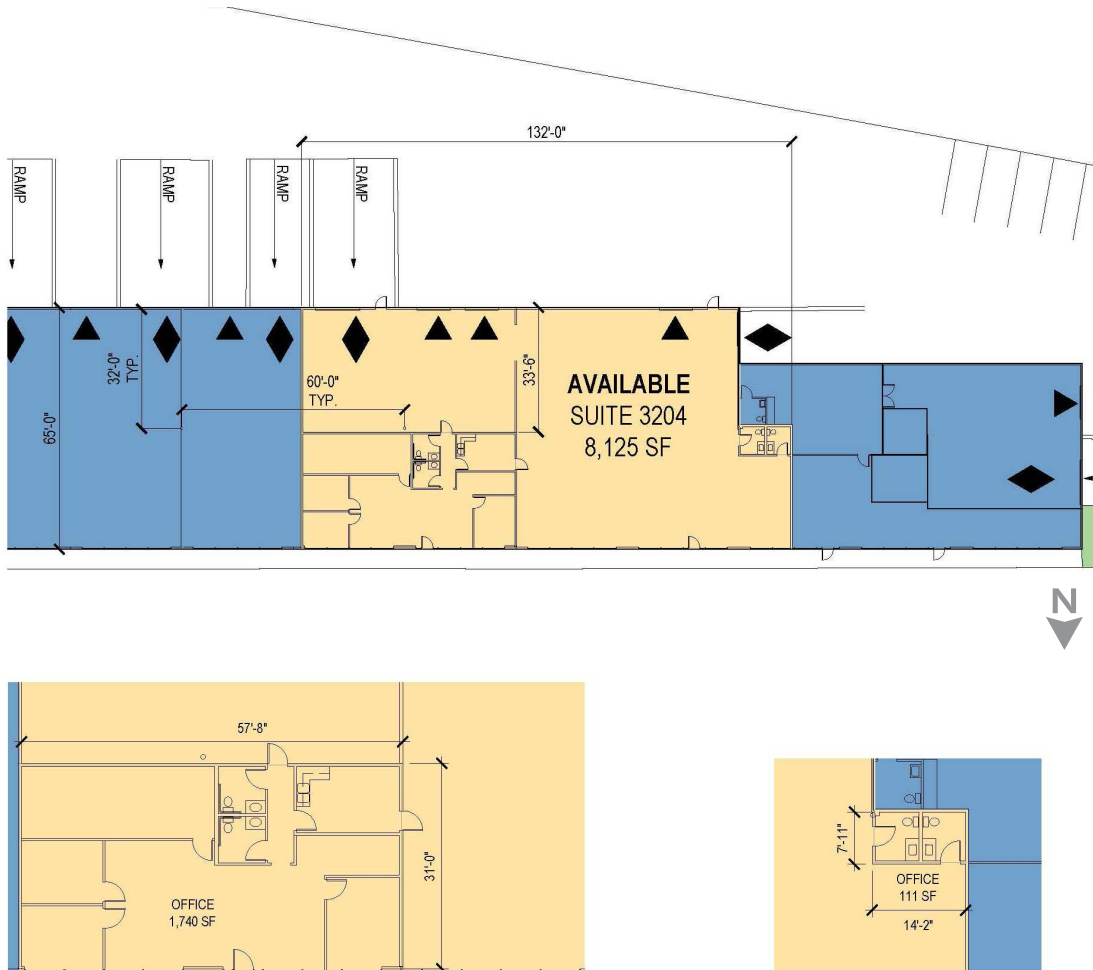

**CBRE, Inc.**

Monte Decker, CCIM  
monte.decker@cbre.com  
ph +1 253 596 0041  
710 Market Street  
Tacoma, WA 98402 USA

**Prologis**

Kimberley Nemethy  
knemethy@prologis.com  
ph +1 206 414 7616  
33930 Weyerhaeuser Way S  
Suite 100  
Federal Way, WA 98001 USA

© 2024 CBRE, Inc. All rights reserved. This information has been obtained from sources believed reliable but has not been verified for accuracy or completeness. You should conduct a careful, independent investigation of the property and verify all information. Any reliance on this information is solely at your own risk. CBRE and the CBRE logo are service marks of CBRE, Inc. All other marks displayed on this document are the property of their respective owners, and the use of such marks does not imply any affiliation with or endorsement of CBRE SD 11.8.24

**Prologis Essentials: your single-source service for efficient move-in and operations at [prologisessentials.com](https://prologisessentials.com)**

No warranty or representation, expressed or implied, is made as to the accuracy of the information contained herein, and same is submitted subject to error and omissions.