

# REDMOND WOODS

5000 - 5020 148TH AVE NE  
REDMOND, WA 98052

---





DESIGNED FOR TODAY'S  
WORK TRENDS





# REDMOND WOODS

**BRODERICK**  
• GROUP •

5000 - 5020 148TH AVE NE  
REDMOND, WA 98052

*Click Play Button to  
view Virtual Tours*

**Redmond Woods** is comprised of **three office buildings** in a campus-like setting in Redmond, Washington. The lot is **7.62 acres** and enjoys excellent access to SR-520.

## BUILDING C

**FULL BLDG** | 53,089 SF  
AVAILABLE 8/1/2027

## BUILDING B

**STE 100** | 21,206 SF  
AVAILABLE 12/1/2027

**STE 200** | 21,206 SF  
AVAILABLE 7/1/2025

## BUILDING A

▶ **STE 100** | 10,962 SF

▶ **STE 150** | 13,872 SF

▶ **STE 200** | 26,299 SF

Rare Opportunity  
for **Single Tenant  
Building of 51,133 SF**  
Available 7/1/2025

Click Play Button to view Virtual Tours

## BUILDING A FLOOR 1

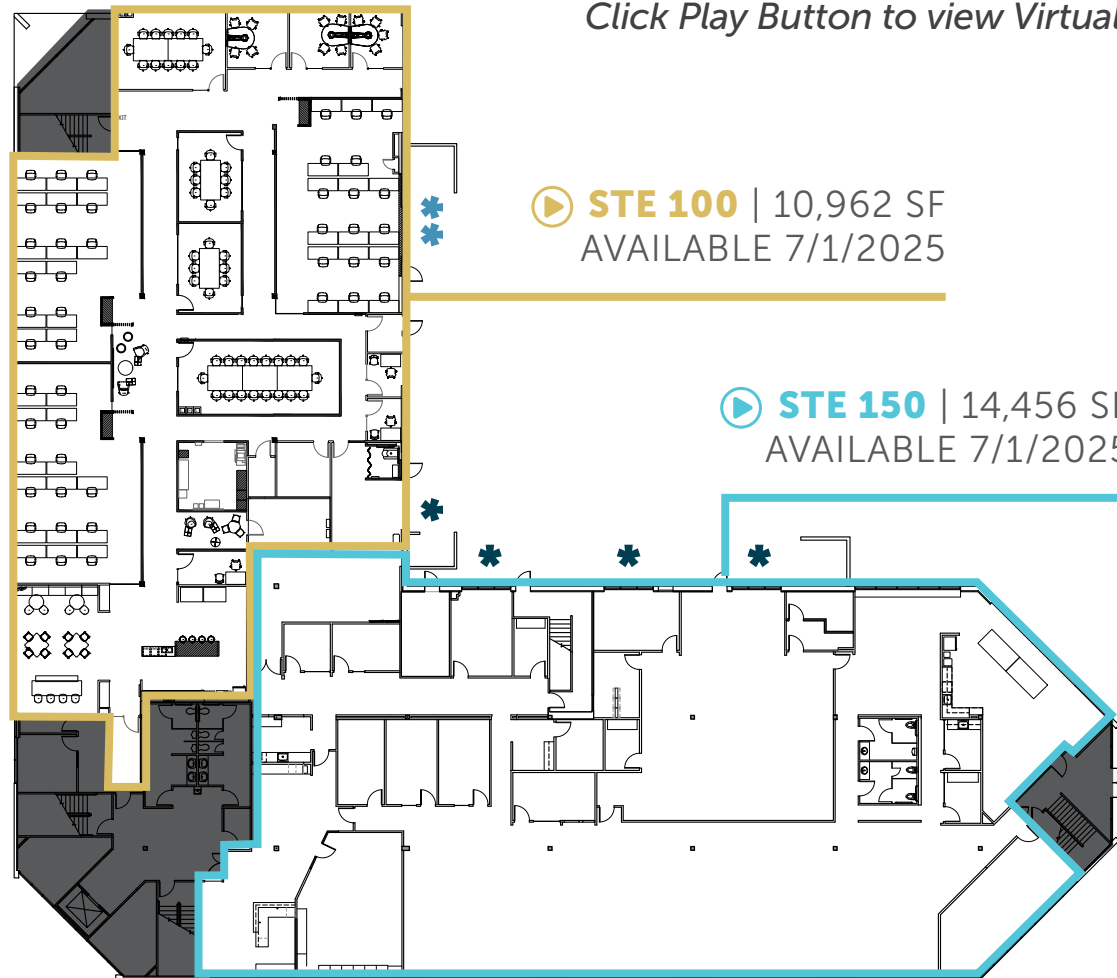

▶ **STE 100** | 10,962 SF  
AVAILABLE 7/1/2025

▶ **STE 150** | 14,456 SF  
AVAILABLE 7/1/2025





Click Play Button to view Virtual Tours

## BUILDING A FLOOR 2

 **STE 200** | 26,229 SF  
AVAILABLE 7/1/2025

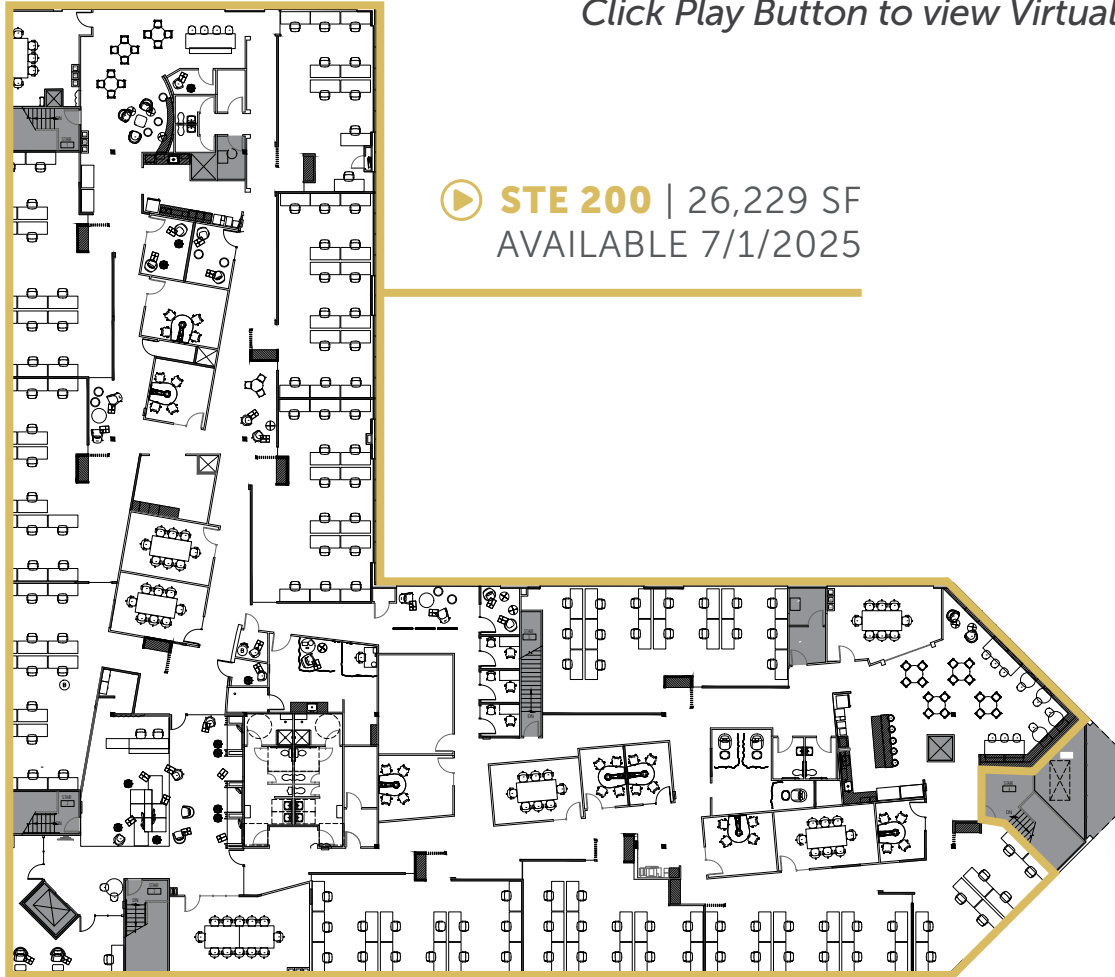



Click Play Button to view Virtual Tours

## BUILDING B FLOOR 2

▶ **STE 200** | 21,206 SF  
AVAILABLE 7/1/2025

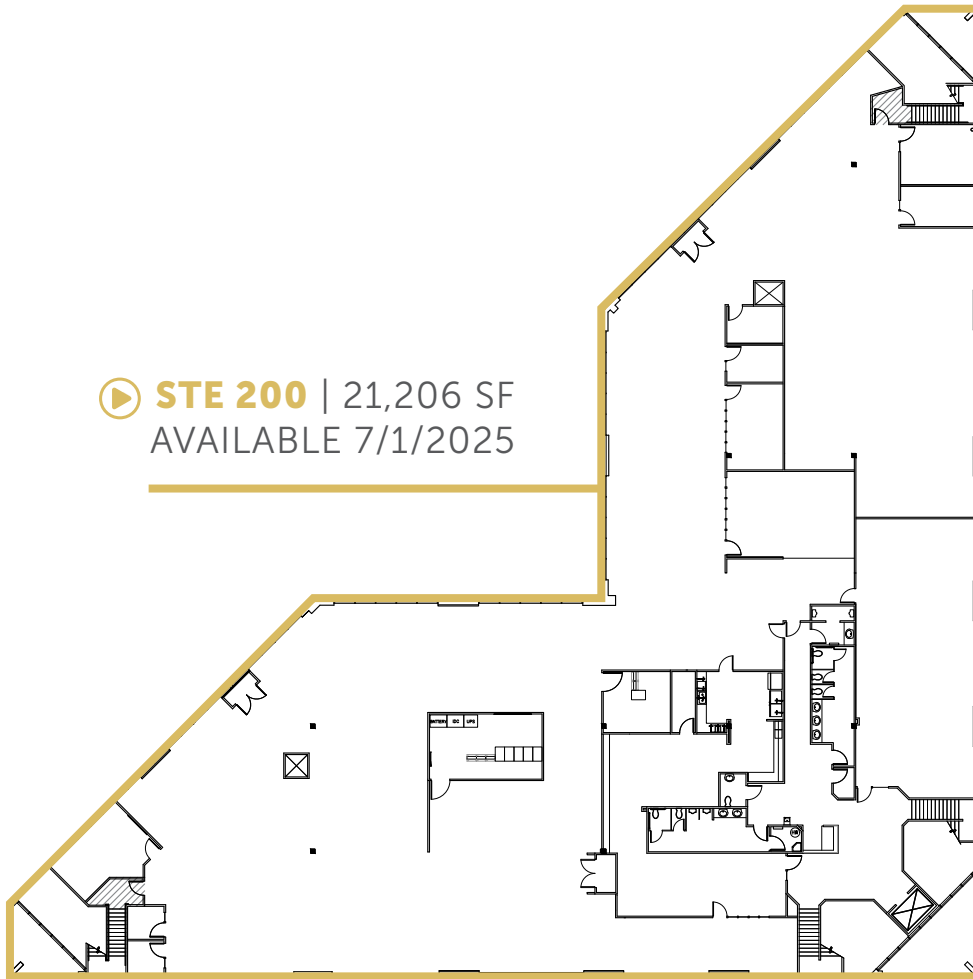

# REDMOND WOODS

5000 - 5020 148TH AVE NE | REDMOND, WA 98052

## STACKING PLANS

### BUILDING B

41,828 RSF



### BUILDING C

53,089 RSF

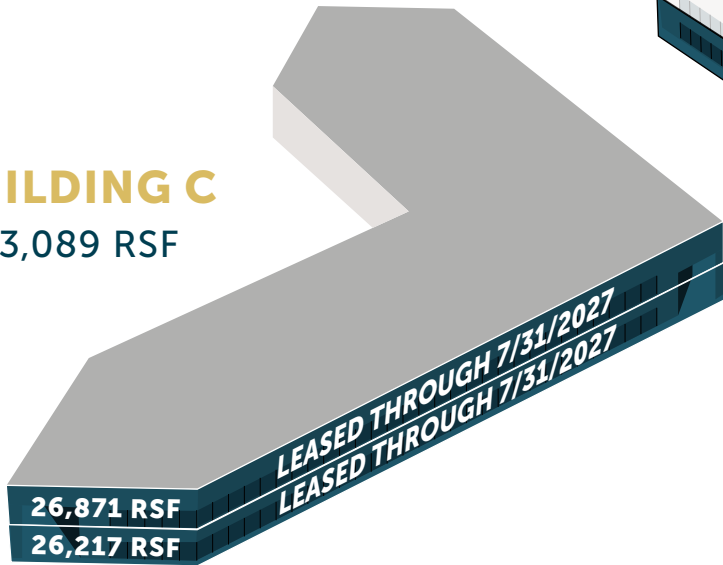

### BUILDING A

51,133 RSF

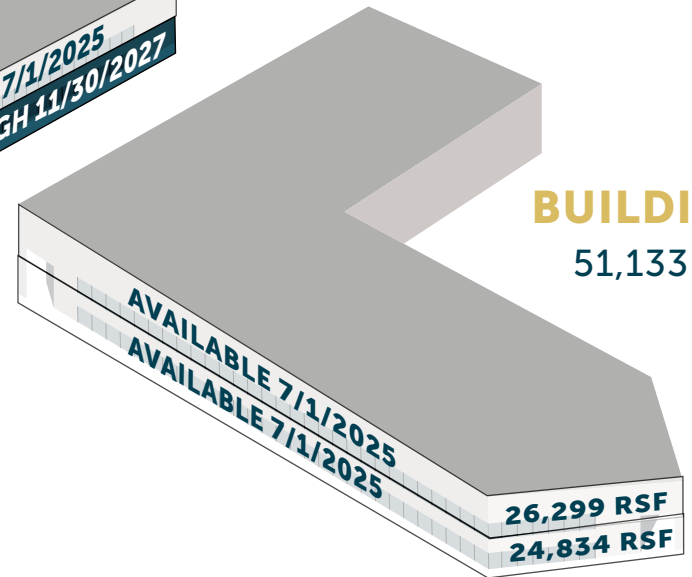

<b>CAMPUS SIZE:</b>	146,048 RSF per 2017 BOMA Standard Building A: 51,133 RSF Building B: 41,828 RSF Building C: 53,089 RSF
<b>2024 ESTIMATED OPERATING EXPENSES:</b>	\$9.03/RSF
<b>PARKING:</b>	3.36 stalls per 1,000 RSF (491 total stalls) Building A includes 25 covered parking stalls
<b>UTILITIES:</b>	Telecom: Ziplly (phone, cable, fiber)
<b>YEAR BUILT:</b>	1982
<b>FLOOR-TO-FLOOR HEIGHT:</b>	12'6"
<b>CEILING HEIGHT:</b>	11'10" on first floors and 11'3" on second floors.
<b>AMENITIES:</b>	Food truck service. Bike racks. Showers and locker rooms. Walking & biking trail system runs along the north perimeter property line. Across the street from Pro Club Bellevue.

