



**FOR LEASE**

# West Valley @ 212th, Bldg T

21019 - 68th Avenue S, Kent, WA

*High image business park located in the heart of the industrial center of Kent Valley.*

## PROPERTY HIGHLIGHTS

- + Free-standing building with lots of parking
- + 24' clear height
- + 2,638 SF Unfinished Structured Mezzanine
- + Heavy, highly upgraded power
- + Fully insulated warehouse
- + Lease rates:
  - \$1.20, NNN - shell
  - \$1.35, NNN - office
- + Available May 1st, 2025

### HANS SWENSON

Partner  
+1 425 586 5630  
hswenson@nai-ppsp.com

### JEFF FORSBERG, CCIM

Principal  
+1 425 586 5610  
jforsberg@nai-ppsp.com



THE INFORMATION CONTAINED HEREIN HAS BEEN GIVEN TO US BY THE OWNER OF THE PROPERTY OR OTHER SOURCES WE DEEM RELIABLE, WE HAVE NO REASON TO DOUBT ITS ACCURACY, BUT WE DO NOT GUARANTEE IT. ALL INFORMATION SHOULD BE VERIFIED PRIOR TO PURCHASE OR LEASE.

AVAILABLE SF

**19,629 SF**

OFFICE SF

**2,638 SF**

LOADING

**3 DH, 2 GL**

YEAR BUILT

**2006**

[nai-ppsp.com](http://nai-ppsp.com)

# Floor Plan

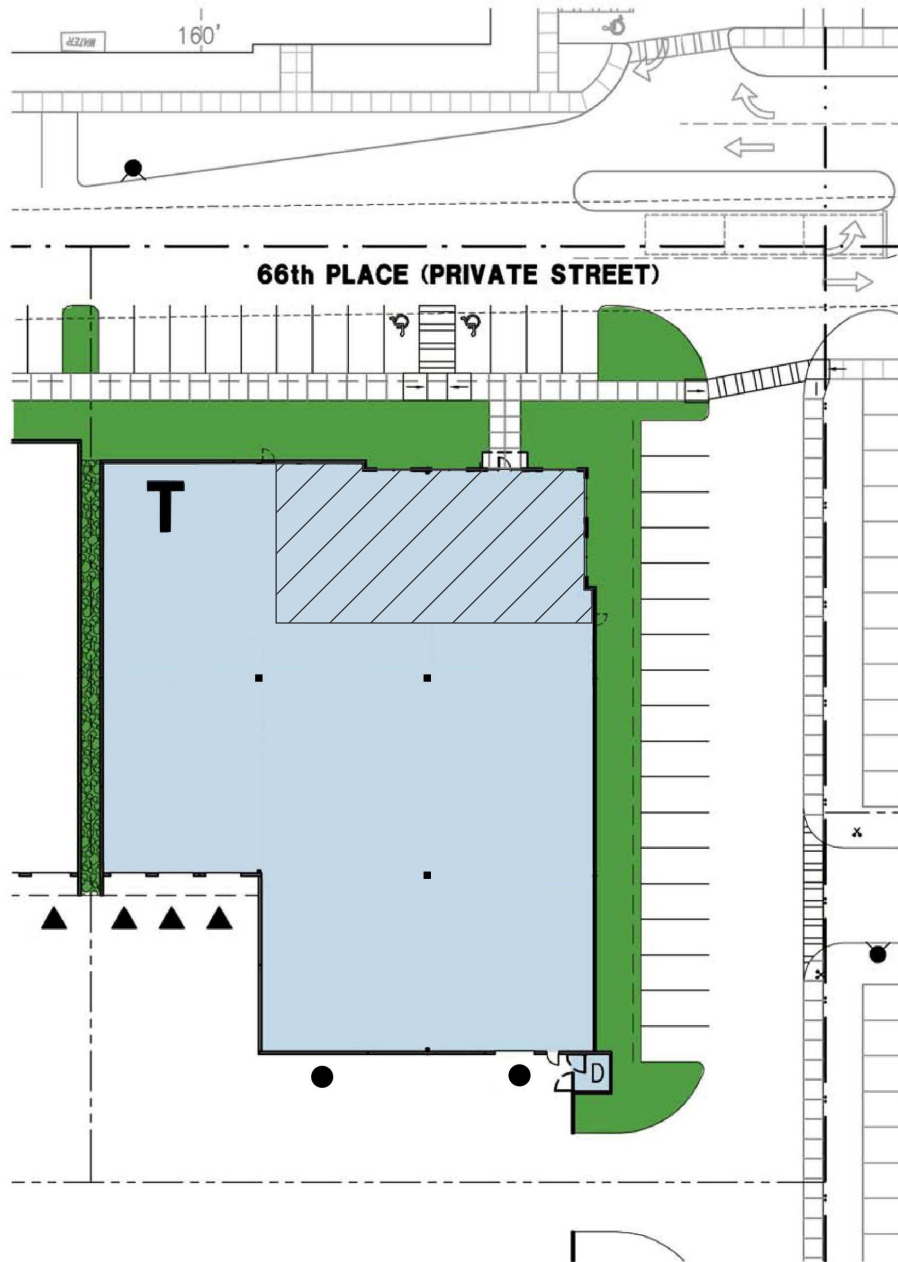

Site Plan



08/04/05

**HANS SWENSON**

Partner

+1 425 586 5630

hswenson@nai-psp.com

**JEFF FORSBERG, CCIM**

Principal

+1 425 586 5610

jforsberg@nai-psp.com

