

FOR LEASE

11020 EAST MARGINAL WAY S, TUKWILA



Approximately 12,680 SF total

1,080 SF office

10 grade-level doors

Great exposure along East Marginal Way S

Illuminated signage available

Approximately 11,000 SF paved and fenced yard

Great shop/repair/dispatch area

Freestanding building

Available October 1, 2025 and possibly sooner with 60 days notice

Interior wash area with oil/water separator

Please call for pricing

DOUG KLEIN, SIOR
206.248.7348
doug.klein@kidder.com

KIDDER.COM

This information supplied herein is from sources we deem reliable. It is provided without any representation, warranty, or guarantee, expressed or implied as to its accuracy. Prospective Buyer or Tenant should conduct an independent investigation and verification of all matters deemed to be material, including, but not limited to, statements of income and expenses. Consult your attorney, accountant, or other professional advisor.



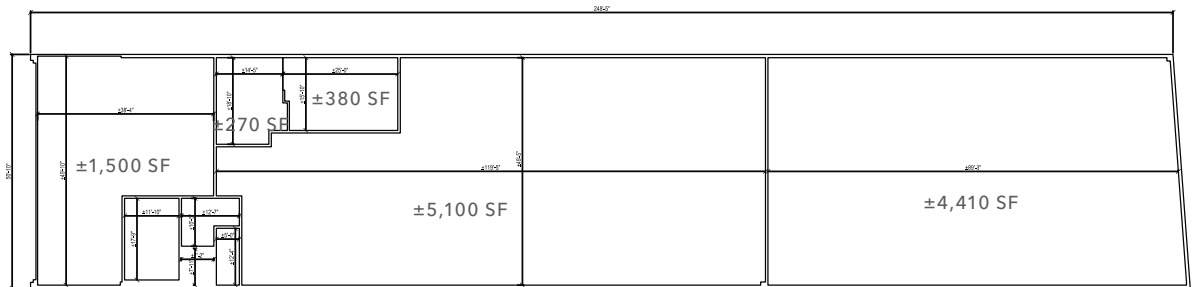
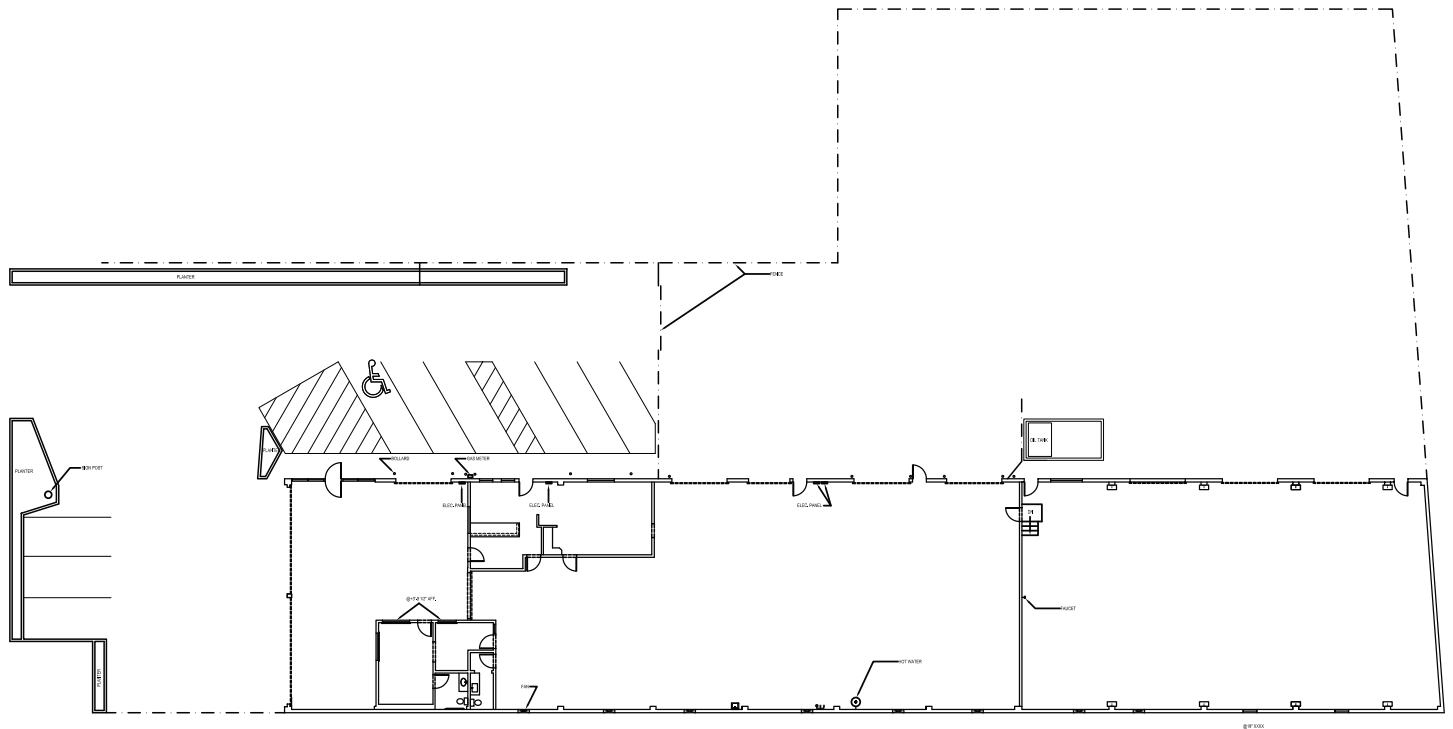

DOUG KLEIN, SIOR
206.248.7348
doug.klein@kidder.com

KIDDER.COM

This information supplied herein is from sources we deem reliable. It is provided without any representation, warranty, or guarantee, expressed or implied as to its accuracy. Prospective Buyer or Tenant should conduct an independent investigation and verification of all matters deemed to be material, including, but not limited to, statements of income and expenses. Consult your attorney, accountant, or other professional advisor.



