

# PARK 25 - BUILDING C

FOR LEASE - 3,280 SF

11102 25TH AVE E | TACOMA, WA 98445

## INDUSTRIAL SPACE AVAILABLE



### LEASE INFORMATION

SUITE	TOTAL SIZE	OFFICE SIZE	LOADING	RESTROOMS	AVAILABLE	LEASE RATE
B	3,280 SF	178 SF	1 GL Door	1	Now	Call Broker

### PROPERTY HIGHLIGHTS

- Quality construction
- Grade-level loading
- 18' Clear Height
- Sprinklered
- Ample parking
- Great access to Hwy-512



**NICK RATZKE, SIOR**  
 253.779.2414  
 nratzke@neilwalter.com

**BRIANA HICKEY**  
 253.779.2424  
 bhickey@neilwalter.com



All information references in this document are approximate. The information contained herein is contained from sources deemed reliable. It is provided without representation, warranty, or guarantee, expressed or implied as to accuracy. Prospective buyer or tenant should conduct its own independent investigation relating to the property, government codes and regulations, allowed uses, and all other matters, regardless of whether they are referred to or contained in this document.

# PARK 25 - BUILDING C

11102 25TH AVE E | TACOMA, WA 98445



SUITE	TOTAL SIZE	OFFICE SIZE	LOADING	RESTROOMS	AVAILABLE	LEASE RATE
B	3,280 SF	178 SF	1 GL Door	1	Now	Call Broker

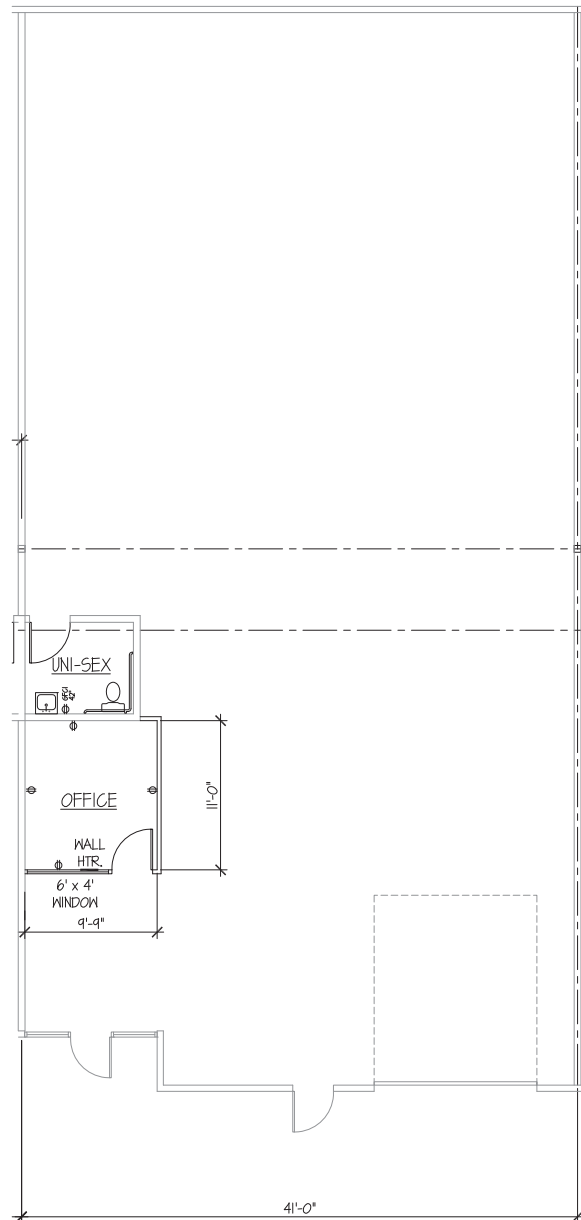

**NICK RATZKE, SIOR**  
253.779.2414  
nratzke@neilwalter.com

**BRIANA HICKEY**  
253.779.2424  
bhickey@neilwalter.com

1940 East D St, #100  
Tacoma, WA 98421  
253.779.8400  
www.neilwalter.com

All information references in this document are approximate. The information contained herein is contained from sources deemed reliable. It is provided without representation, warranty, or guarantee, expressed or implied as to accuracy. Prospective buyer or tenant should conduct its own independent investigation relating to the property, government codes and regulations, allowed uses, and all other matters, regardless of whether they are referred to or contained in this document.