

# THE BAXTER



Madeline Stutz  
Kara Farley

**WCCR**  
West Coast Commercial Realty

**T** | **TIMBERLANE**

## RETAIL FOR LEASE

80 apartment units above

1115 NE 2nd Street | Bellevue, WA 98004

# THE BAXTER

## THE OPPORTUNITY

Discover a fantastic opportunity at The Baxter, offering a 384 SF of retail space in Bellevue. Ideal for destination businesses seeking a tranquil setting close to Bellevue's vibrant core, this space is perfect for boutique shops, specialty services, or creative studios. Surrounded by a mix of residential and commercial spaces, this location offers a peaceful environment with convenient access.





## DEMOGRAPHICS

	1-Mile:	2-Mile:	3-Mile:
AVERAGE HOUSEHOLD INCOME	\$174,946	\$181,533	\$174,081
TOTAL POPULATION	30,342	57,246	111,842
HOUSEHOLDS	16,398	26,486	48,285
EMPLOYEES	53,628	70,664	104,544

## TRAFFIC COUNTS



12,060 vehicles a day at 112th Avenue NE and NE 2nd Street N 0.05 miles from the site

15,553 vehicles a day at 112th Avenue NE and NE 2nd Street S 0.05 miles from the site

13,108 vehicles a day at 112th Avenue NE and Main Street S 0.11 miles from the site

17,835 vehicles a day at Main Street S and 112th Avenue NE E 0.12 miles from the site

23,158 vehicles a day at NE 4th Street and 111th Avenue NE W 0.13 miles from the site

# FLOOR PLAN

384 SF AVAILABLE



NE 2nd Street

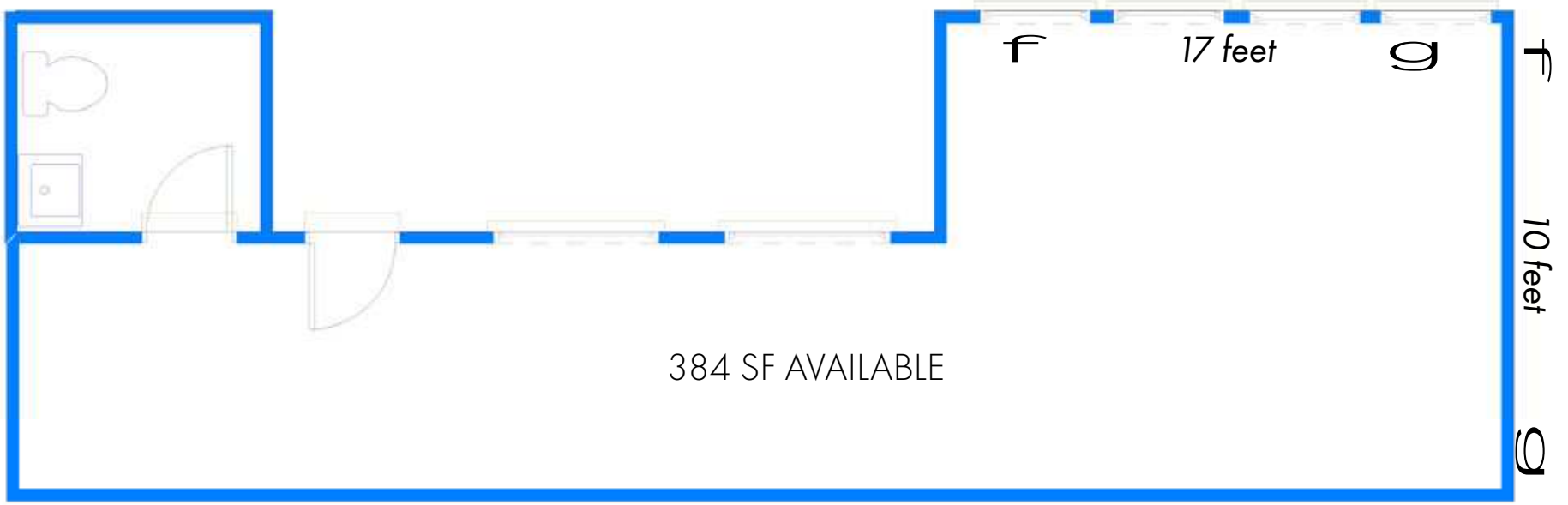





11115 NE 2nd Street | Bellevue, WA 98004

# RETAIL FOR LEASE

80 apartment units above

## LEASING INFORMATION

**Madeline Stutz**

[madelines@wccommercialrealty.com](mailto:madelines@wccommercialrealty.com)

(206) 422-7598

**Kara Farley**

[karaf@wccommercialrealty.com](mailto:karaf@wccommercialrealty.com)

(682) 351-8844

# WCCR

West Coast Commercial Realty



TIMBERLANE

DISCLAIMER: The above information has been secured from sources believed to be reliable, however, no representations are made to its accuracy. Prospective tenants or buyers should consult their professional advisors and conduct their own independent investigation. Site plan and configuration are subject to change. Properties are subject to change in price and/or availability without notice. West Coast Commercial Realty, LLC

