

Park 26

1320 26th St NW | Auburn, WA

Industrial Space | For Lease

3,000 SF



 THE ANDOVER
COMPANY, INC.
CORFAC INTERNATIONAL

DAVE DUNN, CCIM
(206) 336-5326
ddunn@andoverco.com

SHANE MAHVI
(206) 336-5338
smahvi@andoverco.com

Park 26

1320 26th St NW | Auburn, WA

Bay #14



3,000 SF
total



18'
clear height



\$1.10/SF +
\$0.30/SF, NNN



2 oversized
GL doors



+/- 300 SF
office with
restroom



Drive-thru
loading

Available Now

DAVE DUNN, CCIM

(206) 336-5326

ddunn@andoverco.com

SHANE MAHVI

(858) 442-0441

smahvi@andoverco.com



THE ANDOVER
COMPANY, INC.

CORFAC INTERNATIONAL

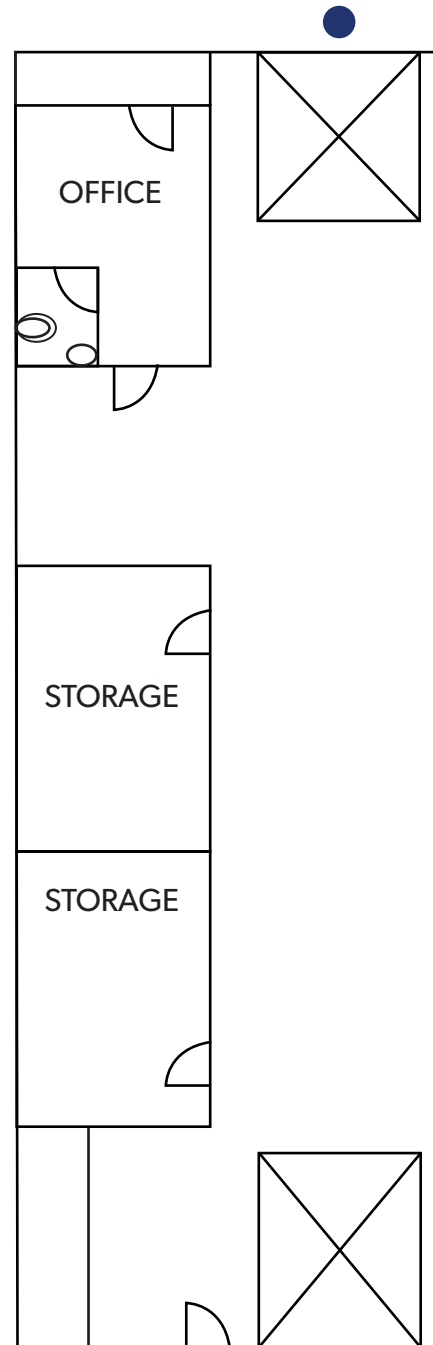

Storage
rooms can be
demolished, as
needed

● Oversized Grade-Level Door

