



±50,000-106,765 SF

Industrial space for sublease

Available
Immediately

1905 E Marc Avenue

Tacoma, WA

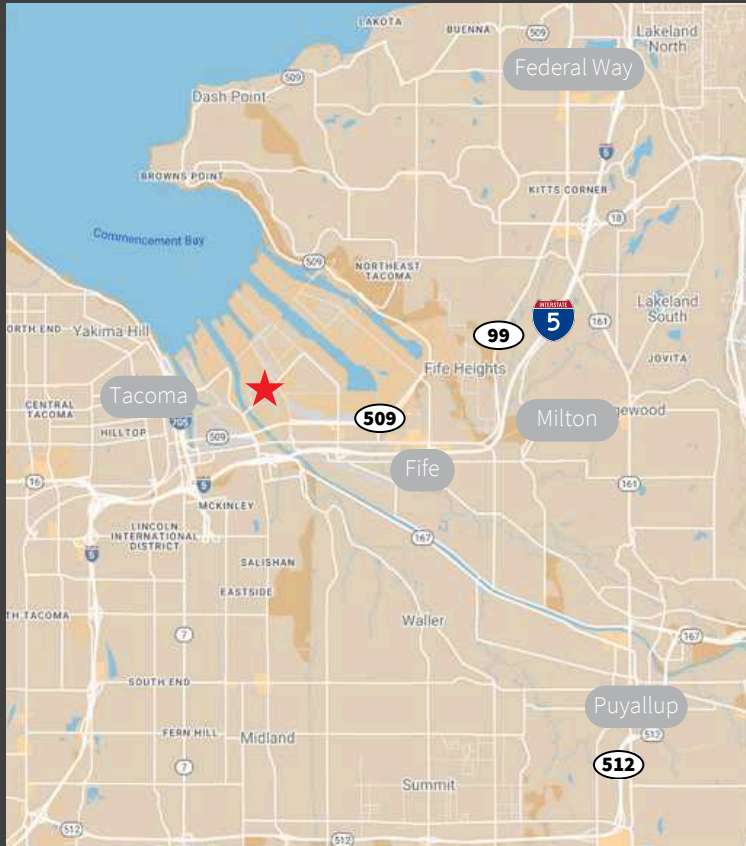

Property specifications

- ±106,765 SF available with 2,971 SF office
- Divisible to ±50,000 SF with 600 SF office
- 36' clear height
- 13-27 dock-high doors
- 1-2 grade-level doors
- ESFR sprinklers
- 20-52 trailer parking stalls
- LEX: 9/30/2027
- Available immediately
- Contact brokers for rates

JLL

Scott Carter
Managing Director

+1 425 7561 5880
scott.carter@jll.com

Les Boudwin, SIOR
Managing Director

+1 206 679 6393
les.boudwin@jll.com

±50,000-106,765 SF

Industrial space for sublease



Specifications

- ±106,765 SF
- ±2,971 SF office
- 36' clear height
- 27 dock-high doors
- 2 grade-level doors
- 52 trailer stalls

JLL

Scott Carter
Managing Director

+1 425 7561 5880
scott.carter@jll.com

Les Boudwin, SIOR
Managing Director

+1 206 679 6393
les.boudwin@jll.com

±50,000-106,765 SF

Industrial space for sublease

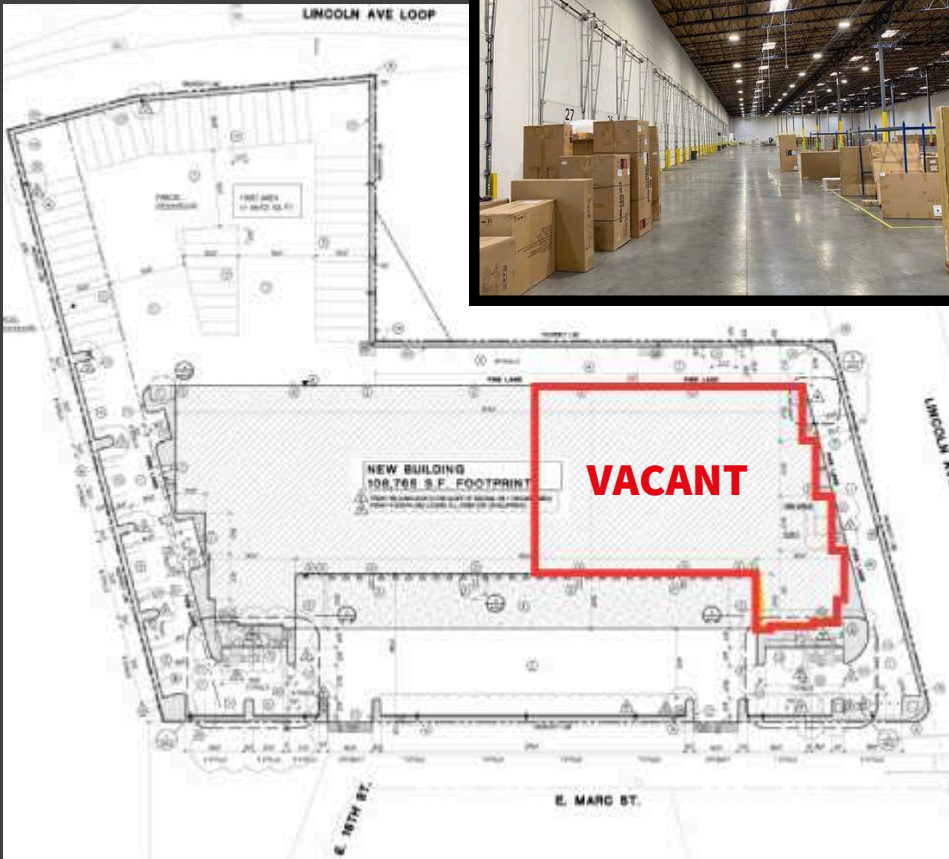

Specifications

- ±50,000 SF
- ±600 SF office
- 13 dock-high doors
- 1 grade-level doors
- 20-25 trailer stalls

JLL

Scott Carter
Managing Director

+1 425 7561 5880
scott.carter@jll.com

Les Boudwin, SIOR
Managing Director

+1 206 679 6393
les.boudwin@jll.com