

FOR LEASE

LAKE TYE BUSINESS CAMPUS

Industrial space for lease in an eight-building business park, centrally located in the Fryelands industrial hub of Monroe

169TH DR SE, 146TH ST SE, FRYELANDS BLVD | MONROE, WA

km Kidder
Mathews

LAKE TYE BUSINESS CAMPUS

INDUSTRIAL SPACES FOR LEASE

Flexible options

Newer building construction from 2003 - 2019

Grade-level loading

20' - 24' clear height

2.0 /1,000 SF parking ratio

Prime location with convenient access to the Lake Tye Trails

Walking distance to numerous lunch spots

Easy access to US-2 and Hwy-522

1 MI

TO US-2

1.7 MI

TO HWY-522

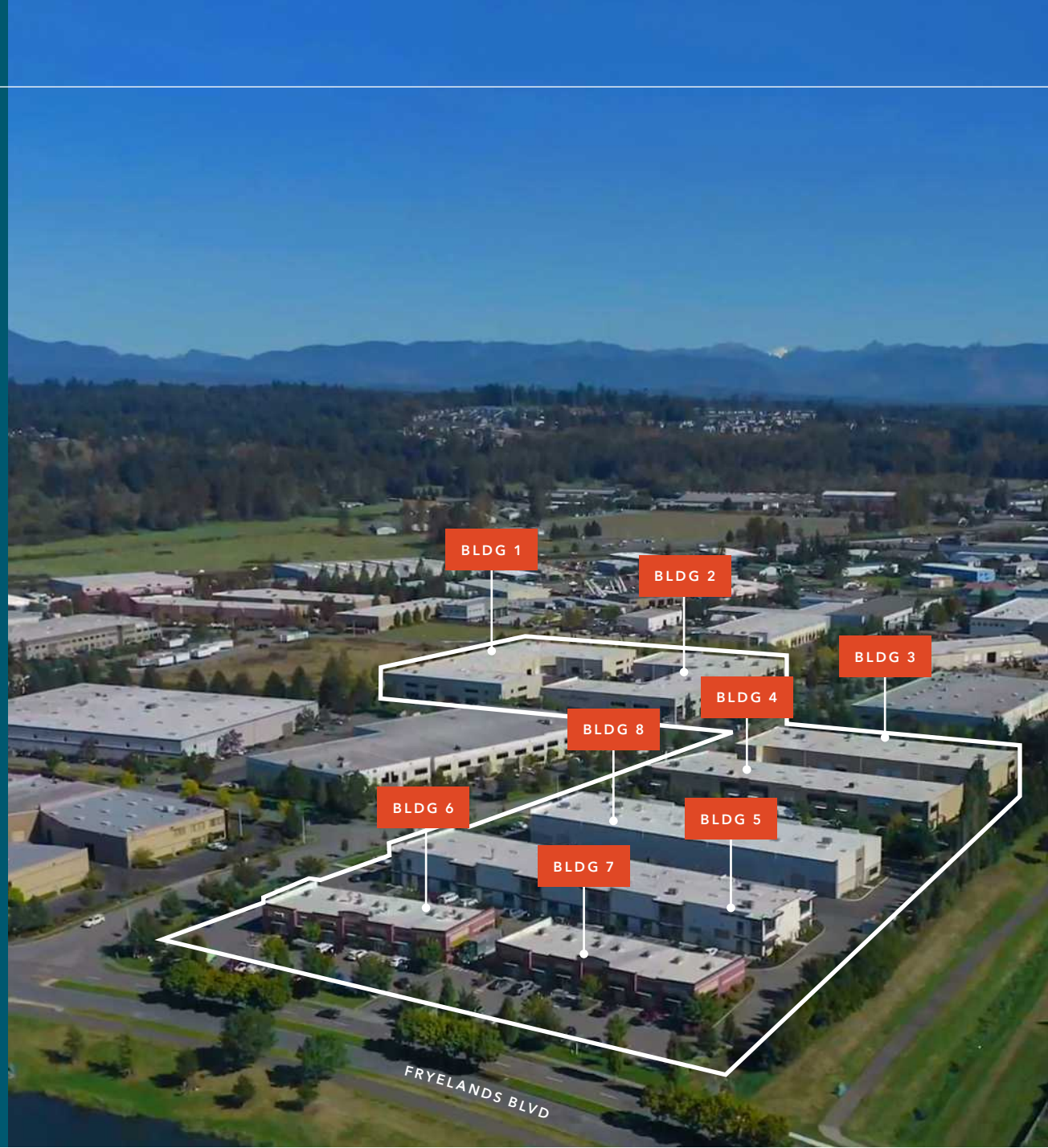



Lake Tye Business Campus is centrally located in the Monroe Industrial market, with easy access to both US-2 and HWY-522

BUILDING 2 - SUITE 145

16891 146TH ST SE, MONROE, WA



19,235 SF

AVAILABLE

\$1.00/SF

LEASE RATE, PLUS NNN

*60 DAYS
NOTICE*

AVAILABLE

CALL

FOR DETAILS

Currently built out for a church,
classroom with 100% A/C

LL open to convert space back
to warehouse

BUILDING 5 - SUITE 100

16642 146TH ST SE, MONROE, WA

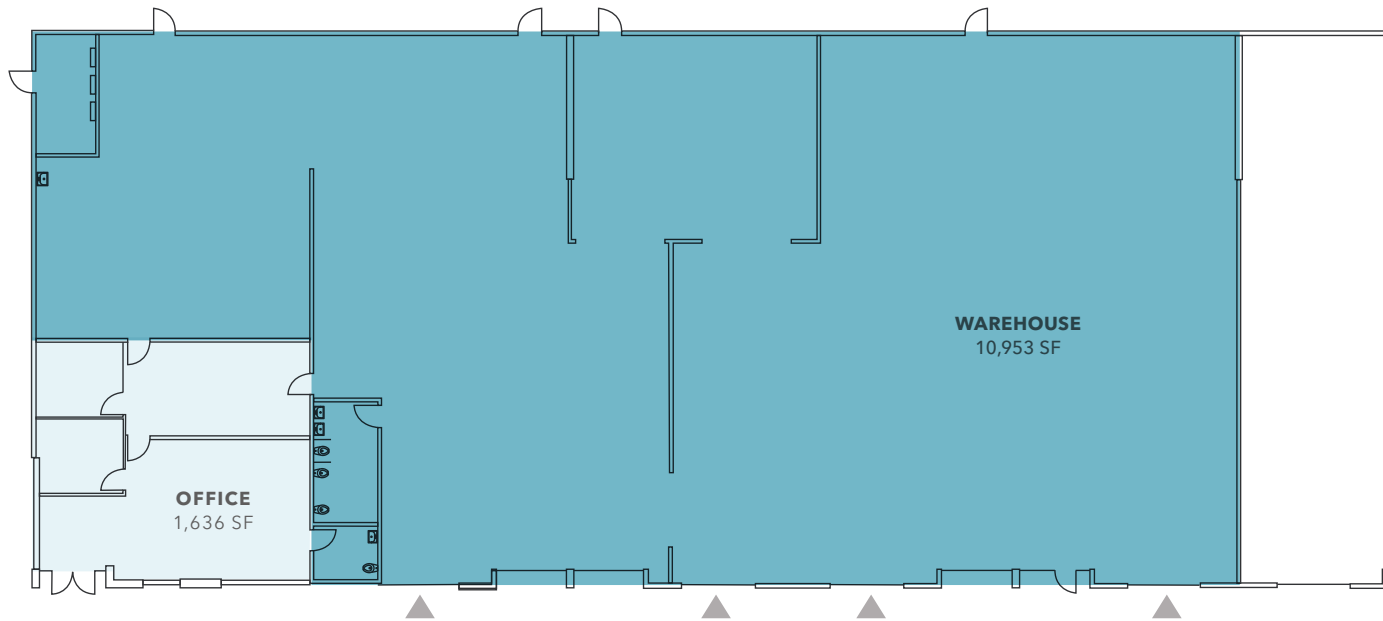

12,589 SF

AVAILABLE

1,636 SF

OFFICE

10,953 SF

WAREHOUSE

\$1.25/SF

LEASE RATE, PLUS NNN

CALL

FOR DETAILS

▲ GRADE-LEVEL DOOR



LAKE TYE BUSINESS CAMPUS

*For more information on
this property, please contact*

ZACH VALL-SPINOSA
425.450.1115
zach.vallspinosa@kidder.com

JAMES LEPTICH
425.450.1159
james.leptich@kidder.com

[KIDDER.COM](https://www.kidder.com)

This information supplied herein is from sources we deem reliable. It is provided without any representation, warranty, or guarantee, expressed or implied as to its accuracy. Prospective Buyer or Tenant should conduct an independent investigation and verification of all matters deemed to be material, including, but not limited to, statements of income and expenses. Consult your attorney, accountant, or other professional advisor. All Kidder Mathews designs are the sole property of Kidder Mathews. Branded materials and layouts are not authorized for use by any other firm or person.

