

# TOTEM VALLEY

## BUSINESS CENTER

12805 NE 125<sup>th</sup> Way | Kirkland, WA 98034



Northwest Building<sup>LLC</sup>

## NEWLY RENOVATED BUILDINGS & LANDSCAPING



### BUILDING FEATURES



**EXCELLENT ACCESS**



**GRADE-LEVEL LOADING**



**13' CLEAR HEIGHT**



**AMENITIES NEARBY**



**ABUNDANT PARKING**



*For more information or to schedule a tour, please contact:*

**CONNOR GILCHRIST**  
425.274.4286  
gilchrist@broderickgroup.com

**JEFF LIVINGSTON**  
425.274.4288  
livingston@broderickgroup.com

**RAWLEY HOLMBERG**  
425.274.4284  
holmberg@broderickgroup.com

*The information contained herein has been given to us by the owner or sources which we deem reliable. We have no reason to doubt its accuracy, but we do not guarantee it. Prospective tenants should carefully verify all information contained herein.*

# TOTEM VALLEY BUSINESS CENTER

12805 NE 125<sup>th</sup> Way | Kirkland, WA 98034

## AREA AMENITIES



- |                                |  |  |
|--------------------------------|--|--|
| <b>1</b> QFC                   | <b>11</b> Fred Meyer                     | <b>21</b> Rite Aid                     |
| <b>2</b> Five Guys             | <b>12</b> EvergreenHealth Medical Center | <b>22</b> LA Fitness                   |
| <b>3</b> Courtyard by Marriott | <b>13</b> Key Bank                       | <b>23</b> Northwest Cellars            |
| <b>4</b> Papa Murphy's         | <b>14</b> The Village at Totem Lake      | <b>24</b> Totem Square Shopping Center |
| <b>5</b> Olive Garden          | <b>15</b> Chipotle                       | <b>25</b> Subway                       |
| <b>6</b> Starbucks             | <b>16</b> MOD Pizza                      | <b>26</b> 7-Eleven                     |
| <b>7</b> Azteca                | <b>17</b> Wells Fargo                    | <b>27</b> Teriyaki Plus                |
| <b>8</b> Wendy's               | <b>18</b> Bank of America                | <b>28</b> Shari's                      |
| <b>9</b> Lowe's                | <b>19</b> Chick-fil-A                    | <b>29</b> Gold's Gym                   |
| <b>10</b> Jimmy John's         | <b>20</b> Comfort Inn                    |  |

*For more information or to schedule a tour, please contact:*



**CONNOR GILCHRIST**  
425.274.4286  
gilchrist@broderickgroup.com

**JEFF LIVINGSTON**  
425.274.4288  
livingston@broderickgroup.com

**RAWLEY HOLMBERG**  
425.274.4284  
holmberg@broderickgroup.com

*The information contained herein has been given to us by the owner or sources which we deem reliable. We have no reason to doubt its accuracy, but we do not guarantee it. Prospective tenants should carefully verify all information contained herein.*

# TOTEM VALLEY

## BUSINESS CENTER

12805 NE 125<sup>th</sup> Way | Kirkland, WA 98034

# AVAILABILITY

BUILDING / SUITE	AVAILABLE SPACE	OFFICE SF	WHSE SF	AVAILABLE DATE	MONTHLY BASE RENT
<u>F/120</u>	642 RSF	642 RSF	0 RSF	Now	Inquire with broker

The information contained herein has been given to us by the owner or sources that we deem reliable. We have no reason to doubt its accuracy, but we do not guarantee it. Prospective tenants should carefully verify all information contained herein.

## SITE MAP



For more information or to schedule a tour, please contact:

**CONNOR GILCHRIST**  
425.274.4286  
gilchrist@broderickgroup.com

**JEFF LIVINGSTON**  
425.274.4288  
livingston@broderickgroup.com

**RAWLEY HOLMBERG**  
425.274.4284  
holmberg@broderickgroup.com

The information contained herein has been given to us by the owner or sources which we deem reliable. We have no reason to doubt its accuracy, but we do not guarantee it. Prospective tenants should carefully verify all information contained herein.

# TOTEM VALLEY

## BUSINESS CENTER

12805 NE 125<sup>th</sup> Way | Kirkland, WA 98034

# BUILDING F

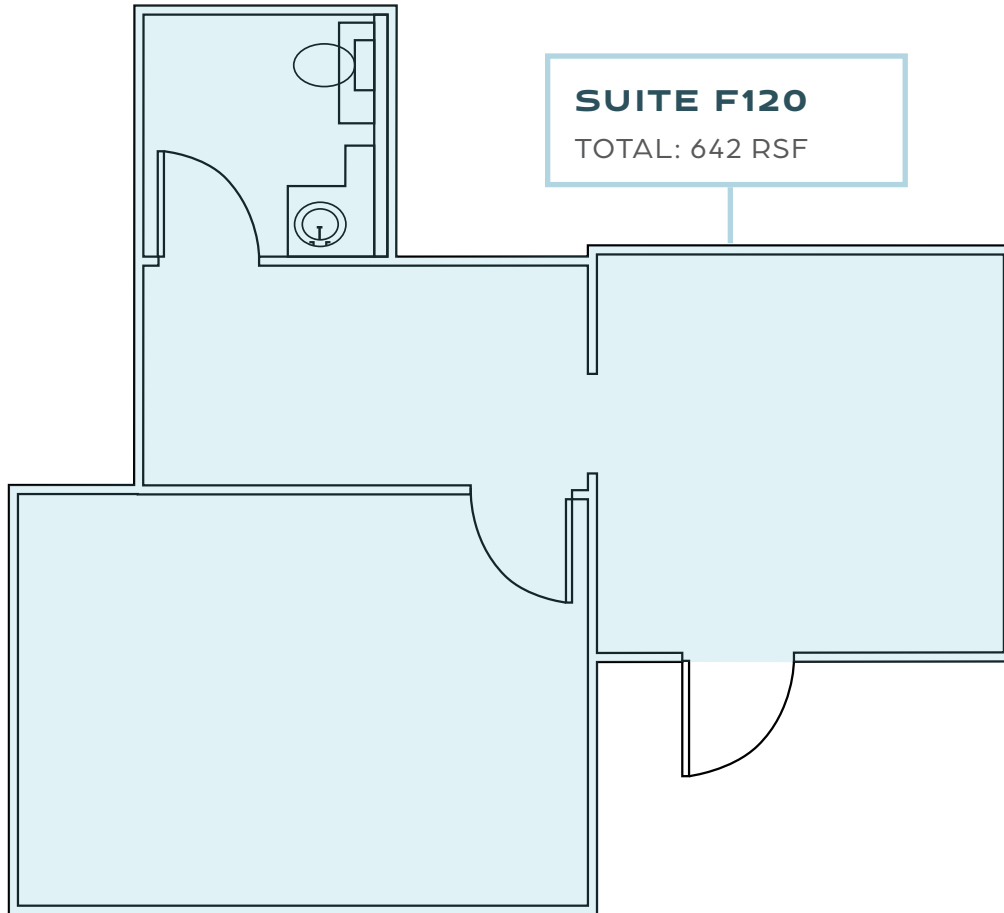

WAREHOUSE



GRADE LEVEL DOOR



 **BACK TO AVAILABILITY**



For more information or to schedule a tour, please contact:

**CONNOR GILCHRIST**  
425.274.4286  
gilchrist@broderickgroup.com

**JEFF LIVINGSTON**  
425.274.4288  
livingston@broderickgroup.com

**RAWLEY HOLMBERG**  
425.274.4284  
holmberg@broderickgroup.com

The information contained herein has been given to us by the owner or sources which we deem reliable. We have no reason to doubt its accuracy, but we do not guarantee it. Prospective tenants should carefully verify all information contained herein.