

# RIVERBEND COMMERCE CENTER



26511 79TH AVE S | BLDG C | KENT, WA



**BRIAN BRUININKS, CCIM**  
(206) 856-6249  
bbruininks@andoverco.com

**SHANE MAHVI**  
(858) 442-0441  
smahvi@andoverco.com

21,622 SF



# RIVERBEND COMMERCE CENTER

26511 79TH AVE S | BLDG C | KENT, WA

## PROPERTY HIGHLIGHTS

- Total Space: 21,622 SF
- Office Space: 3,720 SF
  - 1,048 SF (North end office)
  - 2,682 SF on two floors (West end office)
- 8 dock high doors
- 2 grade level doors
- Available with 30-60 days notice

**BRIAN BRUININKS, CCIM**  
(206) 856-6249  
bbruininks@andoverco.com

**SHANE MAHVI**  
(858) 442-0441  
smahvi@andoverco.com

*The information contained herein has been obtained from reliable sources, but is not guaranteed. A prospective buyer/tenant should verify each item relating to this property and all information contained herein.*

RIVERBEND BUILDING | KENT, WA



# BUILDING C

21,622 SF

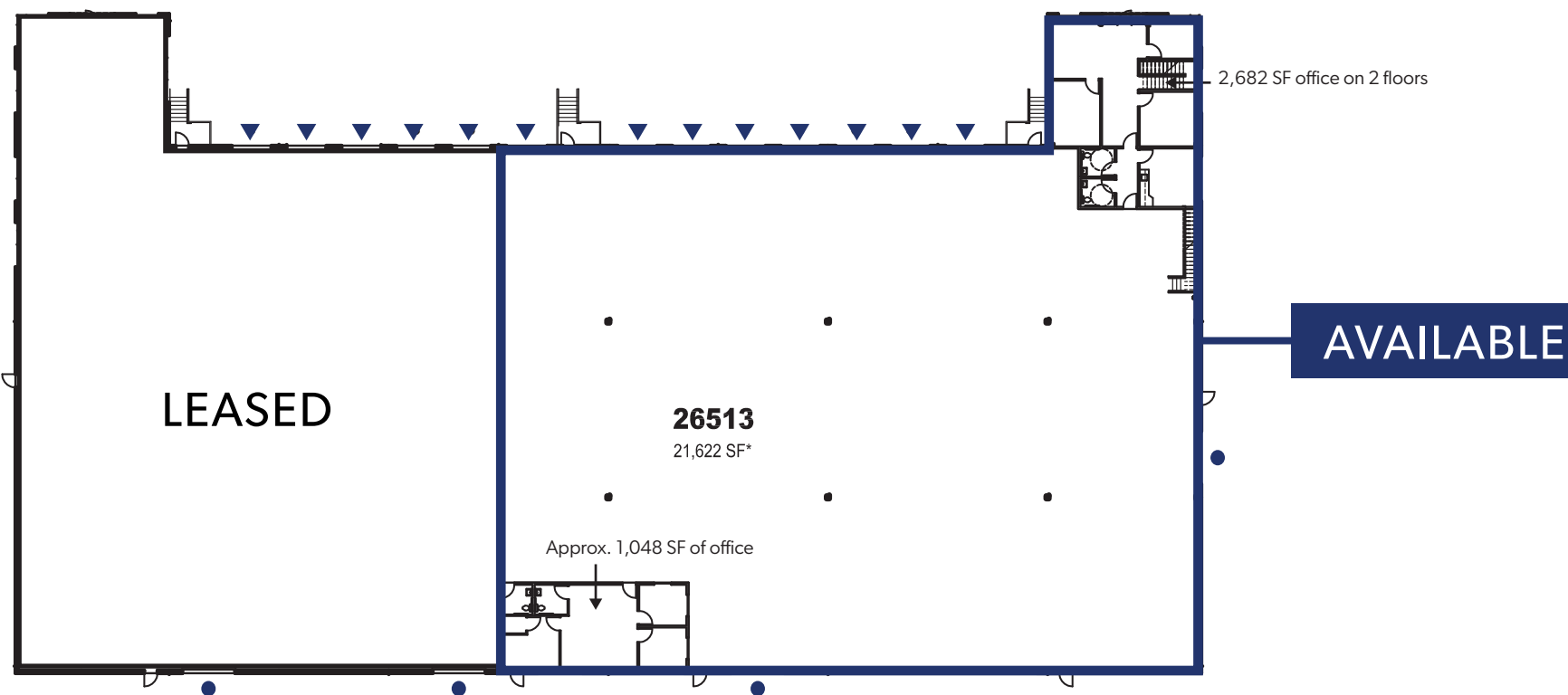
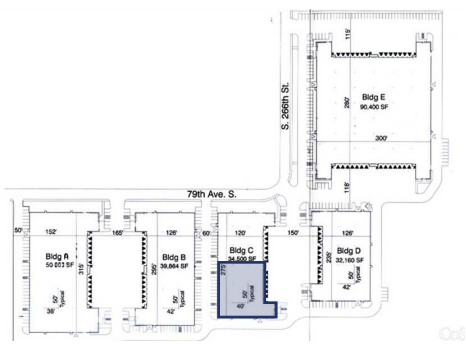

- ▲ Dock High Door
- Grade Level Door







**BRIAN BRUININKS, CCIM**  
(206) 856-6249  
bbruininks@andoverco.com

**SHANE MAHVI**  
(858) 442-0441  
smahvi@andoverco.com



# RIVERBEND COMMERCE CENTER

26511 79TH AVE S | BLDG C | KENT, WA