

FOR LEASE

KENT 228 BUILDING F

SUITE 8041

TOTAL AREA	26,980 SF
OFFICE	3,505 SF
DOCK-HIGH LOADING	8
DRIVE-IN LOADING	3
CLEAR HEIGHT	24'
ZONING	M-3
SHELL	\$1.30/SF
OFFICE	\$1.30/SF
NNN	\$0.32/SF
PARKING	Ample
AVAILABLE	April 1, 2025

CHRIS CORR

206.248.7324 | chris.corr@kidder.com

MATT MURRAY

206.248.6541 | matt.murray@kidder.com

KIDDER.COM

This information supplied herein is from sources we deem reliable. It is provided without any representation, warranty, or guarantee, expressed or implied as to its accuracy. Prospective Buyer or Tenant should conduct an independent investigation and verification of all matters deemed to be material, including, but not limited to, statements of income and expenses. Consult your attorney, accountant, or other professional advisor. All Kidder Mathews designs are the sole property of Kidder Mathews. Branded materials and layouts are not authorized for use by any other firm or person.



8041 S 224TH ST | KENT, WA

SUITE 8041

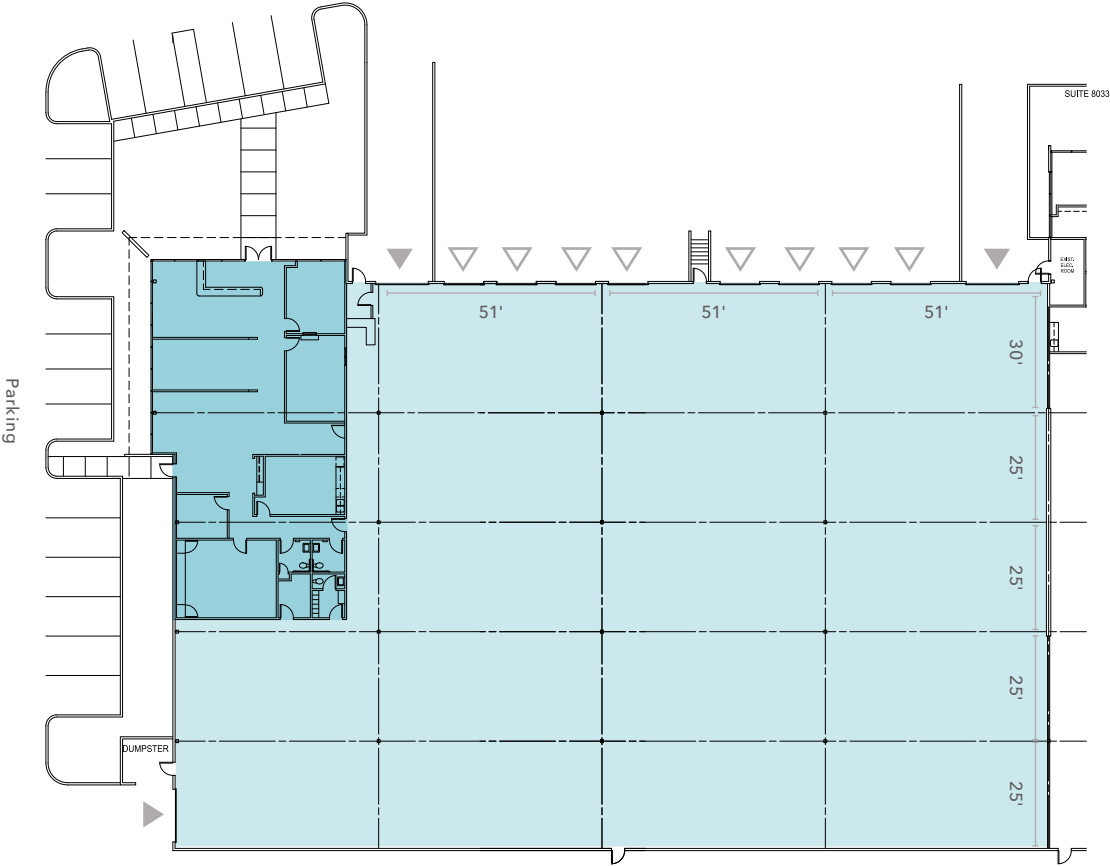

BUILDING F

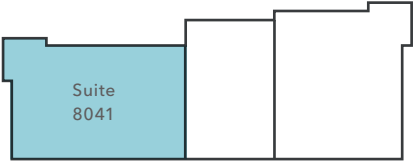

26,980 SF
TOTAL AREA

3,505 SF
OFFICE

04/01/25
AVAILABLE

LEGEND

- Office
- Warehouse
- Drive-In Loading
- Dock-High Loading



KIDDER.COM

This information supplied herein is from sources we deem reliable. It is provided without any representation, warranty, or guarantee, expressed or implied as to its accuracy. Prospective Buyer or Tenant should conduct an independent investigation and verification of all matters deemed to be material, including, but not limited to, statements of income and expenses. Consult your attorney, accountant, or other professional advisor. All Kidder Mathews designs are the sole property of Kidder Mathews. Branded materials and layouts are not authorized for use by any other firm or person.



FOR LEASE | KENT 228, BUILDING F

20 MI
SEATTLE

20.6 MI
TACOMA

10.6 MI
SEATAC

CHRIS CORR
Executive Vice President,
Shareholder
206.248.7324
chris.corr@kidder.com

MATT MURRAY
Executive Vice President
206.248.6541
matt.murray@kidder.com

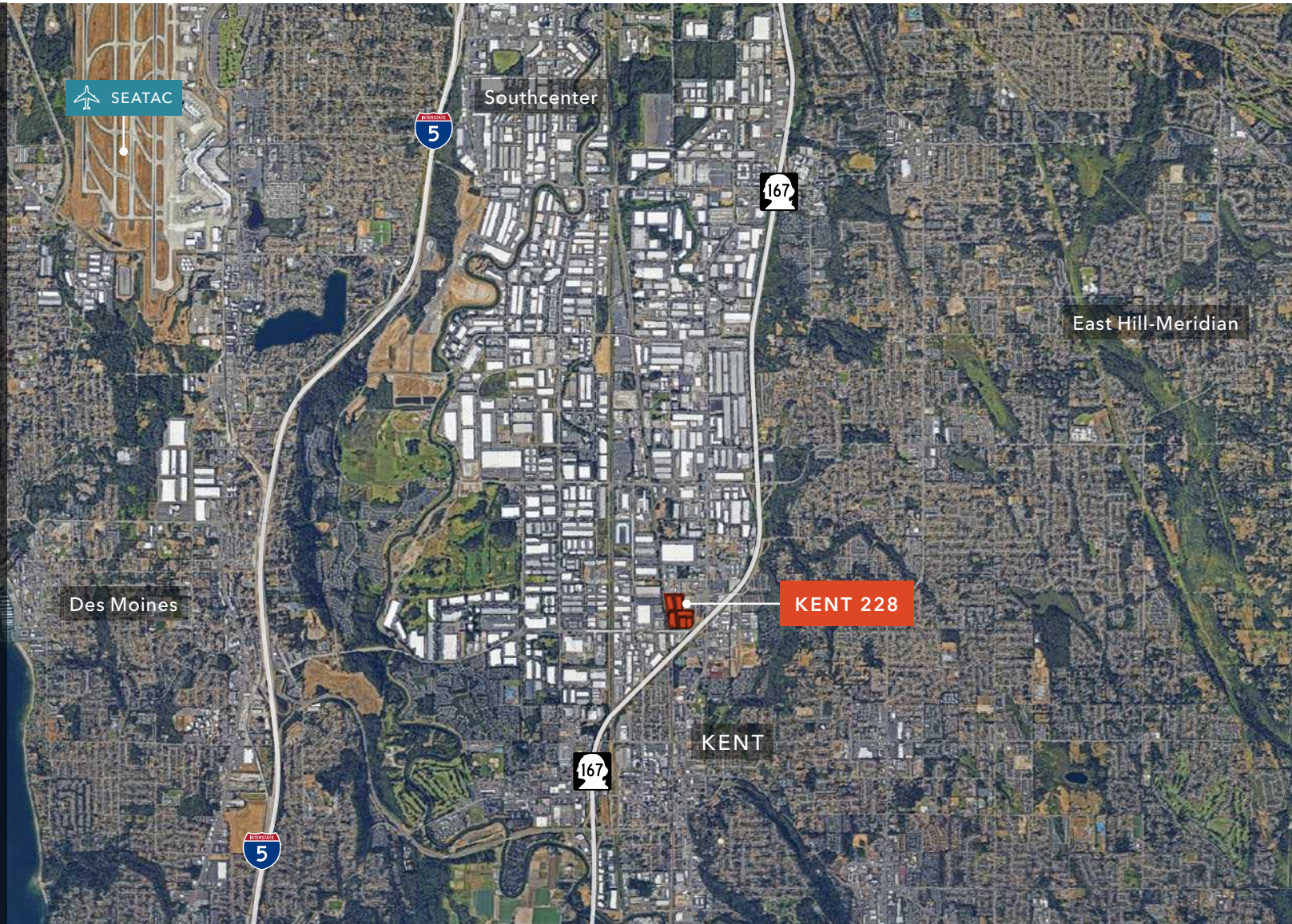

KIDDER.COM

This information supplied herein is from sources we deem reliable. It is provided without any representation, warranty, or guarantee, expressed or implied as to its accuracy. Prospective Buyer or Tenant should conduct an independent investigation and verification of all matters deemed to be material, including, but not limited to, statements of income and expenses. Consult your attorney, accountant, or other professional advisor. All Kidder Mathews designs are the sole property of Kidder Mathews. Branded materials and layouts are not authorized for use by any other firm or person.

