

FOR LEASE

YELM WALMART PADS

17041 WA-507
YELM, WA 98597



KIDDER.COM

* RENDERING IS FOR CONCEPTUAL PURPOSES ONLY & SUBJECT TO CHANGE

km Kidder
Mathews

PROPERTY OVERVIEW

2.2 Acres

507 - 8,000 SF

Ground-lease pad opportunities

Drive-thru opportunity

Located across from Walmart Supercenter

Sewer accessible

Located at main access point for future Yelm 510 Bypass Highway

Located in Yelm retail core



SITE PLAN OPTION 1

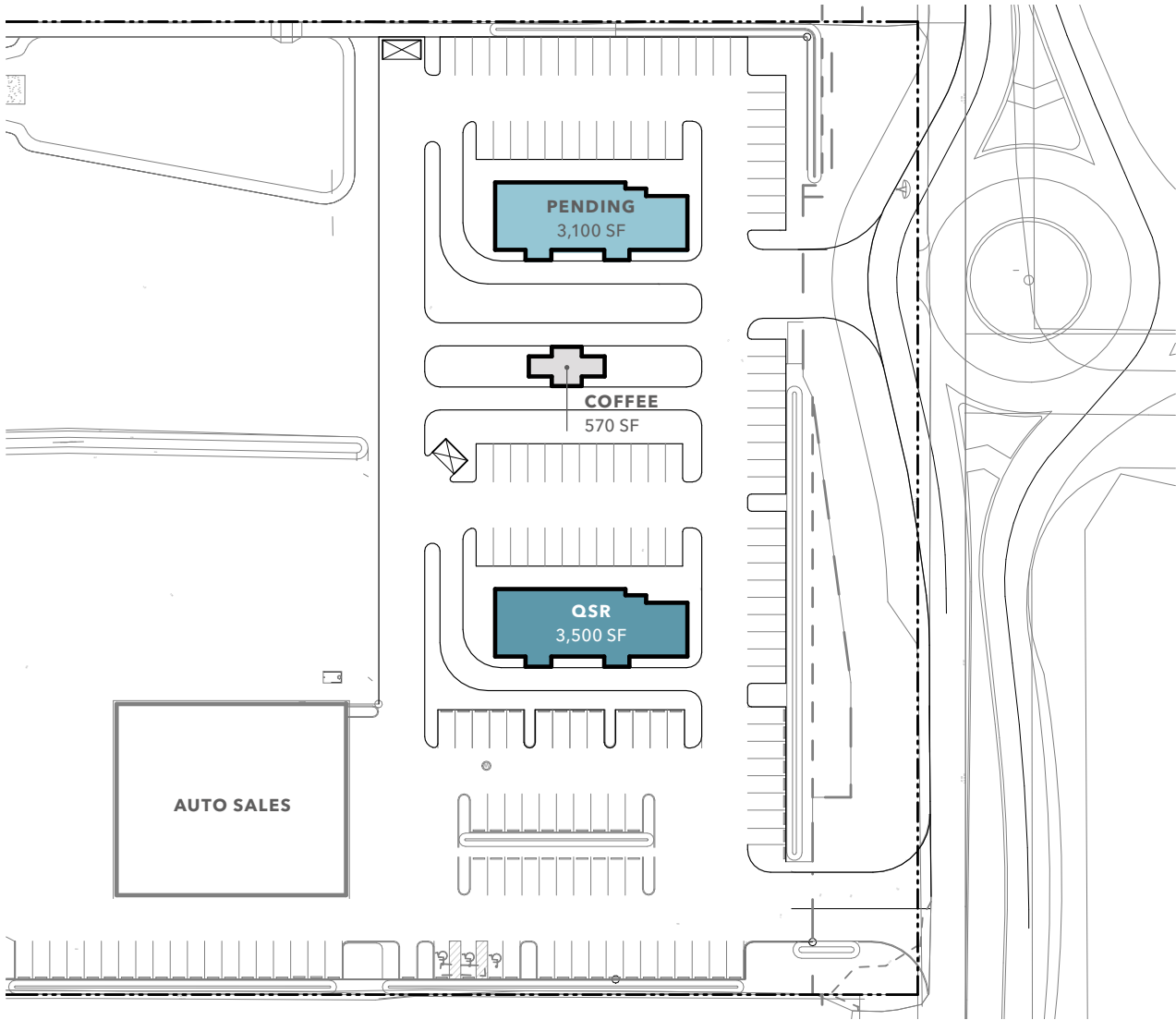

3,500 SF

QSR SPACES

3,100 SF

PENDING SPACE

570 SF

COFFEE SPACE

NOW

AVAILABLE

SITE PLAN OPTION 2

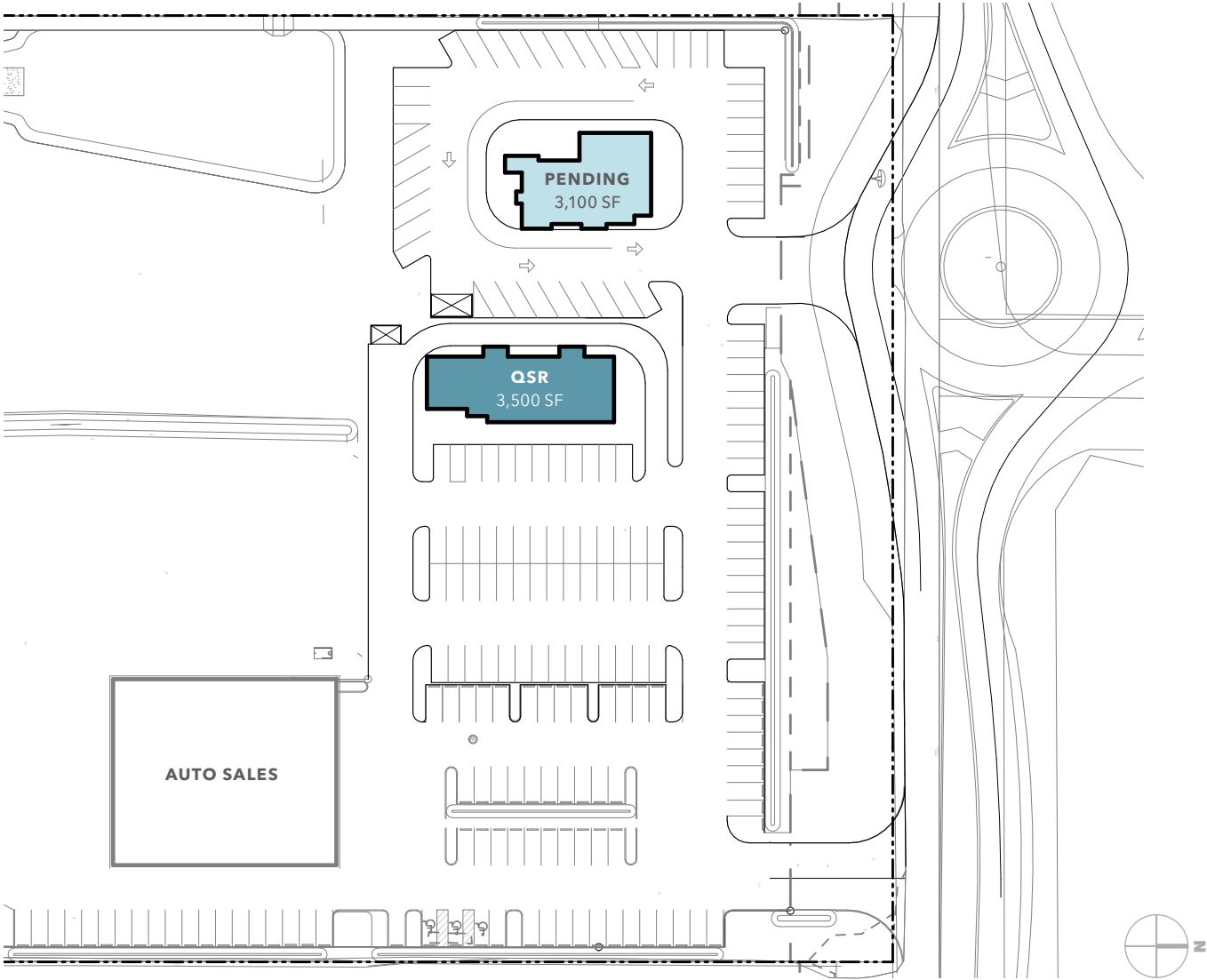

3,100 SF

PENDING SPACE

3,500 SF

QSR SPACE

NOW

AVAILABLE

DEMOGRAPHICS

POPULATION

	5 Mins	10 Mins	20 Mins
2010 CENSUS	6,975	12,987	27,704
2020 CENSUS	9,038	17,003	33,591
2024 ESTIMATED	8,712	17,317	34,376
2029 PROJECTED	8,720	17,494	34,626

MEDIAN AGE & GENDER

	5 Mins	10 Mins	20 Mins
MEDIAN AGE	34.5	34.9	38.4
% FEMALE	50.1%	50.6%	50.4%
% MALE	49.9%	49.4%	49.6%

HOUSEHOLD INCOME

	5 Mins	10 Mins	20 Mins
2024 MEDIAN	\$94,835	\$95,169	\$100,764
2029 MEDIAN PROJECTED	\$98,215	\$98,295	\$104,120
2024 AVERAGE	\$117,352	\$119,387	\$130,336
2029 AVERAGE PROJECTED	\$121,974	\$124,436	\$136,174

Data Source: ©2025, Sites USA





YELM WALMART PADS

Exclusively leased by

BLAKE WEBER
Senior Vice President
206.898.1231
blake.weber@kidder.com

DON WHITTLES
Senior Vice President
253.208.2257
don.whittles@kidder.com

NED WHALEN
Senior Vice President
206.491.5998
ned.whalen@kidder.com

KIDDER.COM

This information supplied herein is from sources we deem reliable. It is provided without any representation, warranty, or guarantee, expressed or implied as to its accuracy. Prospective Buyer or Tenant should conduct an independent investigation and verification of all matters deemed to be material, including, but not limited to, statements of income and expenses. Consult your attorney, accountant, or other professional advisor. All Kidder Mathews designs are the sole property of Kidder Mathews. Branded materials and layouts are not authorized for use by any other firm or person.

