

FOR LEASE

172nd Street NE & I-5
Marysville, WA



SMOKEY POINT RETAIL

Justin Holmes | Josh Parnell

First Western Properties—Tacoma Inc. | 253.472.0404
6402 Tacoma Mall Blvd, Tacoma, WA 98409 | fwp-inc.com

SMOKEY POINT RETAIL is a development located adjacent to the Target and Costco that serve the Marysville, Smokey Point, Arlington and Stanwood communities. Center includes national brands with a good mix of local amenities.

AVAILABLE

1,167 SF \$42.00 PSF + \$13.23 NNN



Population



Average HH Income



Daytime Population

Regis - 2025

	Population	Average HH Income	Daytime Population
Mile 1	7,370	\$103,051	5,695
Mile 3	27,730	\$130,948	18,431
Mile 5	65,091	\$141,418	41,138

TENANTS

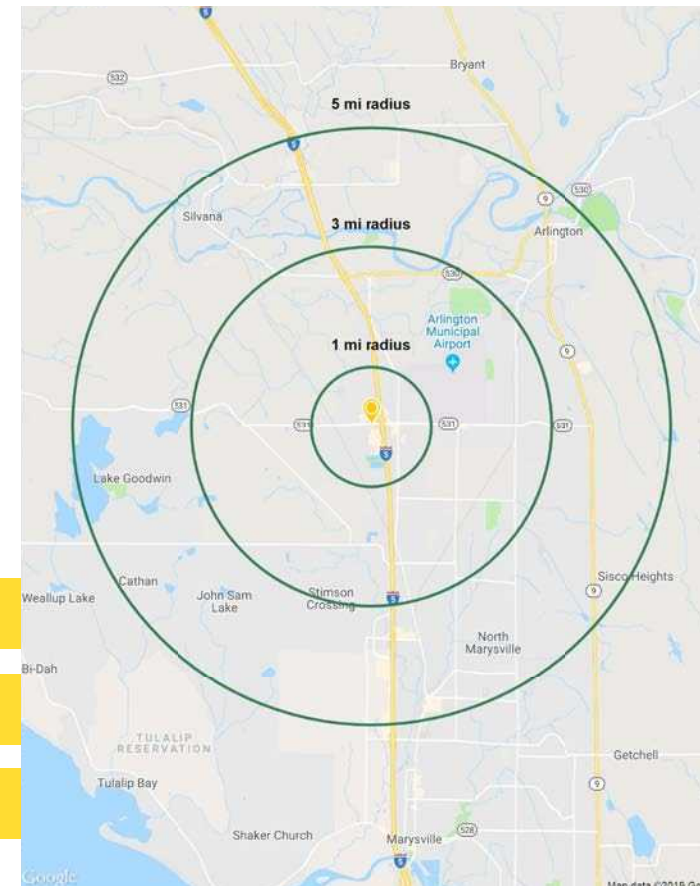

LOCATION AERIAL



SITE PLAN

SMOKEY
POINT
PLAZA

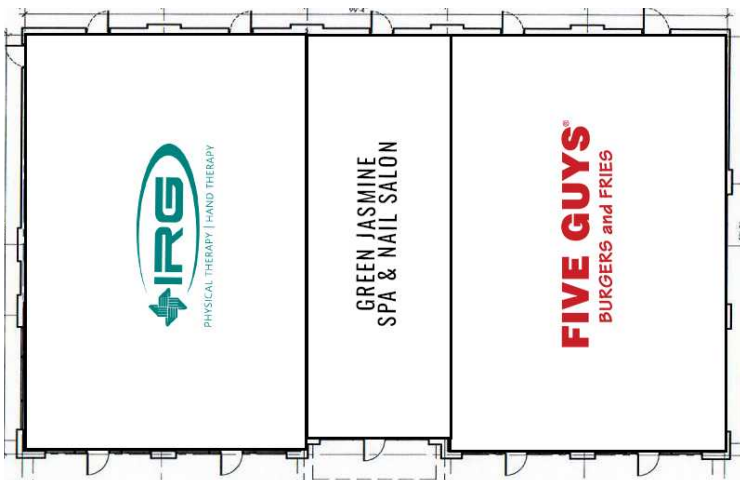
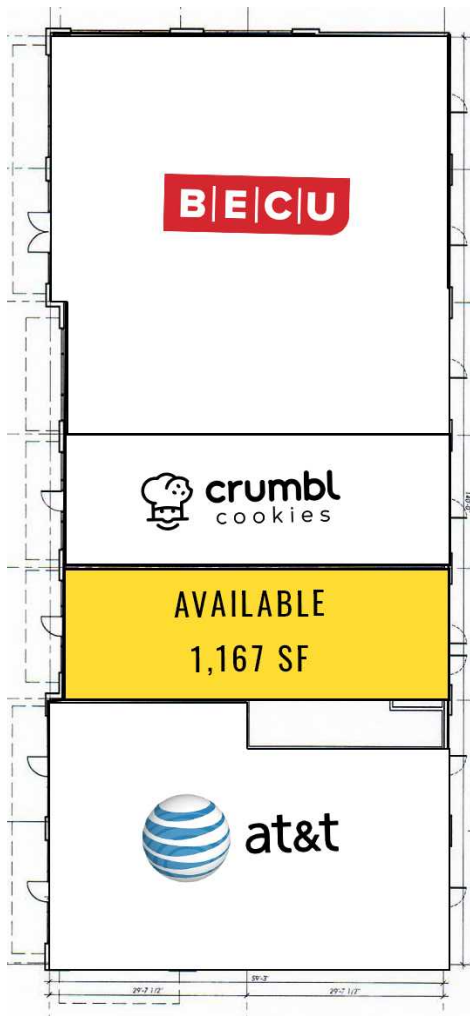

SITE PLAN

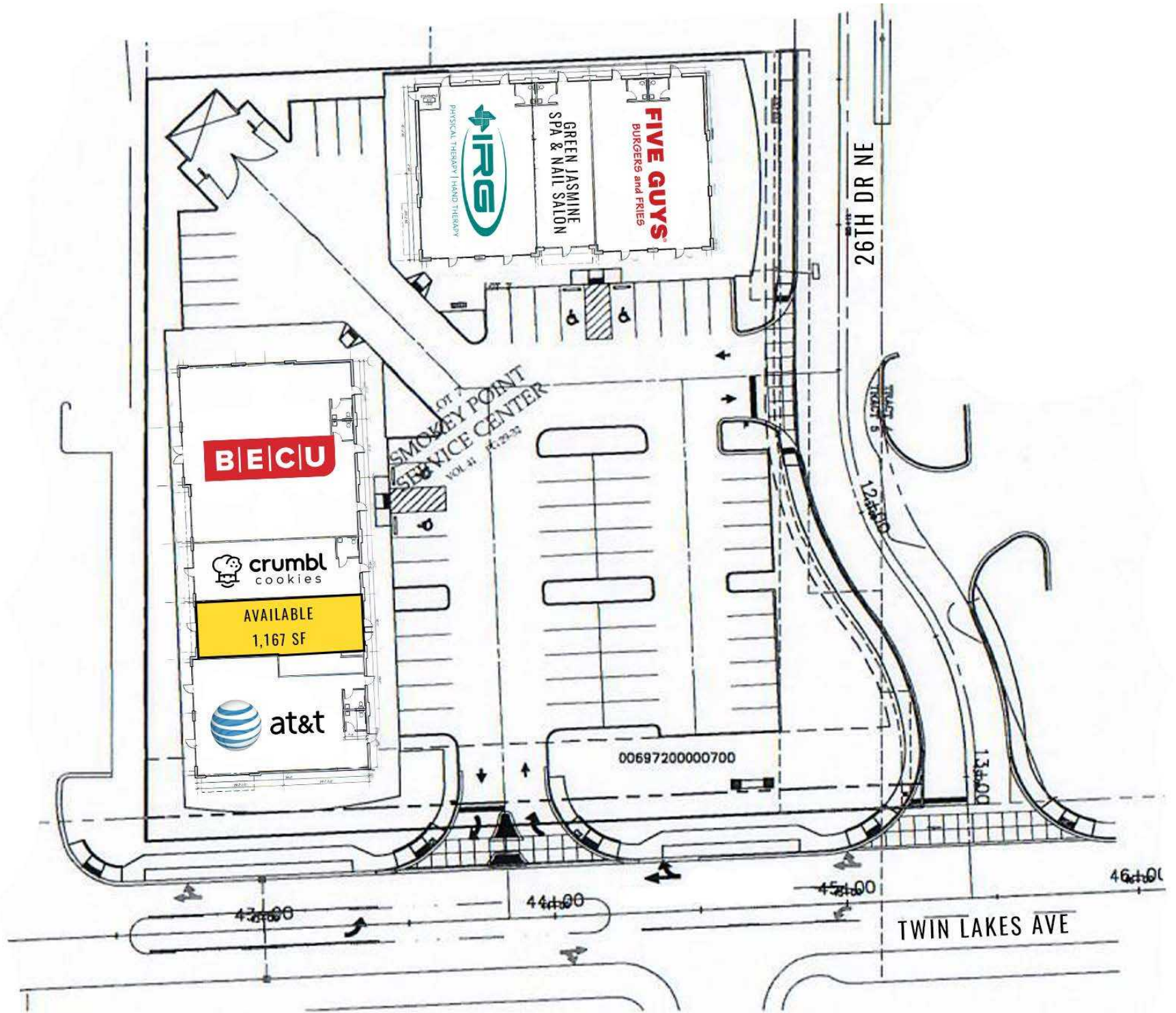

SUMMARY



TACOMA | KIRKLAND | PORTLAND | SEATTLE

RELATIONSHIP FOCUSED.
RESULTS DRIVEN.

JUSTIN HOLMES

 253.447.2282

 justin@firstwesternproperties.com

JOSH PARNELL

 253.284.3630

 josh@firstwesternproperties.com

First Western Properties—Tacoma Inc. | 253.472.0404
6402 Tacoma Mall Blvd, Tacoma, WA 98409 | fwp-inc.com

© First Western Properties, Inc. DISCLAIMER: The above information has been secured from sources believed to be reliable, however, no representations are made to its accuracy. Prospective tenants or buyers should consult their professional advisors and conduct their own independent investigation. Properties are subject to change in price and/or availability without notice.

