

Northwest Corporate Park

715 S Fidalgo St & 770 S Michigan St
Seattle, WA 98108

SYLVANIA BLDG

46,125 SF

BLDG C

83,500 SF

Exclusively marketed by:

NAI Puget Sound
Properties

JOHN VERNON
+1 425 586 5638
jvernon@nai-psp.com

TAMIR OHAYON
+1 425 586 5627
tohayon@nai-psp.com

BOB SWAIN, CCIM
+1 425 586 5622
bswain@nai-psp.com

715 S Fidalgo St & 770 S Michigan St

Seattle, WA



SYLVANIA BLDG

TOTAL SF SHELL 46,125 SF

OFFICE SF 2,179 SF (new)

CLEAR HEIGHT 20'

DOCK DOORS 10 Docks; 1 Ramp

LEASE RATE \$1.35 shell / \$1.50 office
NNN (2025) \$0.38

BLDG C, SUITE B

TOTAL SF SHELL 53,415 SF

OFFICE SF 4,417 SF (new)

CLEAR HEIGHT 22'

DOCK DOORS 16 DH; 1 Ramp

LEASE RATE \$1.35 shell / \$1.50 office
NNN (2025) \$0.44

BLDG C, SUITE A

TOTAL SF SHELL 30,085 SF

OFFICE SF 1,000 SF (new)

CLEAR HEIGHT 22'

DOCK DOORS 14 DH; 1 Ramp; 1 GL

LEASE RATE \$1.35 shell / \$1.50 office
NNN (2025) \$0.44

BLDG C FLOOR PLAN

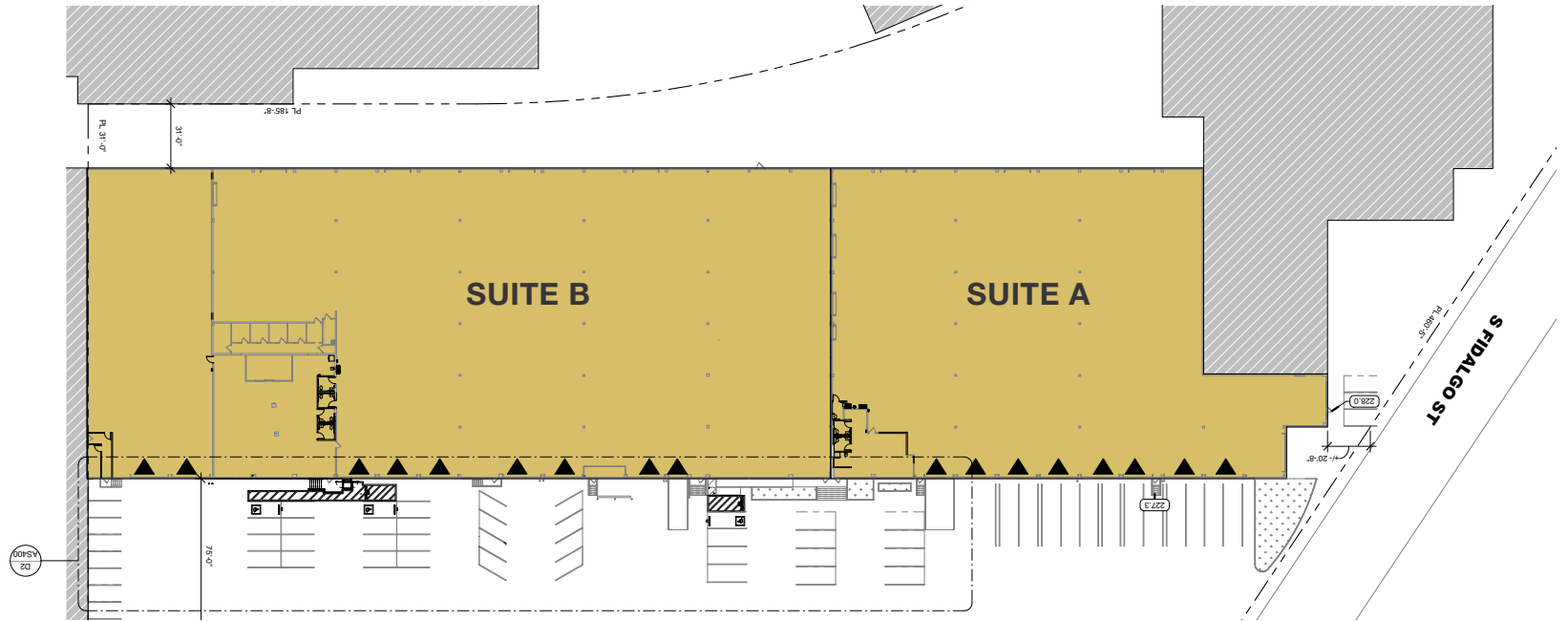

SYLVANIA FLOOR PLAN

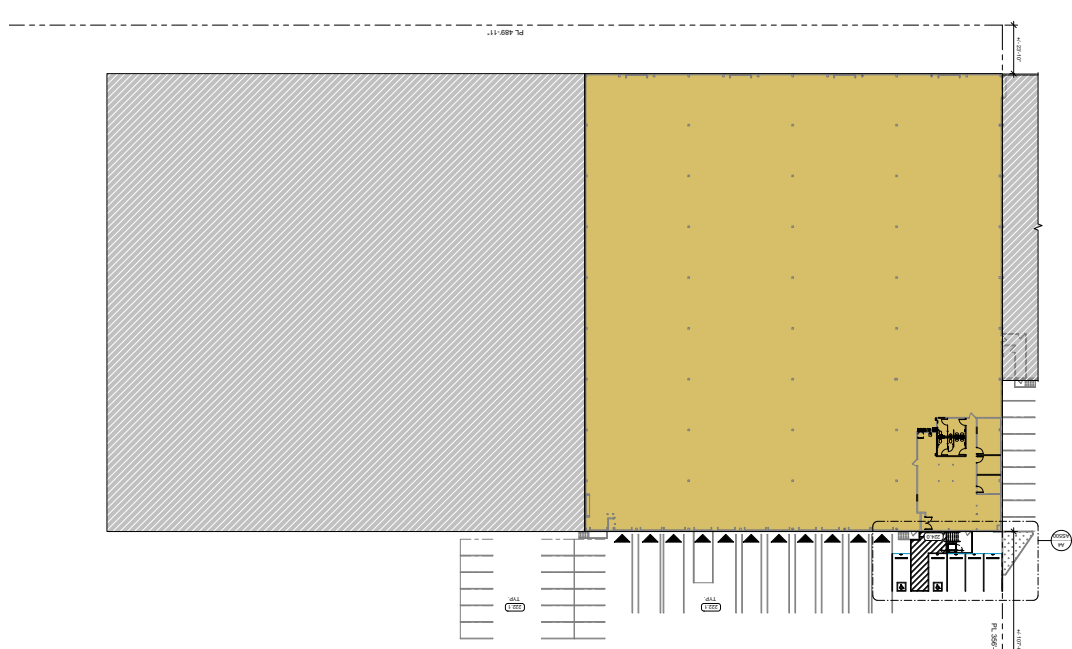

Northwest Corporate Park, Bldg C & Sylvania Bldg

NAI Puget Sound Properties is pleased to present an opportunity to lease a prime office/warehouse space in Georgetown.

IG2-85
Zoning

TOTAL AVAILABLE SF 129,625 SF

WILL CONSIDER DIVIDING TO 30,085 SF

AVAILABLE Now



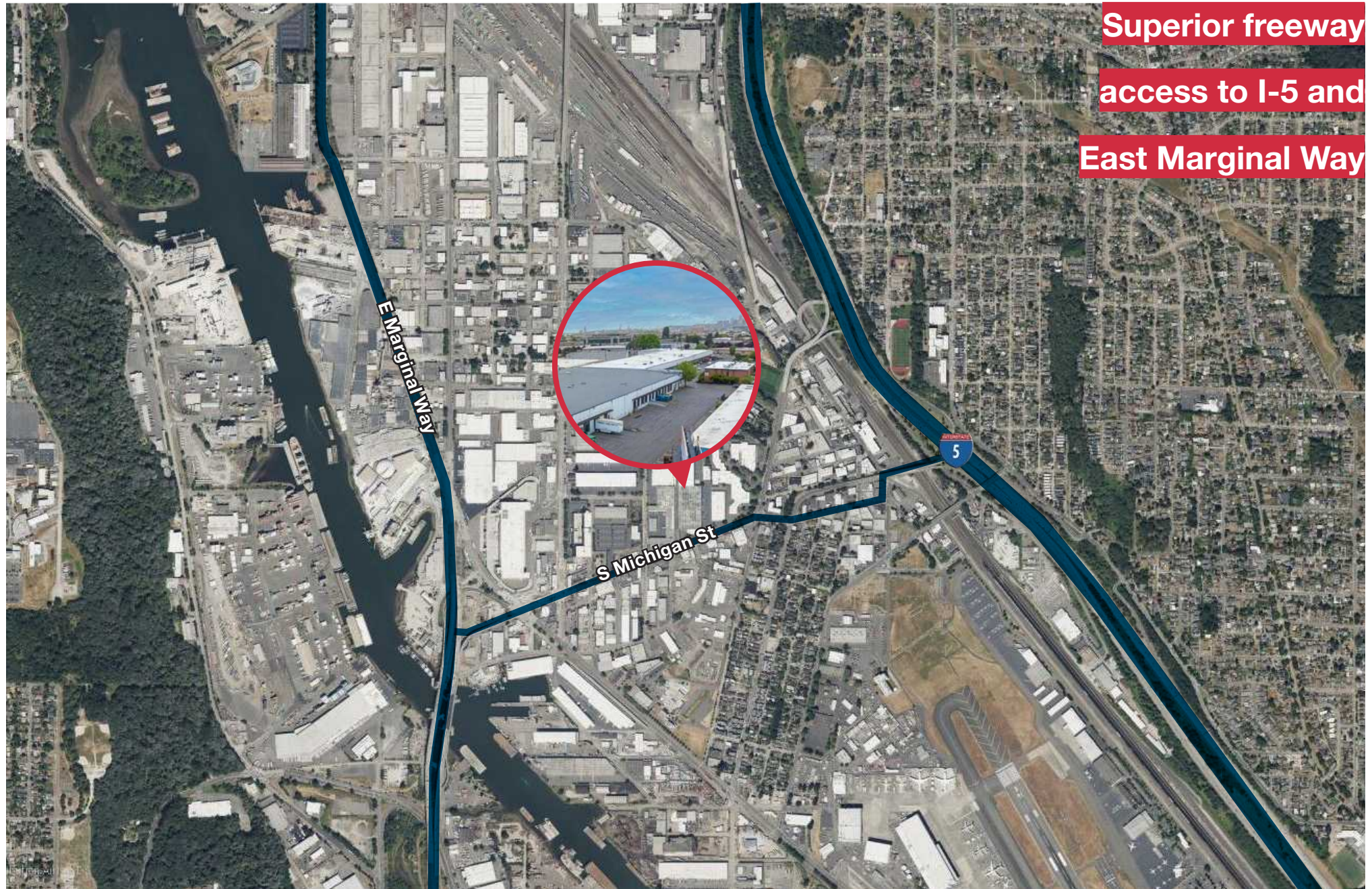

Exclusively marketed by:

John Vernon

+1 425 586 5638

jvernon@nai-psp.com

Tamir Ohayon

+1 425 586 5627

tohayon@nai-psp.com

Bob Swain, CCIM

+1 425 586 5622

bswain@nai-psp.com

