

FOR LEASE

STATESIDE & FOREIGN NATIONAL BAR

DO NOT DISTURB TENANT

*3,312 SF turnkey restaurant
& bar in Seattle's vibrant
Capitol Hill neighborhood*

300 E PIKE ST, SEATTLE, WA



KIDDER.COM

km Kidder
Mathews

STATESIDE & FOREIGN NATIONAL BAR



An exceptional offering situated on a high-visibility corner in Capitol Hill, adjacent to McMenamins Six Arms, Starbucks Reserve Roastery, and Melrose Market.



3,312
TOTAL SF



CAPITOL HILL
SEATTLE, WA



RESTAURANT
AND BAR



HEAVY
PEDESTRIAN
TRAFFIC ZONE



RIDER'S
PARADISE
100/100



SHARED
ENTRY, TRASH
AND STORAGE

STATESIDE RESTAURANT

2,400 SF full-service restaurant & bar

16-foot Type 1 hood

Outdoor sidewalk patio

Shared entry, storage, & trash area

FOREIGN NATIONAL BAR

912 SF speakeasy style high-end cocktail bar

Shared entry, storage, & trash area

STATESIDE & FOREIGN NATIONAL BAR



FLOOR PLAN

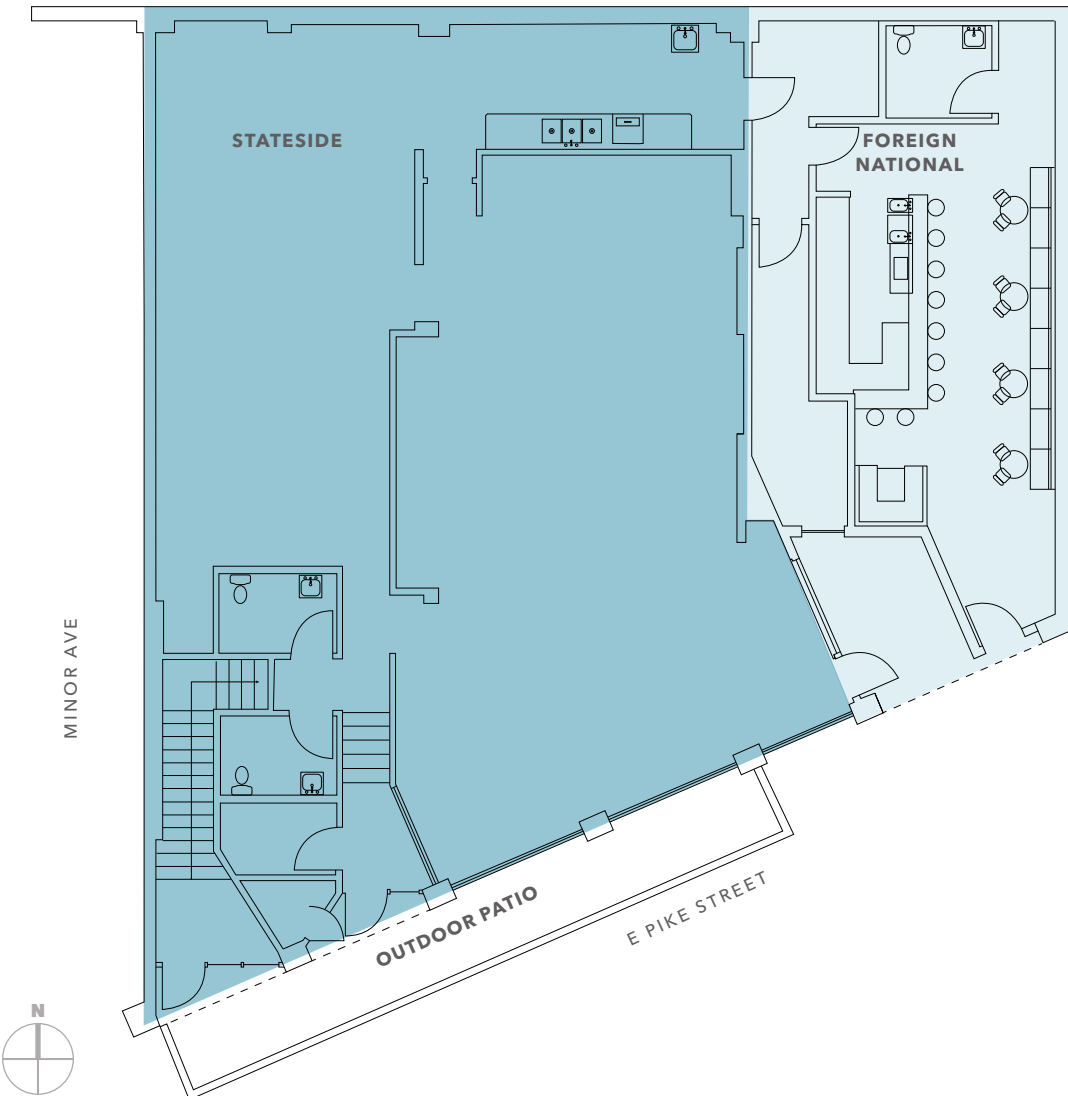

AVAILABLE FOR LEASE

2,400 SF
STATESIDE

912 SF
FOREIGN NATIONAL

3,312 SF
TOTAL AVAILABLE

\$6.33/SF
APPROX. NNN

DO NOT DISTURB TENANT

 TAKE VIRTUAL TOUR

STATESIDE & FOREIGN NATIONAL BAR



DEMOGRAPHICS

POPULATION

	1 Mile	3 Miles	5 Miles
2024 ESTIMATED	108,282	267,652	523,285
2029 PROJECTED	121,425	292,464	560,629

HOUSEHOLDS

	1 Mile	3 Miles	5 Miles
2024 ESTIMATED	69,240	149,502	265,235
2029 PROJECTED	76,514	162,079	283,351

HOUSEHOLD INCOME

	1 Mile	3 Miles	5 Miles
2024 AVERAGE	\$161,013	\$187,550	\$193,783
2024 MEDIAN	\$120,419	\$131,597	\$137,393

DAYTIME DEMOGRAPHICS

	1 Mile	3 Miles	5 Miles
2024 TOTAL BUSINESSES	12,547	25,618	42,782
2024 TOTAL EMPLOYEES	159,980	285,185	402,585

Data Source: ©2025, Sites USA

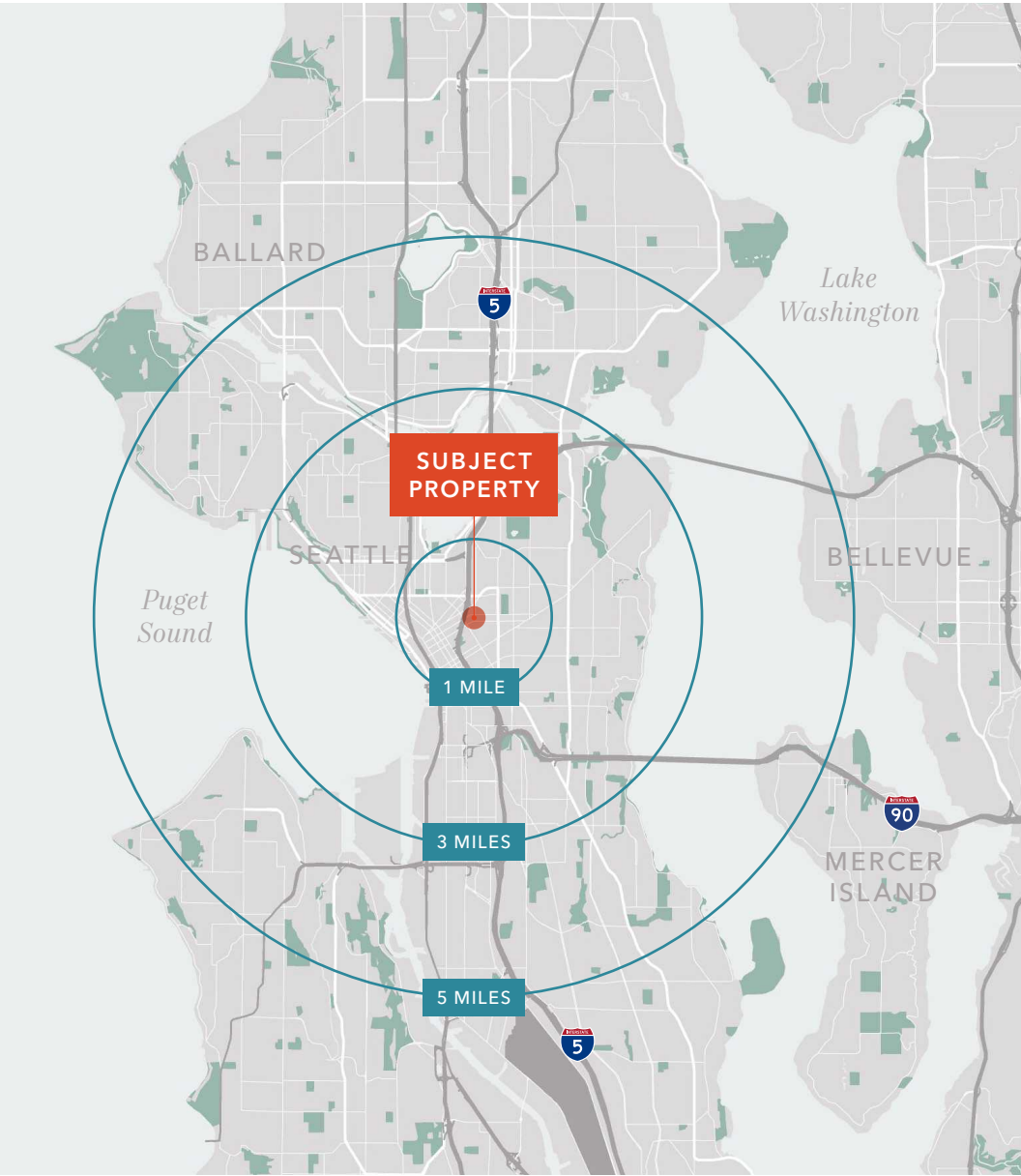

STATESIDE AND FOREIGN NATIONAL BAR

Exclusively leased by

JASON MILLER

First Vice President
206.296.9649

jason.miller@kidder.com

MATT WEISGERBER

Senior Associate
425.450.1122

matt.weisgerber@kidder.com

KIDDER.COM

This information supplied herein is from sources we deem reliable. It is provided without any representation, warranty, or guarantee, expressed or implied as to its accuracy. Prospective Buyer or Tenant should conduct an independent investigation and verification of all matters deemed to be material, including, but not limited to, statements of income and expenses. Consult your attorney, accountant, or other professional advisor. All Kidder Mathews designs are the sole property of Kidder Mathews. Branded materials and layouts are not authorized for use by any other firm or person.

