



FOR LEASE

RETAIL / SHOWROOM / WAREHOUSE

4630 E. Sprague Ave., Spokane Valley, WA 99212

LOCATION:

Situated at the south west corner of Sprague Avenue and Custer Road between Havana and Fancher, minutes to I-90. Current location of Advanced Auto Parts.

SITE:

A portion of a ±39,600 SF site; parcel #35232.0501

ZONING:

City of Spokane Valley, CMU, Corridor Mixed Use; allows for light manufacturing, assembly, retail, wholesale, warehousing, and sales and service.

IMPROVEMENTS:

Leasable Area:	±15,000 SF
Heat/Cooling:	Roof mounted heat and A/C
Grade Level Loading:	One (1) ~ 12'W x 14'H
Power:	3 phase power
Sewer:	Spokane County
Water:	Carnhope Irrigation District #7
Construction Type:	Concrete Tilt
Age:	1991; remodeled 2006
Parking:	Common Use Parking with Emser Tile and Cabinets Plus
Availability:	April 1, 2025

LEASE PRICE:

\$15,000.00/Month/NNN

NNN EXPENSES:

Estimated at \$3,000.00 per month for 2025 (20¢/SF/Mo)

**View
Location**



MARK LUCAS, SIO

509.755.7524

mlucas@kiemleahagood.com

TRACY LUCAS

509.755.7558

tracyl@kiemleahagood.com

**KIEMLE
HAGOOD**

509.838.6541

601 W. Main Avenue, Suite 400
Spokane, WA 99201

All information herein is furnished by the owner and believed to be complete and correct. The Agent, however, cannot be responsible for changes, errors, omissions or withdrawals of this offering without notice. The above information is from sources deemed reliable but should be verified by parties that could be adversely affected by any statements or information. This is not an offering of sub-agency, with commission splits to be determined. 03/13/25/tp J:\BROKERS\LUCAS DOCS\FLYERS\Sprague E. 4630.PUB

4630 E. Sprague Avenue, Spokane Valley, WA 99212



Mark Lucas, SIOR | 509.755.7524 or mlucas@kiemlehagood.com

KIEMLEHAGOOD.COM

Tracy Lucas | 509.755.7525 or tracyl@kiemlehagood.com

Kiemle Hagood respects the intellectual property of others: If you believe the copyright in your work has been violated through this Website, please contact our office for notice of claims of copyright infringement. For your complaint to be valid under the Digital Millennium Copyright Act of 1998 (DMCA), you must provide the following information when providing notice of the claimed copyright infringement: Identify the material on the Website that you believe infringes your work, with enough detail so that we may locate it on the Website; provide your address, telephone number and email address; provide a statement that you have a good faith belief that the disputed use is not authorized by the copyright owner, its agent, or the law; provide a statement that the information in the notification is accurate, and under penalty of perjury, that the complaining party is authorized to act on behalf of owner of an exclusive right that is allegedly infringed; provide your physical or electronic signature. Upon receiving your complaint, Kiemle Hagood will, upon review, remove content that you believe infringes your copyright if the complaint is found valid.

FLOOR PLAN

4630 E. Sprague Ave.,
Spokane Valley, WA 99212

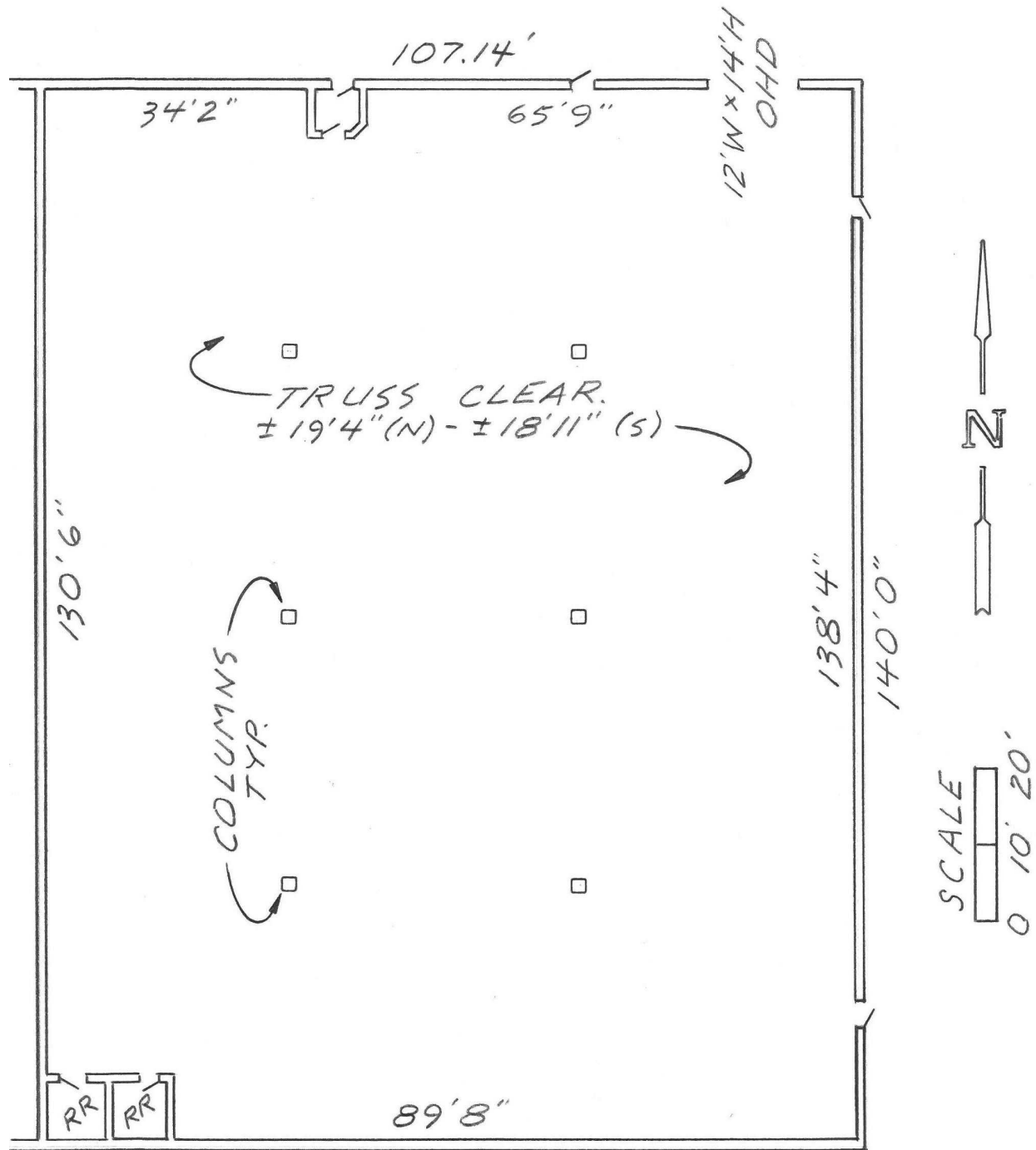

THIS DRAWING IS FOR CONVENIENCE ONLY. ALL CRITICAL MEASUREMENTS SHOULD BE VERIFIED BY PURCHASER OR LESSEE. ALL RIGHTS RESERVED. NO PART OF THIS DOCUMENT MAY BE REPRODUCED IN ANY FORM OR BY ANY MEANS WITHOUT WRITTEN PERMISSION FROM MARK & TRACY LUCAS.

Mark Lucas, SIOR | 509.755.7524 or mlucas@kiemlehagood.com

Tracy Lucas | 509.755.7558 or tracyl@kiemlehagood.com

KIEMLEHAGOOD.COM

