

FOR LEASE

Owned and Operated by  LINK

Portside Distribution Center

1401 St. Paul Avenue Tacoma, WA

± 93,941 - 416,050 SF



LEASING INFO
& CONTACT

Wilma Warshak, SIOR

Alana Garrett

Jackson Peterson

206-409-1432 / wilma.warshak@wa-rea.com

858-722-5627 / alana.garrett@wa-rea.com

206-838 5492 / jackson/peterson@wa-rea.com

WA REA
Washington Real Estate Advisors

This is not an offer or acceptance of an offer to lease space. A lease will only be offered or made in a written agreement signed by landlord. No representation or warranty of any kind is made by landlord unless set forth in a written definitive lease executed by the landlord.

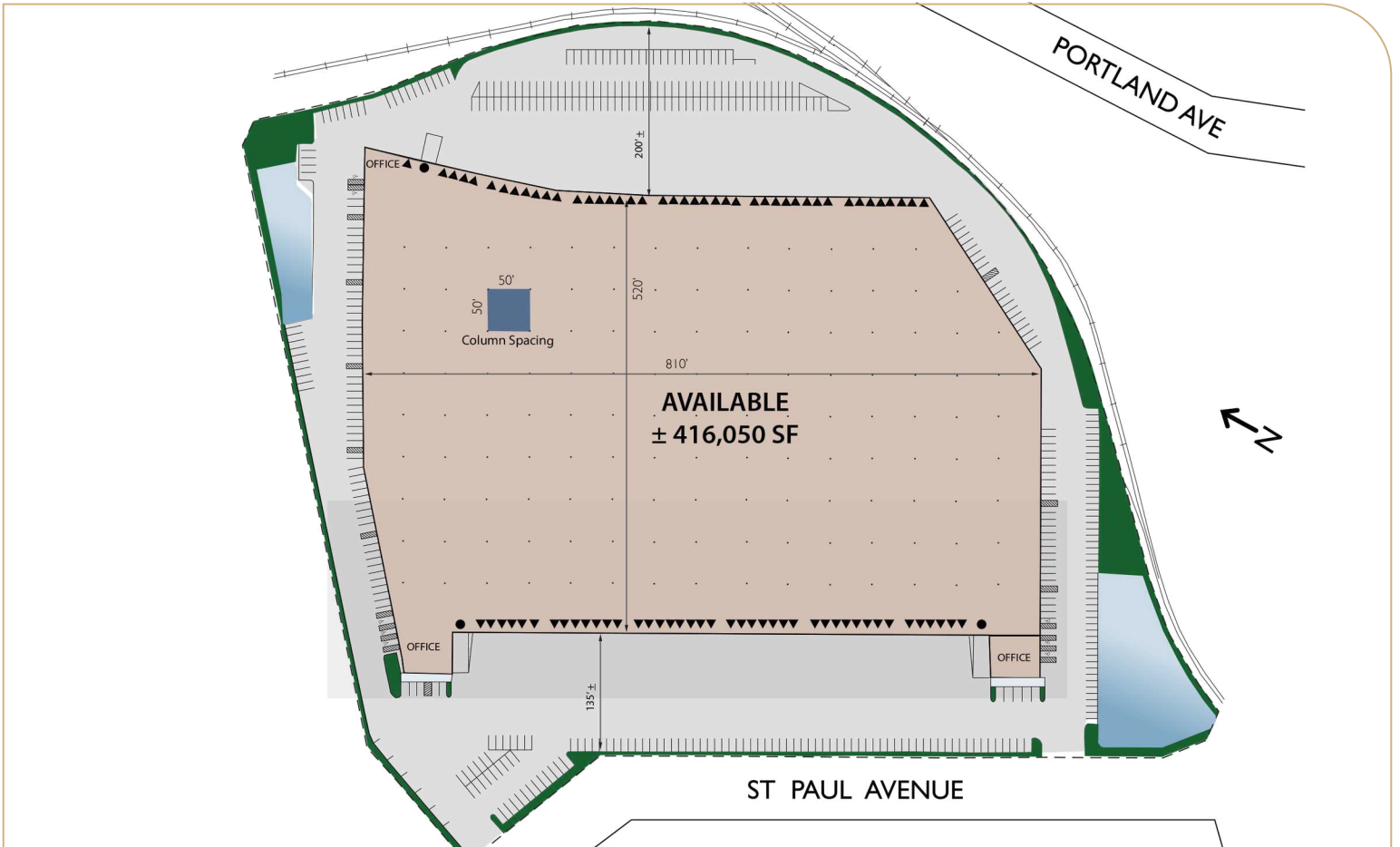

Building Details

Available Space :	± 93,941 - 416,050 SF
Office Area:	± 8,786 SF in 3 nodes
Ceiling Height:	± 30' w/ ESRF
Power:	±2,400 amps, 277/480volt
Loading Doors:	86 dock-high 3 drive-in

Fully secured with trailer parking available

Potential opportunity for rail service provided by BNSF

Zoning allows for heavy industrial uses

Excellent Port of Tacoma location, with immediate freeway access to I-5, & SR-509.

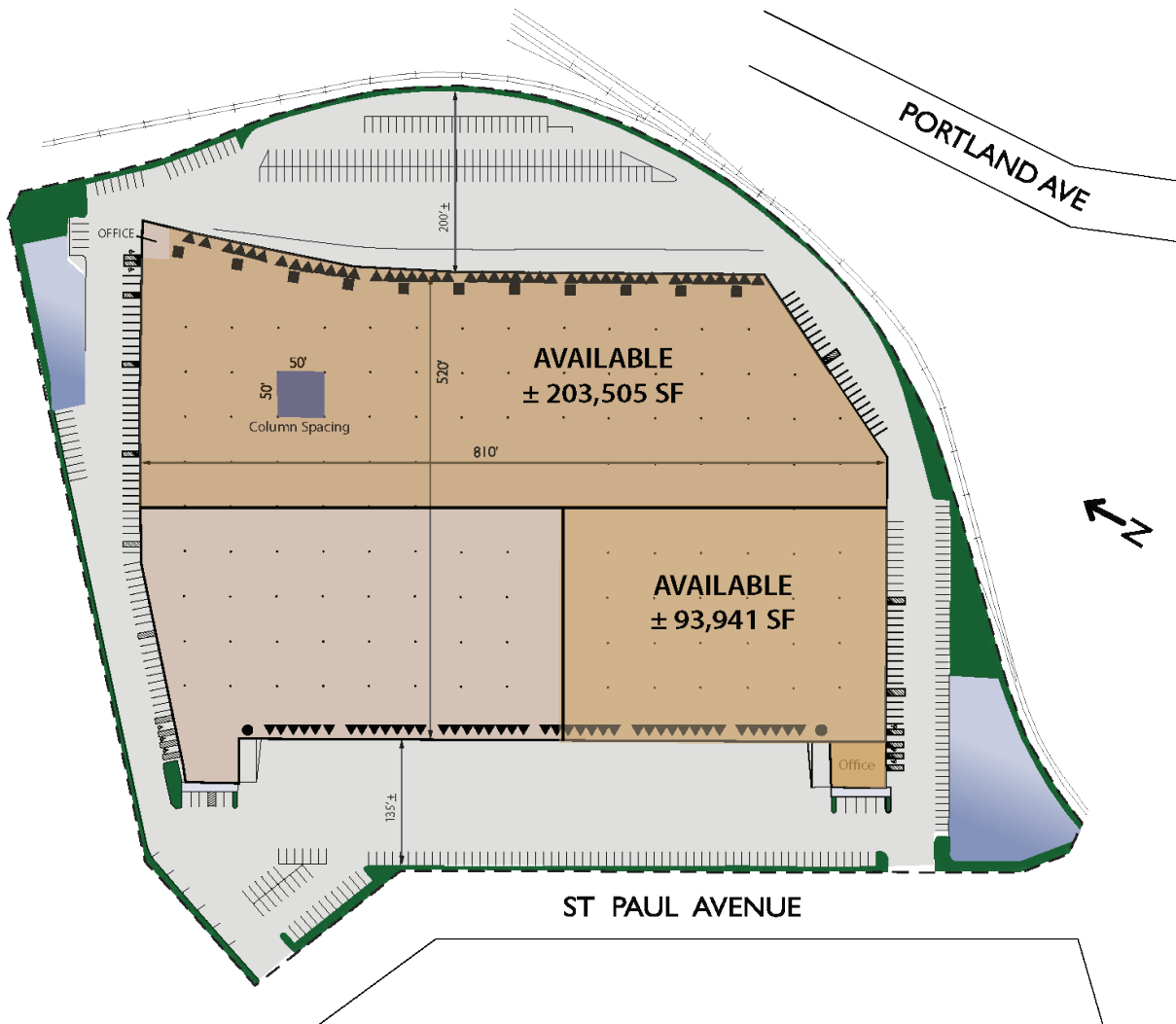

Demising Options

Available Space: ± 203,505 SF

Office Area: ± 2,940 SF

Loading Doors: 44 dock-high
1 drive-in

Available Space: ± 93,941 SF

Office Area: ± 3,946

Loading Doors: 19 dock-high
1 drive-in