

MODERN OFFICE SPACE IN FAIRHAVEN

1108 11th St, #306, Bellingham WA 98225



- 253 RSF AVAILABLE
- AC IN SPACE
- ELEVATOR ACCESSIBLE
- QUIET OFFICE SPACE
- FAIRHAVEN HISTORIC DISTRICT
- SHARED WAITING AREA

FOR LEASE
\$575/ Mo. + NNN



FOR MORE
INFORMATION

PLEASE CONTACT:

TRACY CARPENTER
GAGE COMMERCIAL REAL ESTATE, LLC.
BROKER/OWNER
360.303.2608
TRACY@GAGECRE.COM

PROPERTY SUMMARY

HAUTER-SIMS BUILDING

Featuring a fantastic location in Fairhaven, the Hauter-Sims building utilizes modern amenities combined with rustic charm to create the perfect location to house your business. Admire the beautiful brick façade as you step inside to elevator access. Modern, clean finished throughout, and windows that open to let in the fresh bay breeze. Shared restrooms and reception area. Easy access to Fairhaven Historic District, Taylor Docks, and a short drive to Downtown Bellingham or I-5. This suite faces 11th street allowing for an abundance of natural light.

PROPERTY HIGHLIGHTS

Premier Location – Located in the heart of Fairhaven Historic District, the Hauter-Sims building offers an easily accessible location for visitation by car or foot.

Parking – Parking via Fairhaven Parking District. Metered parking.

Finishes – Beautiful brick façade opening up into bright & modern individual offices. Rear access to Fairhaven waterfront & walking trails.

Elevator – Access from sidewalk brings you to the second floor, and elevator access is provided to access all three floors of the building. Stair access is provided from 11th st as well.

Accessibility – Access WSDOT Transit from 150 feet away, plus walk seconds into Fairhaven. Short bike ride to Downtown Bellingham.

Signage – The tenant has access to signage on the building made up of hanging fascia signage.

Visibility – Building fronts on 11th St. Highly visible. The Building is centrally located in the Bellingham submarket of Fairhaven on a busy thoroughfare and offers traffic to Downtown Bellingham & Western Washington University alike.

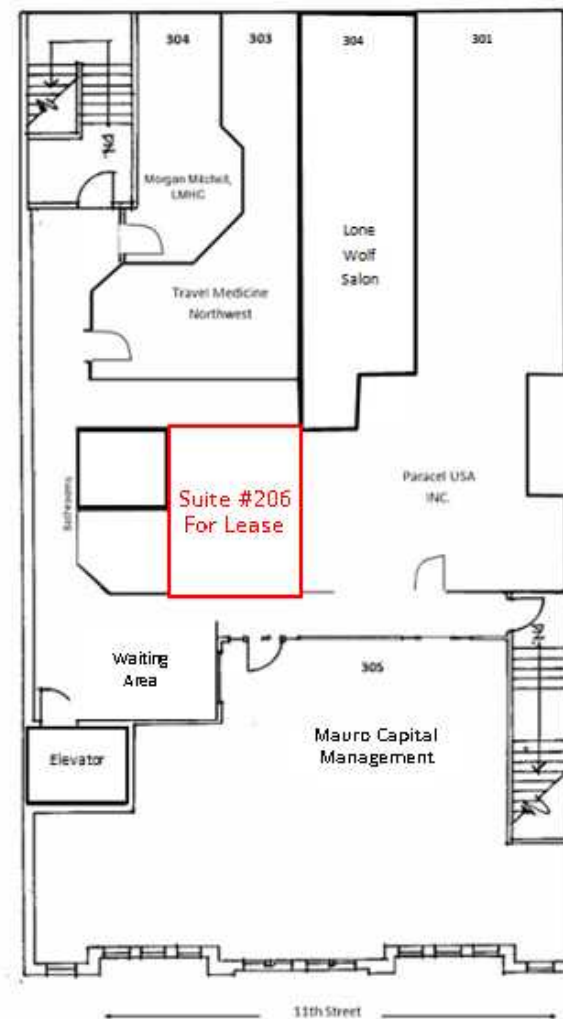

PROPERTY OVERVIEW

Address: 1108 11th St,
Bellingham, WA 98225

APN: 3702011031620000

Total Building SF: 13,000

Available SF: 253

Year Built: 2004

No. of Floors: 3 (Elevator
Access)

Market: Bellingham

HVAC: Roof Mounted Forced
Air