

# 8607 DURANGO ST SW

*±27,500 SF Industrial Space Available for  
Lease Starting October 1, 2025*

LAKESIDE, WA

TY CLARKE  
Executive Vice President  
253.722.1419  
ty.clarke@kidder.com

HUNTER CLARKE  
First Vice President  
253.722.1454  
hunter.clarke@kidder.com



SITE PLAN

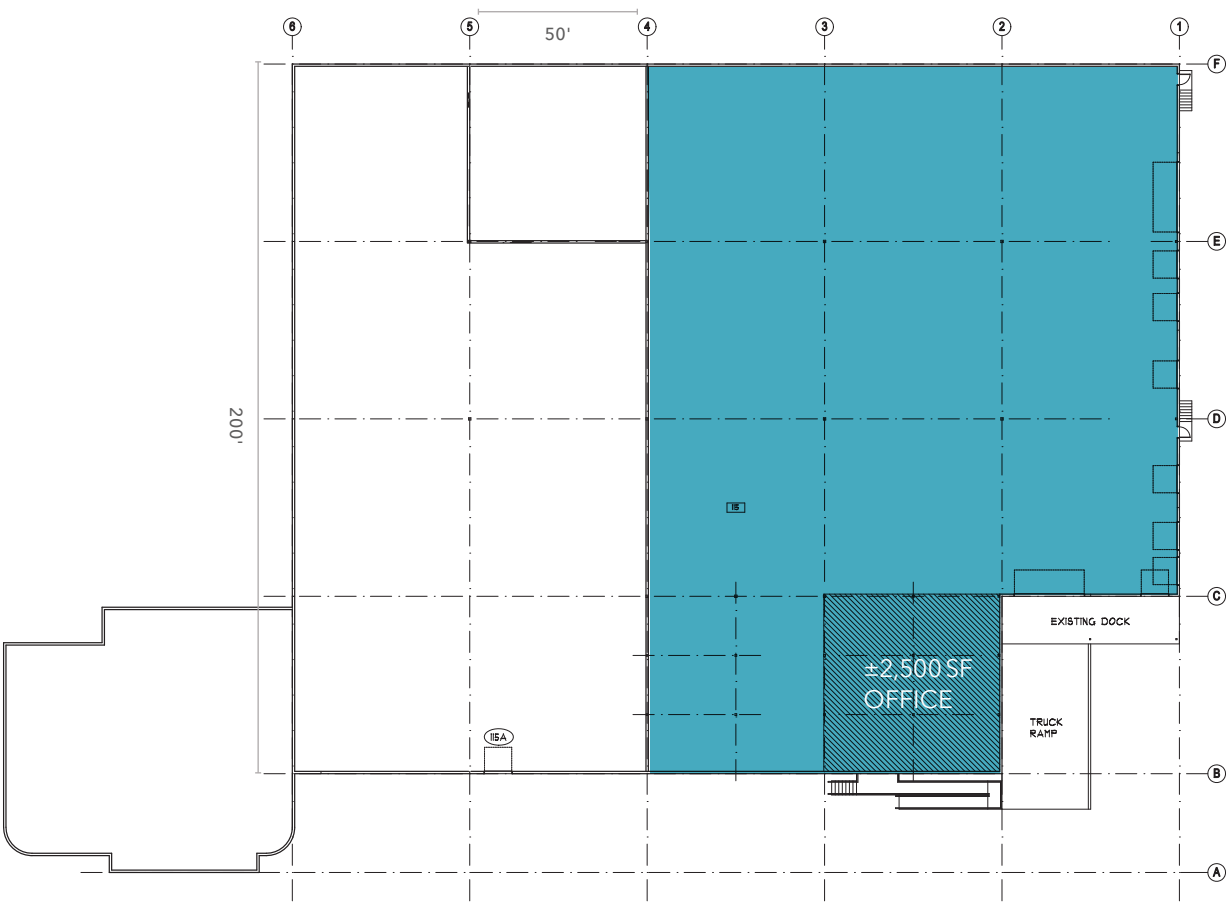

ADDRESS	8607 Durango St SW Lakewood, WA
AVAILABLE	October 1, 2025
BUILDING SIZE	±27,500 SF
OFFICE SIZE	±2,500 SF
CONSTRUCTION	Concrete tilt; reinforced slab
POWER	Heavy three-phase power
CLEAR HEIGHT	24'
PARKING	Trailer parking available
DH LOADING	10
GL LOADING	1
ACCESS	Immediate access to I-5
SECURITY	Secured yard area

27.5K SF  
AVAILABLE

CALL  
FOR LEASE RATE

10  
DOCK-HIGH DOORS

1  
GRADE-LOADING DOOR





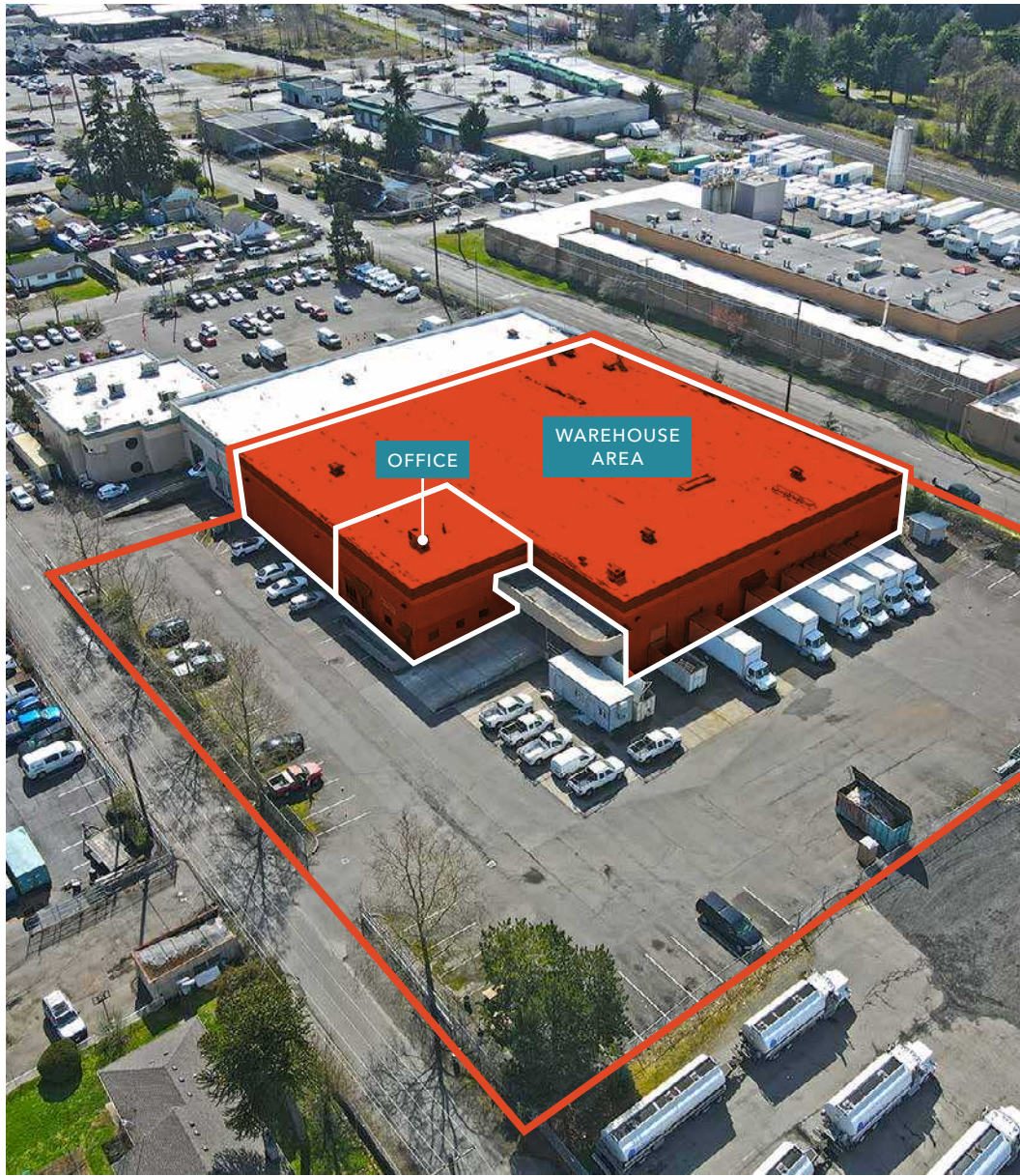



## LOCATION HIGHLIGHTS

I-5	2 miles
PORT OF TACOMA	9 miles
PORT OF SEATTLE	39 miles
SEATTLE	38 miles

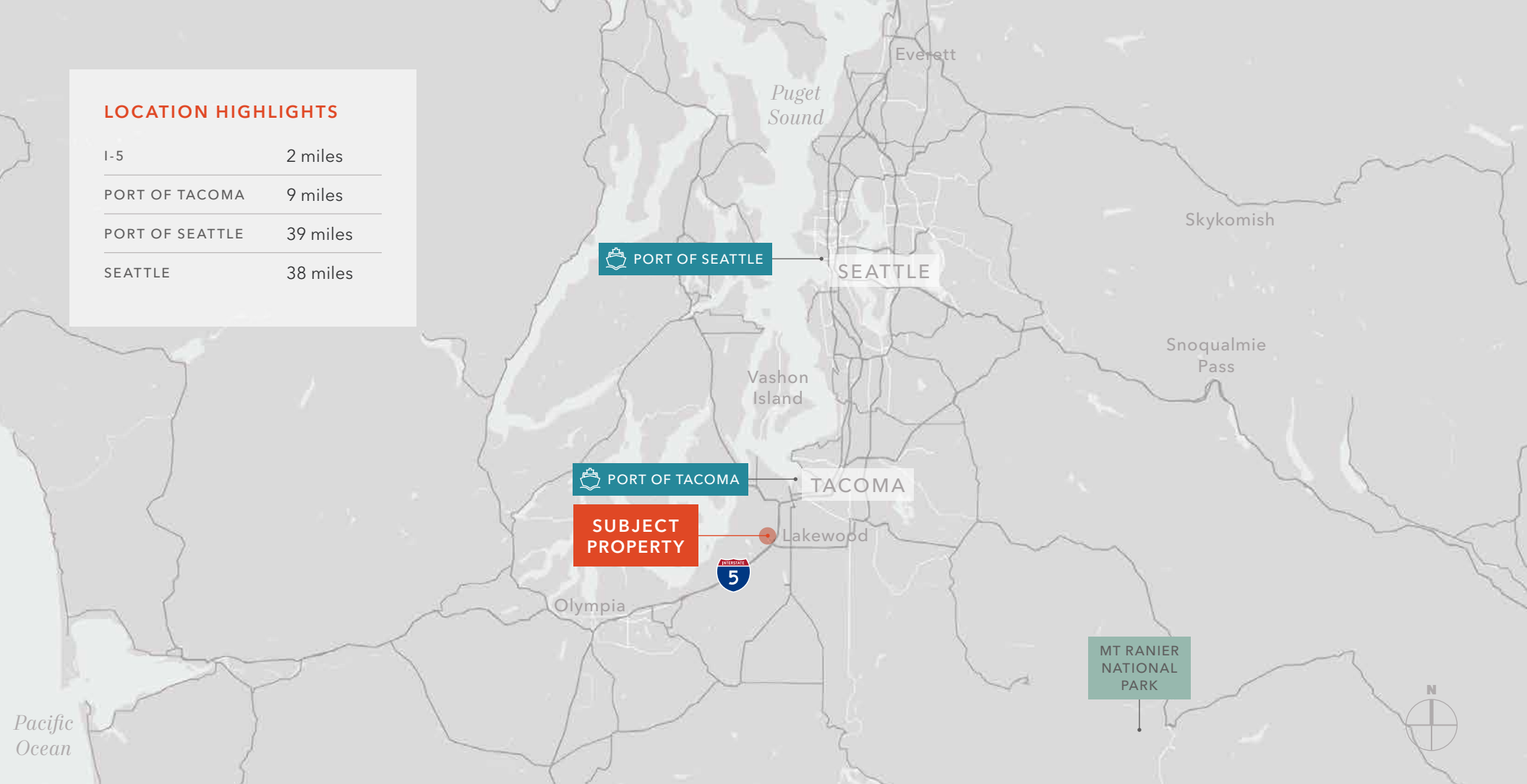

# 8607 DURANGO ST SW

*For more information on  
this property, please contact*

**TY CLARKE**  
Executive Vice President  
253.722.1419  
ty.clarke@kidder.com

**HUNTER CLARKE**  
First Vice President  
253.722.1454  
hunter.clarke@kidder.com

**KIDDER.COM**

This information supplied herein is from sources we deem reliable. It is provided without any representation, warranty, or guarantee, expressed or implied as to its accuracy. Prospective Buyer or Tenant should conduct an independent investigation and verification of all matters deemed to be material, including, but not limited to, statements of income and expenses. Consult your attorney, accountant, or other professional advisor. All Kidder Mathews designs are the sole property of Kidder Mathews. Branded materials and layouts are not authorized for use by any other firm or person.

