



FOR LEASE

SOUTHCENTER
PLAZA

14900 Interurban Ave S
Tukwila, WA

SUITES AVAILABLE

Suite 100	1,647 RSF	June 1, 2025
Suite 145	1,795 RSF	April 1, 2025
Suite 175	1,119 RSF	June 1, 2025

HIGHLIGHTS

- Beautiful landscaping offers a park-like setting
- Serene Views of Green River and Fort Dent Park
- Ideal for bike commuters/riders, near the Green River Trail and Lake to Sound Trail
- Ample free parking surrounding the building provides convenient access via the 3 main building entries
- Convenient Metro bus access on main arterial linking Seattle to the South King County (Route 150)
- Tenants can utilize a City of Seattle address
- **Rental Rate:** \$26.50 per RSF per Year, Fully Serviced



CURRENT AVAILABLE SUITES ON 1ST FLOOR

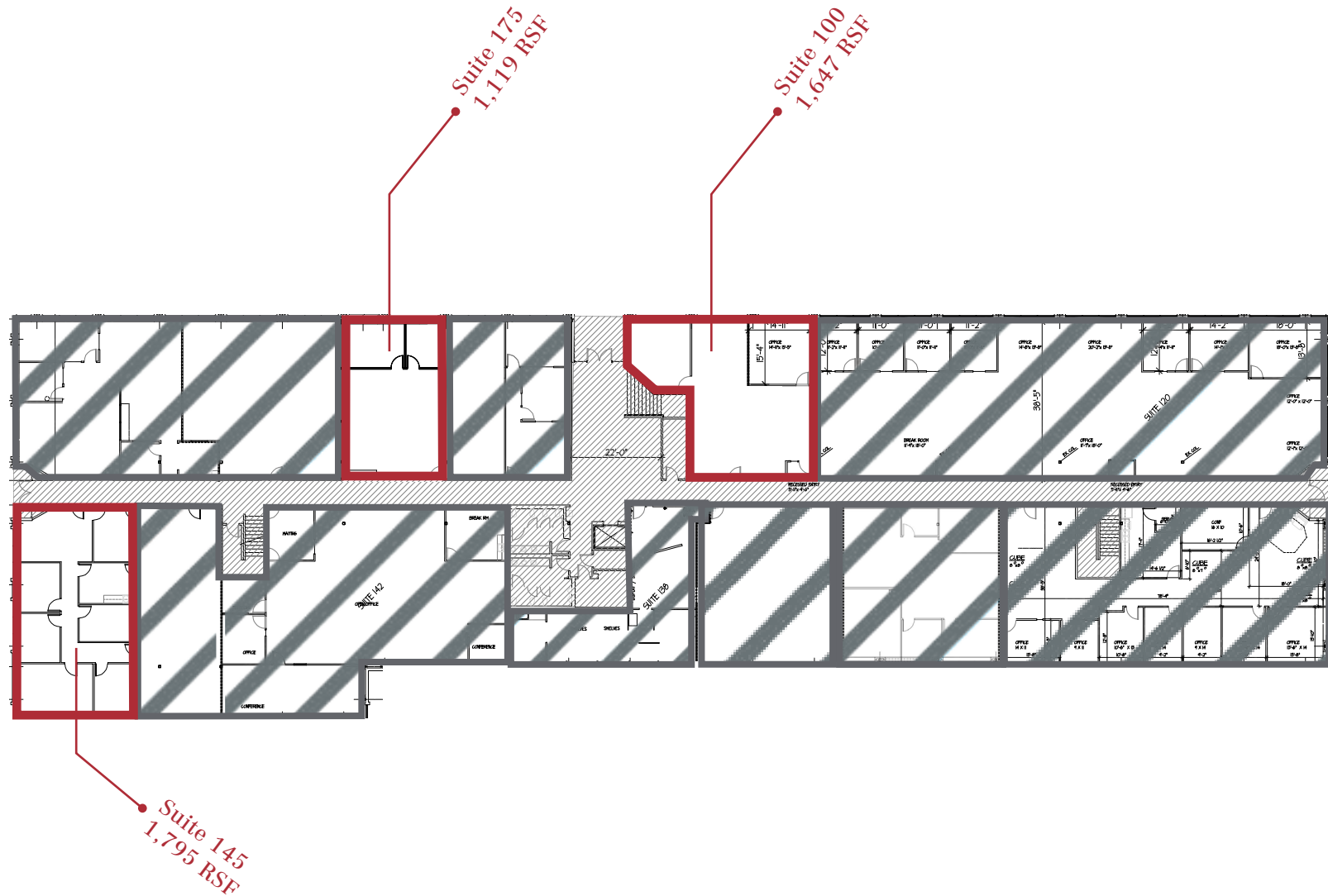

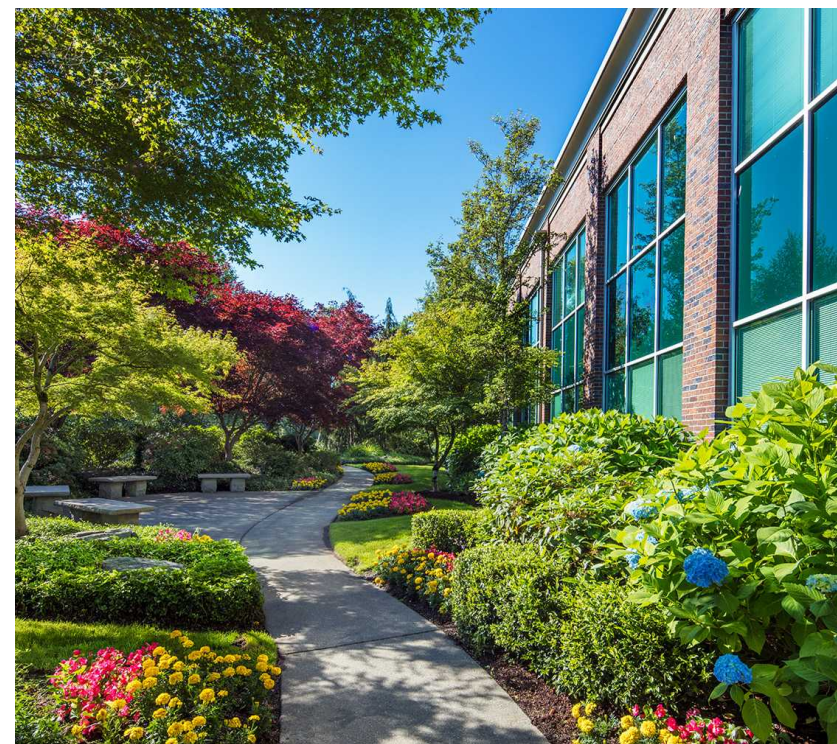

THE INFORMATION CONTAINED HEREIN HAS BEEN GIVEN TO US BY THE OWNER OF THE PROPERTY OR OTHER SOURCES WE DEEM RELIABLE, WE HAVE NO REASON TO DOUBT ITS ACCURACY, BUT WE DO NOT GUARANTEE IT. ALL INFORMATION SHOULD BE VERIFIED PRIOR TO PURCHASE OR LEASE.

SOUTHCENTER PLAZA – 14900 INTERURBAN AVE S, TUKWILA, WA



Location Highlights

- Centrally located between Seattle, Bellevue and Tacoma and only minutes to SeaTac International Airport
- Easy Freeway access to I-5, I-405 and West Valley Highway