

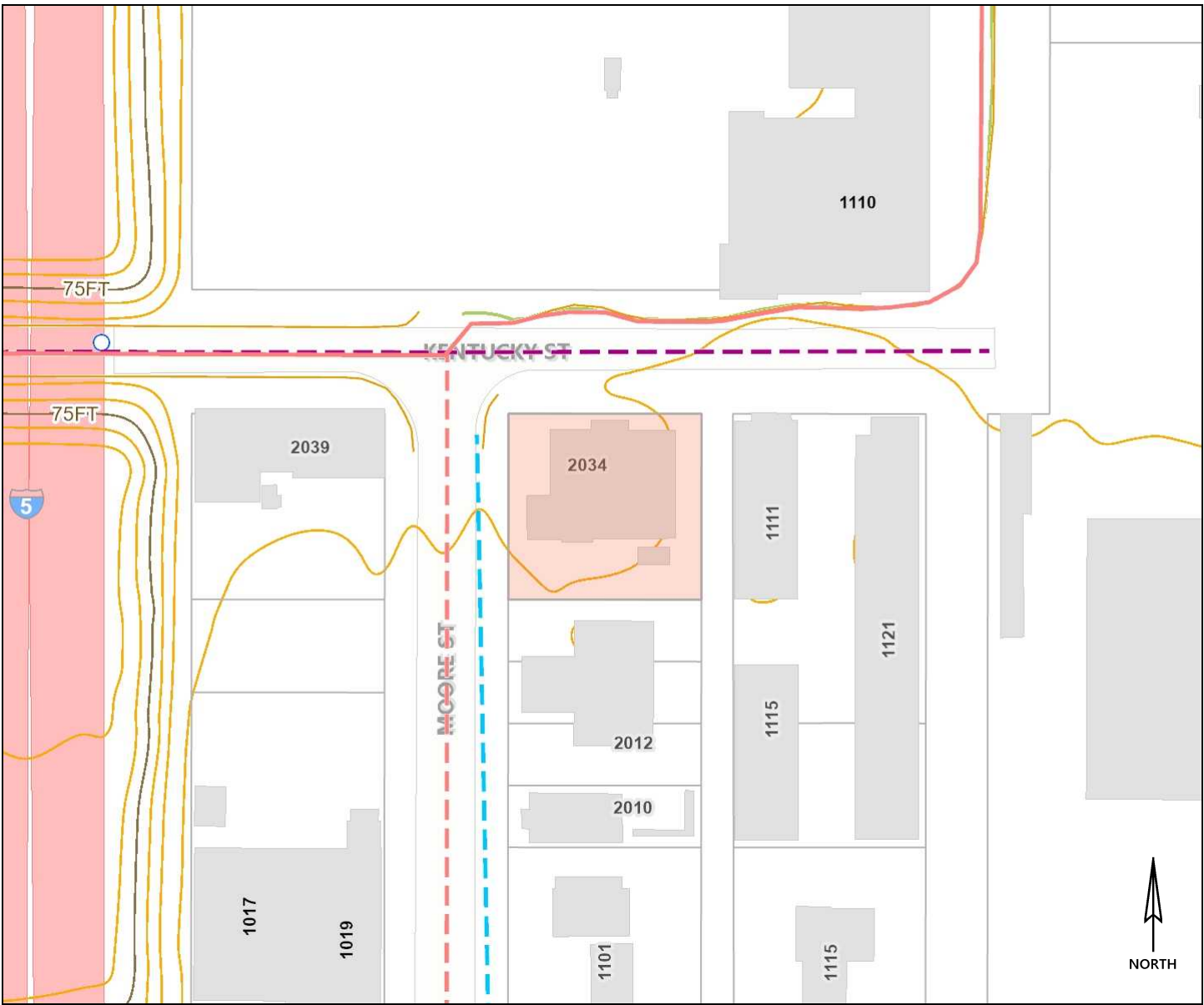

# Land Parcel Report for 380329104446

for site address of 2034 MOORE ST



Assessor Property Info		Appraised Property Value	
Property ID:	73204	Land value:	\$552,006
Assessor address:	2034 MOORE ST	Improvement value:	\$383,674
Owner name:	S & P MILLS LLC	Total value:	\$935,680
Land use:	AUTO REP SER		

## Legal Description

Contact the Whatcom County Assessors office (360-778-5050) for the complete legal description.

FIRST ADD TO NEW WHATCOM LOTS 1-2-3 BLK 266-SUBJ TO COVENANT TO BIND PROPERTIES AF 1971202365

## Full Parcel Number(s)

[3803291044460000](#)

## Site Address(es)

2034 MOORE ST

## Parcel Area

Mapped parcel area (sq ft): 15007  
Mapped parcel area (acres): 0.34  
Assessor legal acreage: 0.34

## Neighborhood

[ROOSEVELT](#)

## Zoning

INDUSTRIAL Subarea: 12

[Neighborhood Plans and Zoning](#)

## Historical Information

(Not available)

## Zoning (Urban Village)

(Not available)

## Watershed

Whatcom Creek, Sub Basin: Fever Creek

## Bellingham Schools

Elementary: [SUNNYLAND](#)

Middle: [WHATCOM](#)

High: [BELLINGHAM](#)

## Subdivisions

Status	Name	Documents
CURRENT	NEW WHATCOM, FIRST ADDITION	<a href="#">More info</a>

## Ward and Precinct

<b>Ward number:</b>	3	<a href="#">Ward info (link)</a>
<b>Precinct number:</b>	227	<a href="#">Senate info (link)</a>
<b>Legislative district number:</b>	42	<a href="#">Legislator info (link)</a>
<b>County Council district number:</b>	1	<a href="#">County Council info (link)</a>
		<a href="#">Congress info (link)</a>

## Parks within one-half mile

(Not available)

## Trails within one-half mile

Roosevelt Neighborhood Connectors  
Whatcom Creek Trail

## Bus stops within one-half mile

Direction/Location	Shelter	Bench
James St at Carolina St	No	Yes
James St at Carolina St	No	No
James St at Kentucky St	No	No
James St at Kentucky St	No	No
State St at Iron St	No	No

DISCLAIMER: The City of Bellingham has compiled this information for its own use and is not responsible for any use of this information by others. The information found herein is provided simply as a courtesy to the public and is not intended for any third party use in any official, professional or other authoritative capacity. Persons using this information do so at their own risk and by such use agree to defend, indemnify and hold harmless the City of Bellingham as to any claims, damages, liability, losses or suits arising out of such use.

[Visit the City of Bellingham's Policies and Disclaimers web page for additional information at https://cob.org/about/policies.](https://cob.org/about/policies)

[Contact Whatcom County Assessors office for most recent parcel information. Phone: \(360-778-5050\) Web: http://www.co.whatcom.wa.us/assessor/](http://www.co.whatcom.wa.us/assessor/)