

# ST. GEORGE'S SQUARE

355 NW GILMAN BLVD  
ISSAQUAH, WA 98027

PACIFIC ASSET ADVISORS, INC.



## LISTING DETAILS



RENTABLE SF

558 SF

**CALL  
FOR  
RATE  
\$12/SF NNN**

ADDRESS:

355 NW Gilman Blvd  
Issaquah, WA 98027

SPACE AVAILABLE: *Building 2, 2nd Floor Office  
-Suite 202 - 558 SF*

SURROUNDING  
AREA:

Target, Ross Dress for Less,  
Safeway, Hobby Lobby,  
Trader Joe's, Fred Meyer...

	1 MILE	3 MILES	5 MILES
MEDIAN INCOME:	\$142,268	\$175,905	\$198,982
TOTAL POPULATION:	11,060	59,555	117,176
DAYTIME POPULATION:	12,281	32,598	57,498

# SITE PLAN

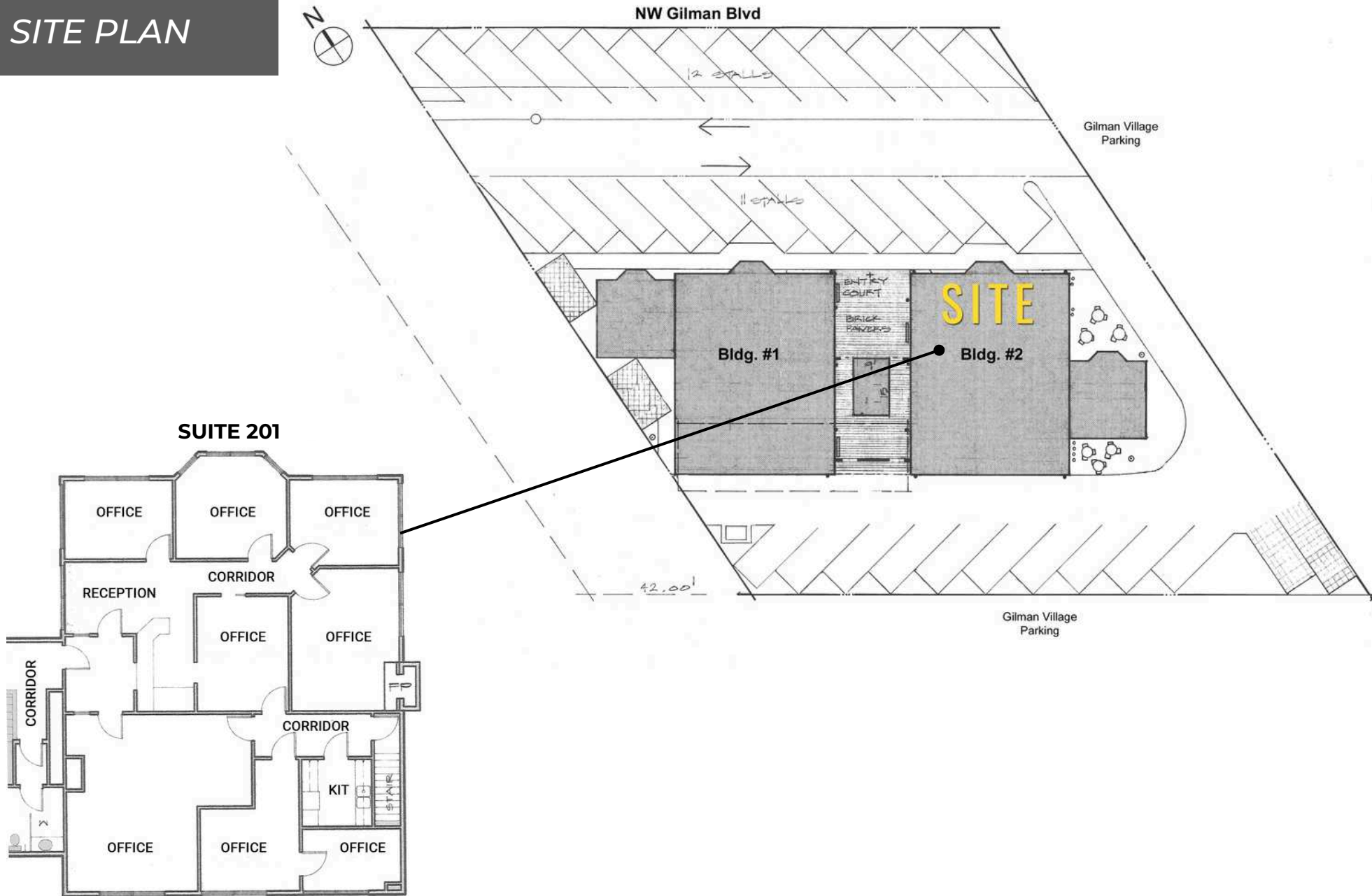



AERIAL

90

64,971 VPD

LOWE'S  
Costco  
PET SMART  
Michaels  
P.C.C.

ISSAQUAH  
SCHOOL DISTRICT HQ

FedEx  
SHIP CENTER

COSTCO  
WHOLESALE  
CORPORATION

Fred Meyer  
BEST BUY  
QDOBA  
Jamba

OPC  
Starbucks

HOBBY LOBBY  
425  
SUBWAY  
TacoTime

ROSS petco  
bress for LESS For Dogs  
TRADER JOE'S

Indy Cafe Rio  
SHERWIN-WILLIAMS

900

Target  
SAFEWAY  
Bath & Body Works  
FIVE GUYS  
SEPHORA  
FedEx

90

SWEDISH ISSAQUAH  
CAMPUS

SAFEWAY  
ULTA  
MUD BAY  
DICK'S  
MOD  
Marshalls  
REGAL  
BevMo!  
Great Clips  
crumbl  
cookies  
ups



## CONTACT



**ADAM GREENBERG**  
SENIOR VICE PRESIDENT  
PARTNER  
425.503.1339  
ADAM@PAADVISORS.COM



**TYSON CLARKE**  
SENIOR VICE PRESIDENT  
PARTNER  
360.319.4855  
TYSON@PAADVISORS.COM

**PACIFIC ASSET ADVISORS, INC.**  
THE PREMIER CHOICE OF THE PACIFIC NORTHWEST

14205 SE 36TH ST, SUITE 215, BELLEVUE, WA 98006